

SO3050CM/S



FEATURES

- Rigorously tested for decades of use
- Exceptional support from our Customer Care team in Madison
- 10 cooking modes for predictably delicious results (Convection, Roast, Bake, Broil, Convection Roast, Stone, Gourmet, Warm, Proof and Dehydrate)
- Gourmet feature has menu of presets that automatically controls cooking of popular meals
- Interactive color touchscreen for advanced cooking control
- Can be installed flush with surrounding cabinetry for integrated look
- Enhanced interior views with triple-pane glass and three halogen lights
- 5.1 cubic feet capacity to handle multiple dishes at once
- Temperature probe cooks to ideal doneness and lets you know when it's ready
- Stainless steel, handleless design for Wolf performance at its sleekest

ACCESSORIES

- 30" Broiler Pan
- 30" Premier Baking Sheet
- Bake Stone Kit
- Bake Stone Kit
- Baking Sheet
- Dehydration Kit
- Dehydration Rack Set
- Dual Installation Kit
- Multi-Function Pan
- Oven Rack
- Oven Rack Set (3)
- Temperature Probe

Accessories available through an authorized dealer.
For local dealer information, visit subzero-wolf.com/locator.





PRODUCT SPECIFICATIONS

Model	SO3050CM/S
Dimensions	29 7/8"W x 28 1/2"H x 23"D
Oven 1 Interior Dimensions	25 1/4"W x 17 1/2"H x 19 7/8"D
Overall Capacity	5.1 cu. ft.
Usable Capacity	3.3 cu. ft.
Door Clearance	21 3/8"
Electrical Supply	240/208 VAC, 60 Hz
Electrical Service	30 amp dedicated circuit
Conduit Length	4 Feet

ELECTRICAL

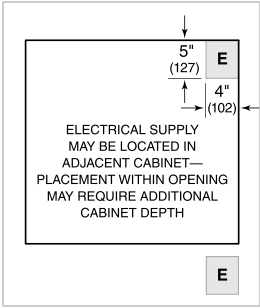

NOTE: Dimensions in parenthesis are in millimeters unless otherwise specified

DIMENSIONS

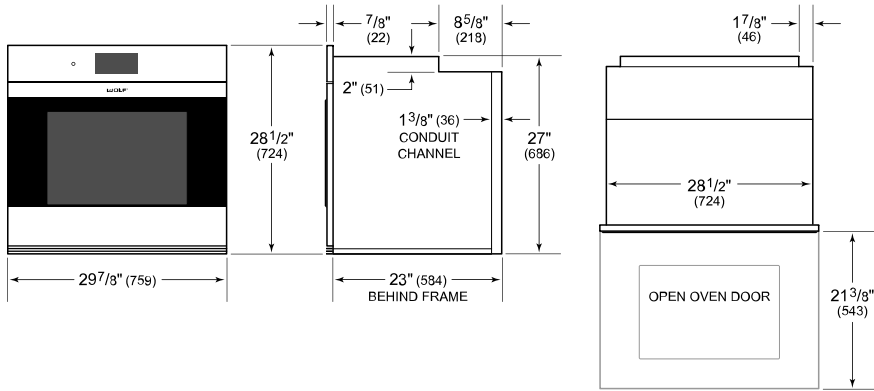

STANDARD INSTALLATION

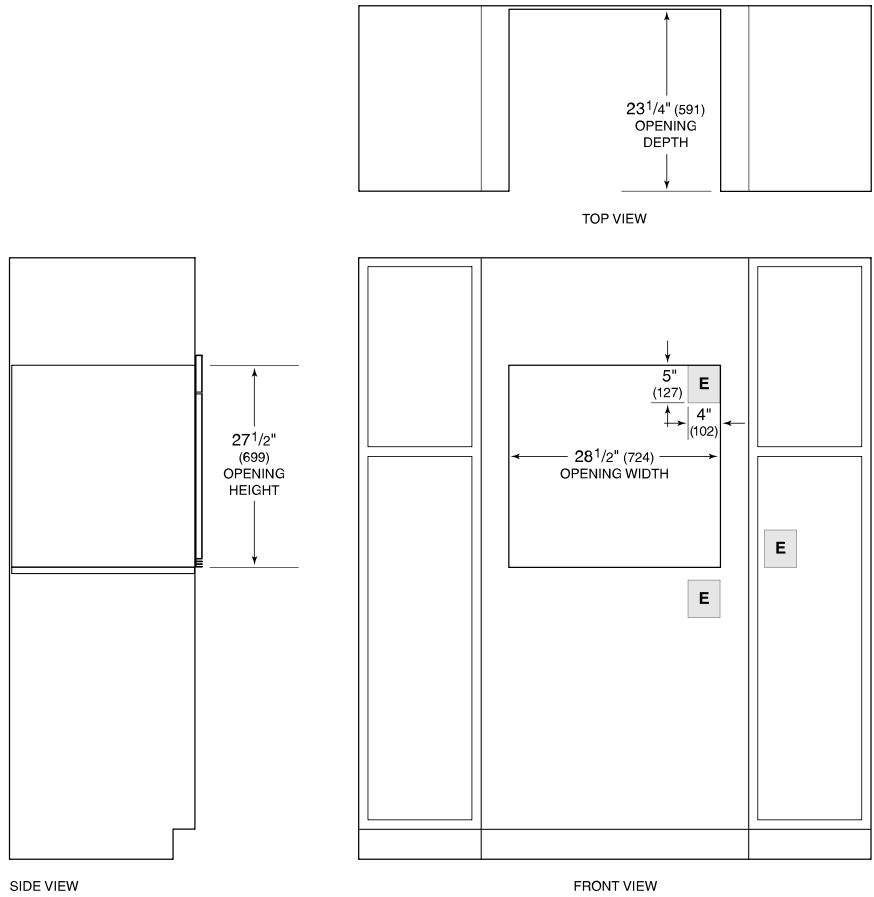

NOTE: Location of electrical supply within opening may require additional cabinet depth.