

CL3050W/O



FEATURES

- Store reds and whites in separate temperature zones that keep wines at proper serving temperatures, within one degree of setpoint
- Offers any-occasion-146-bottle capacity
- Full-extension wine racks provide easy access to standard-size bottles, half bottles, and magnums without agitating others
- Touch control panel is conveniently located for easy access at the tap of a finger
- UV-resistant glass door shields wine from harmful light
- Inventory tile system aids collection organization
- Wi-Fi enabled features enable remote control of independent temperatures zones, provide important door-ajar notifications, and assist with remote service diagnostics—all from your mobile device
- Accepts custom panels for an integrated look within cabinetry or stainless-steel accessory panels and handles to match other Sub-Zero, Wolf, and Cove products
- Sub-Zero offers an industry-leading full two-year warranty on appliances, along with a full five-year sealed system warranty and a limited twelve-year sealed system warranty

ACCESSORIES

- Bulk Storage Drawer
- Custom Front Panel Mounting Kit
- Dual Installation Kit
- Dual Installation Kit with 60" Grille Frame
- Dual Installation Kit with 66" Grille Frame
- Lock Kit
- Pro Handle
- Pro Louvered Flush Inset Grille - 84"
- Stainless Steel Flush Inset Door Panel with Pro Handle
- Stainless Steel Flush Inset Door Panel with Tubular Handle
- Stainless Steel Flush Inset Grille Panel
- Tubular Handle
- Dual Installation Kit with Dual Wide Grille

Accessories are available through an authorized dealer.
For local dealer information, visit subzero-wolf.com/locator.



HANDLE ACCESSORIES

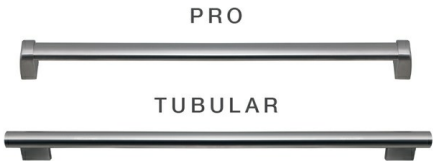

PRODUCT SPECIFICATIONS

Model	CL3050W/O
Dimensions	30"W x 84"H x 24"D
Door Clearance	31 3/4"
Electrical Supply	115 VAC, 60 Hz
Electrical Service	15 amp dedicated circuit
Wine Storage Capacity	146 Bottles
Receptacle	3-prong grounding-type

ELECTRICAL

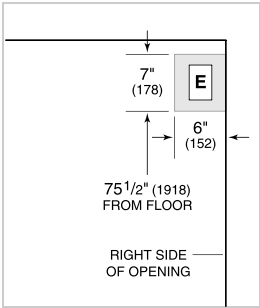

NOTE: Dimensions in parenthesis are in millimeters unless otherwise specified

INTERIOR VIEW

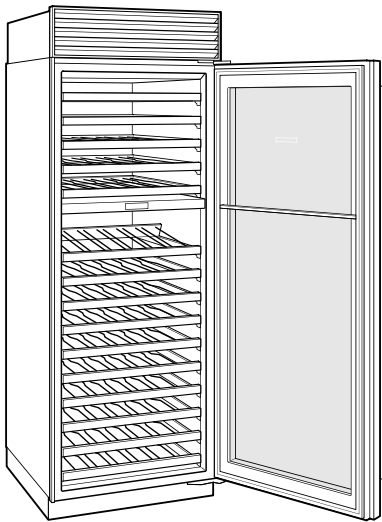

This illustration is intended for interior reference only and may not represent the exterior of the model being specified.

DIMENSIONS

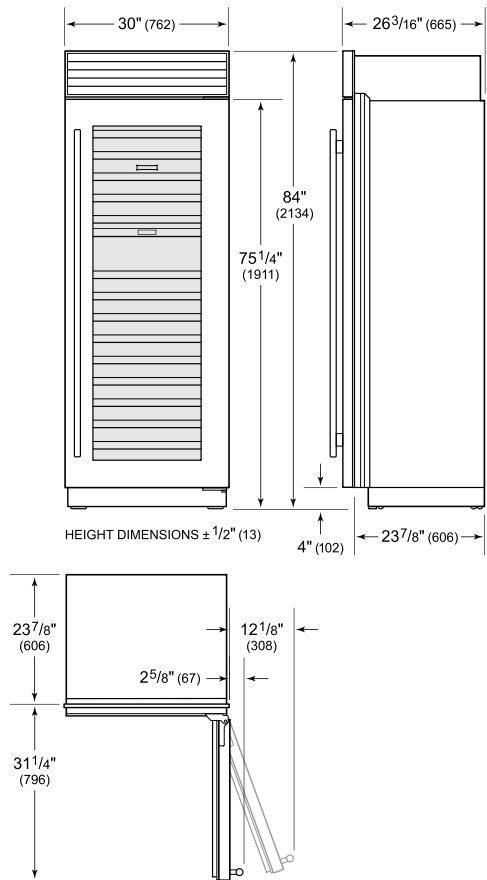

FLUSH INSET INSTALLATION

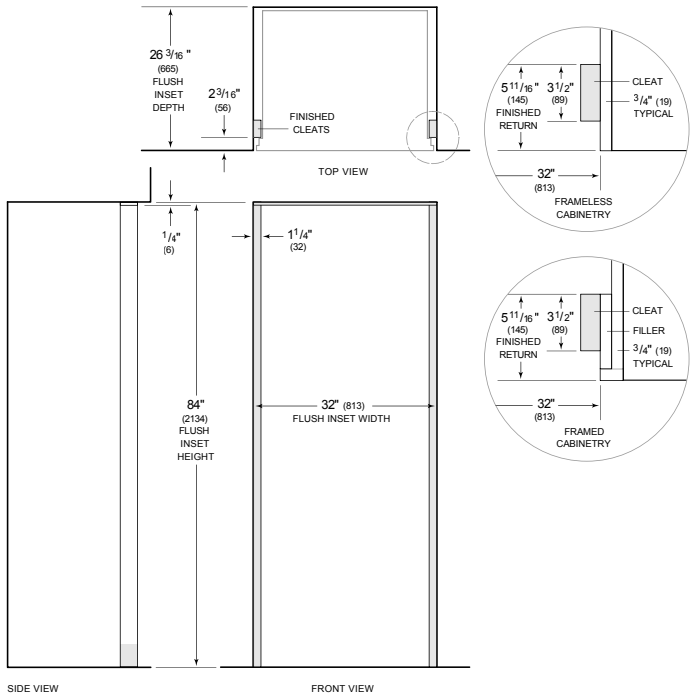

NOTE: 3 1/2" (89) finished returns and shaded areas will be visible and should be finished to match cabinetry. Shaded line represents profile of unit with 1/4" (19) panel.