

# PU75ES



Product Family	Hob
Built-in type	Traditional
Dimensions	30"
Power supply	Gas
Type	Gas
EAN code	8017709184483



## Aesthetics



Colour	Stainless steel
Finishing	Satin
Aesthetics	Piano Design
Material	Stainless Steel
Type of steel	Brushed
Pan stands	Stainless steel
Pan Stand Coating	EverShine
Burners	Piano Design
Burners Material	Stainless steel
Burner Coating	EverShine
Type of control setting	Control knobs
Control knob position	Front
No. of controls	5
Controls colour	Steel effect

## Programs / Functions

Total no. of cook zones	5
No. of gas cook zones	5

## Options



Worktop Cut-Out	478-482x555-560 mm
-----------------	--------------------

# Technical Features

UR

Front-right - Gas - AUX

Rear-right - Gas - Semi Rapid

Central - Gas - UR

Rear-left - Gas - Rapid

Front-left - Gas - AUX

Gas safety valves	Yes	Automatic Ignition	Yes
-------------------	-----	--------------------	-----

# Electrical Connection

Electrical connection rating (W)	1 W	Power supply cable length	47 1/4 "
Voltage (V)	120 V	Terminal box	3 poles
Type of electric cable	Single phase	Plug	B
Frequency (Hz)	60 Hz		

# Gas Connection

Gas Type	G20 Natural gas	Other gas nozzles included	G30 GPL Liquid gas
Gas connection	Cilindrical		

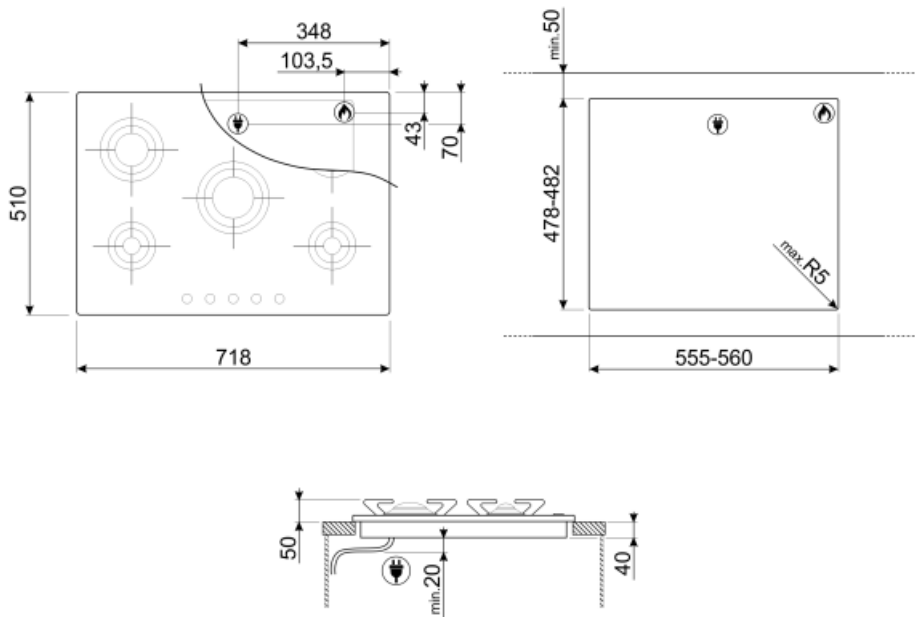

---

## Symbols glossary (TT)

---



Standard installation: Traditional installation in tabletop, suitable for any kitchen sets



Knobs control



CUT\_OUT\_STANDARD\_72dpi



Ever Shine: is an invisible coating that makes the effected area highly resistant to heat.



Ultra rapid burners: Powerful ultra rapid burners offer up to 5kw of power.