



# Neptune™ Outdoor Soundbar

ODSBO1



Immerse yourself in outdoor entertainment at its finest with the all-season Neptune™ Outdoor Soundbar. Whether there's rain, snow, ice or heat, the Neptune™ Outdoor Soundbar can withstand even the most extreme outdoor environments with its IP65 rating. For ease of use and installation, this soundbar features a universal mounting option and both analog and optical connections, making it possible to integrate with any display or TV. Plus, set-up is simple with a direct-wired connection. With additional features such as Bluetooth® Connectivity, high quality drivers that provide full range audio (50Hz – 20Hz), and a built-in Class D amplifier that outputs 200 watts of total system power, your outdoor entertainment gets a complete audio upgrade.

All Weather Rated: IP65

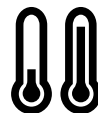

Operating Temperature Range:  
-40°F - 120°F (-40°C - 49°C)

- Built-in Class D amplifier outputs 200W total system power
- IP65 rated aluminum enclosure features rubber gaskets at every seam that completely seal, isolate and protect the soundbar's electronics from the outside environment
- High quality drivers provide great sounding full range audio (50Hz - 20kHz)
- Control the power level, tone, and input selection with the 12 button IR remote control
- Easily mounts to Neptune™ Outdoor TVs with the included outdoor rated mounting hardware
- Digital optical audio input allows for uncompressed digital audio from source

#### IP65 RATED

Withstands the harshest outdoor weather conditions year round

#### COMPATIBILITY

Provides a digital optical audio input and standard analog input, allowing for use with all leading outdoor TVs

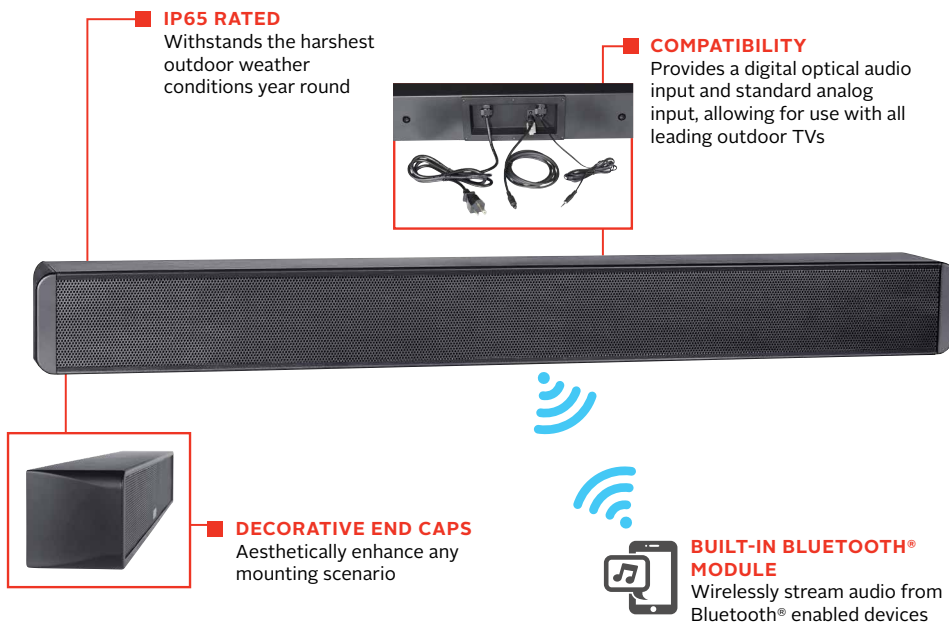

#### DECORATIVE END CAPS

Aesthetically enhance any mounting scenario

#### BUILT-IN BLUETOOTH® MODULE

Wirelessly stream audio from Bluetooth® enabled devices



Compatible with Neptune™ Shade Series Outdoor TVs



FC IP

Bluetooth®

ODSB01	Neptune™ Outdoor Soundbar
--------	---------------------------

Product Specifications

TV SIZE RANGE	42" (107cm) and Above
BUILT-IN CLASS D AMPLIFIER	Total System Power: 200 watts
SPL	105dB
CROSSOVER	Digital Signal Processing (DSP)
DRIVERS	(2) 3" (76mm) Aluminum Drivers
TWEETERS	(2) 1.5" (38mm) Titanium Domes

AUDIO INPUTS	(1) Digital Optical Audio Input, (1) Analog 3.5mm Connector, (1) Bluetooth® 4.0 Input
ENVIRONMENTAL PROTECTION RATING	IP65
FREQUENCY RESPONSE	50Hz - 20kHz
OPERATING TEMPERATURE RANGE	-40°F - 120°F (-40°C - 49°C)
VESA®	400mm Wide Pattern
PRODUCT DIMENSIONS	38.13" x 3.91" x 4.32" (969 x 99 x 110mm)
PRODUCT WEIGHT	9.7lb (4.4kg)

Package Specifications

	PACKAGE SIZE (W x H x D)	PACKAGE SHIP WEIGHT	PACKAGE UPC CODE	PACKAGE CONTENTS	UNITS IN PACKAGE
ODSB01	39.50" x 7.25" x 9.50" (1003 x 184 x 241mm)	18.02lb (8.17kg)	735029329466	Soundbar, (2) End Caps, Power Cable, 3.5 Analog Input Cable, Mounting Hardware, 12 Button IR Remote, User Manual, Digital Optical Audio Cable	1

All dimensions = **inch** (mm)



TOP VIEW

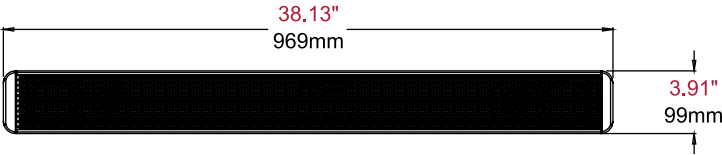

FRONT VIEW



SIDE VIEW

