

NA30R5310FS

SAMSUNG

30" Gas Cooktop



Signature Features

Powerful Burners

- Powerful burners have the flexibility to accommodate a number of dishes at once.

Front Controls

- Front Controls are easy to reach.

Continuous Cast Iron Grates

- Continuous Cast Iron Grates provide a sleek and smooth design.

Available Colours



Stainless Steel



Front Controls



Continuous Cast Iron Grates

Features

- Powerful Cooktop
- 4 Burners with 45K BTU
 - Right Front: 17K BTU (Power Burner)
 - Left Front: 13K BTU
 - Right Rear: 5K BTU (Simmer)
 - Left Rear: 10K BTU

- Cast Iron 2-Piece Grates
- Sealed Burners
- ADA Compliant

Convenience

- LP Conversion Kit



ADA Compliant

NA30R5310FS

SAMSUNG

30" Gas Cooktop

Installation Requirements

Countertop cut-out and minimum clearance dimensions:

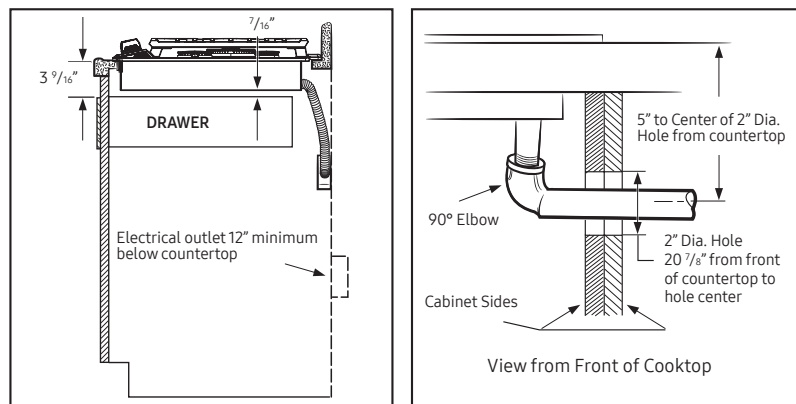
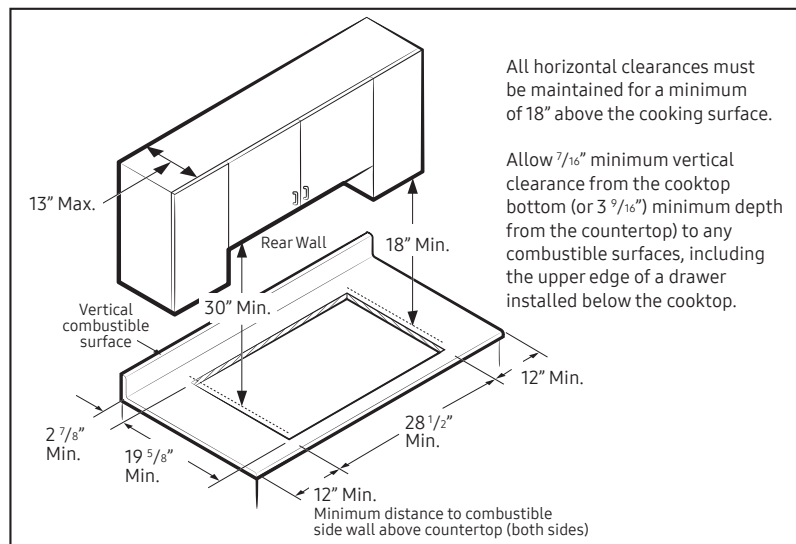

Power Source

120V / 60 Hz / 1A

Gas Cooktop (BTU)

- Total Power: 45K
- Right Front: 17K (Power Burner)
- Left Front: 13K
- Right Rear: 5K (Simmer)
- Left Rear: 10K

Warranty

One (1) Year All Parts and Labour

Product Dimensions & Weight (WxHxD)

Outside (Max) Cooktop Dimensions: 30" x 5 7/10" x 21"

Cooktop Cut-Out Dimensions: 28 1/2" x 3 1/8" x 19 5/8"

Weight: 60.5 lbs (27.4 Kg)

Shipping Dimensions & Weight (WxHxD)

Dimensions: 34 7/10" x 10 3/5" x 25 3/5"

Weight: 71.0 lbs (32.2 Kg)

Colour

Stainless Steel

Model

NA30R5310FS

UPC Code

887276298924

Installing Over a Single Oven

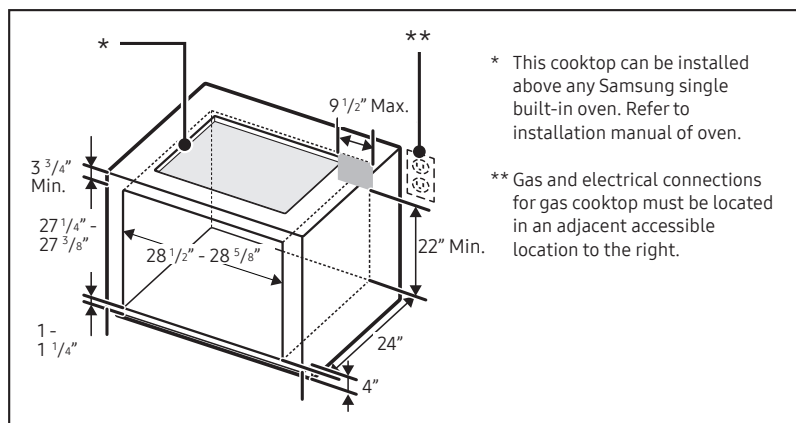

Cooktop Dimensions

