

Model: P2D4-12

Type: DVC Subwoofer

Power Rating: 400 Watts (RMS)

Impedance: (2) 4 ohms

Features

- High modulus Kevlar™ re-inforced paper-pulp cone.
- Dual tear & fatigue resistant poly-cotton spider.
- Tall-profile VAST™ Santoprene™ surround
- High temp 2.25" voice coil w/ spun-laced Nomex™ insulating re-inforcement collar
- Optimized motor magnetics with extended pole and bumped vented backplate.
- Fatigue resistant and reduced strain "stitched on" flexible lead wire design.
- Proprietary spider venting/cooling technique
- Multi-point high-temp/high-strength neck joint bonding technique.
- Sturdy 16 guage compound bend frame geometry.
- Semi-flexible, PVC removable protective motor cover.
- Proprietary all metal, radially oriented compression input terminal assembly.
- Flex-fit™ Mounting pattern
- Die-Cast aluminum soft-touch painted trim ring allows for optional integrated grill

Recommended Applications

Enclosure	Volume (Vb)		Tuning(Fb) Hz	System (Qtc)	-3dB (F3) Hz	Port Dia.		Port Length	
	Liters	cu.ft.				in.	cm	in.	cm
Sealed:	28.9	1.02	44.9	0.97	45.0	-	-	-	-
Ported:	50.7	1.79	40.0	-	35.7	4.0	101.6	11.8	30.1

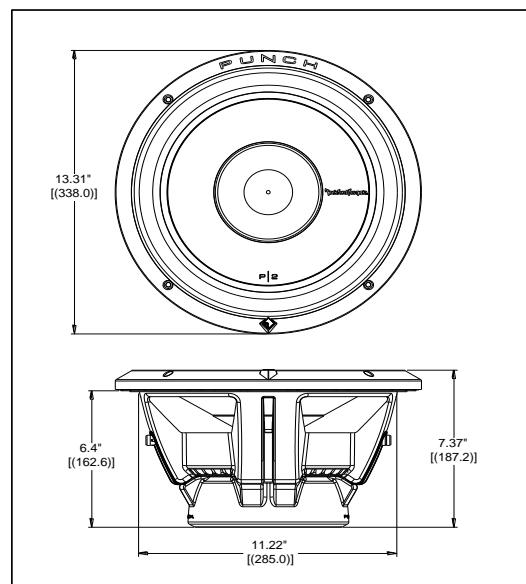

SPL & Excursion (at 400 Watts) / Impedance (at 1 Watt)

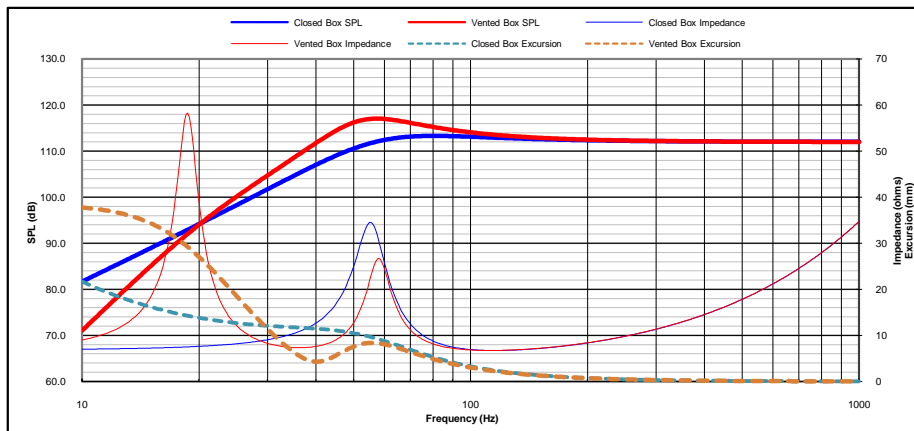

Thiele-Small Specifications

Fs (Hz): 27.2
 Re (Ohms): 6.40
 Le (mH): 5.5
 Qts: 0.54
 Qes: 0.59
 Qms: 6.30
 Cms (mm/N): 0.18
 Vas (L): 81.5
 Mms (g): 194.4
 Mmd (g): 186.6
 Rms (kg/s): 5.3
 Airload (g): 7.8
 No (%): 0.24
 SPL (dB - 1W/1M): 86.0
 BL (T·M): 19.0
 *Xmax₁₀ (mm): 13.3
 Sd (cm²): 570
 EBP: 46
 Krm (mOhms): 0.77
 Erm: 1.28
 Kxm (mH): 50.8
 Exm: 0.78
 Rem (Ohms): 56.00

* All parameters are derived using a laser velocity measurement method and verified with actual measured Mmd and Re. All dual voice coil models are wired in series. Xmax₁₀ represents actual effective excursion at <10% THD.

Technical Specifications

Voice Coil Diameter:	2.25	57.15	inches mm
Voice Coil Height:	1.18	30.0	inches mm
Voice Coil Layers:	4		layers
Magnetic Gap Height:	0.39	10.0	inches mm
Linear Excursion, (Xmax):	0.48	12.1	inches mm
Maximum Excursion (mech), pk-pk:	2.25	57.2	inches mm
Magnet Weight:	72.8	2.06	oz. kg
Woofer Displacement:	4.8	0.170	liters cubic ft.
Net Weight:	14	6.4	lbs. kg
Power Rating:	400	800	RMS Peak