

Digital Music Player
NW-WS623/WS625



Use this manual when you have trouble or when you need to know how to use your WALKMAN®.

The color of Walkman sold in some countries/regions may differ from those shown above.

This Help Guide is also available as a PDF, which can be downloaded [here](#).

The recommended application for Windows computer has been changed to “Music Center for PC”.

The contents of the Help Guide may be subject to change without notice due to updates to the product's specifications.

[Getting Started](#)

[Customer registration websites](#)

[Before first use](#)

[Walkman manuals and general information](#)

[Checking the contents of the package](#)

Using the supplied accessories

Differences between the standard-type earbuds and Swimming Earbuds >

Switching the earbuds >

Installing Music Center for PC (Windows)

Installing Content Transfer (Mac)

Power/Charging

Turning the Walkman on or off

Charging the battery

Extending the battery life

Notes on charging the battery

Basic Operations

Parts and controls

Handling the Walkman

How to place the Walkman on your ears >

Improving the fit >

Detaching the Walkman >

OPR (operation) lamp

Confirming the status from the OPR lamp >

Using the Walkman in water

Water resistant and dust proofing performance of this Walkman >

Switching the earbuds to Swimming Earbuds >

Why does the sound become muffled when you swim? >

Notes while swimming in a pool or the ocean >

Notes on charging the battery after swimming >

Adjusting the volume

Volume operation in compliance with European and Korean Directives

Transferring Music

Preparing music content

Using a Windows computer

Transferring content from a Windows computer using Music Center for PC >

- Transferring content using Windows Explorer >
- Importing content from the Walkman to Music Center for PC >
- Using a Mac computer
- Transferring content from a Mac computer using Content Transfer >
- Transferring content using Mac Finder >
- Creating a playlist on a computer
- Notes on transferring content from a computer

Playing/Organizing/Deleting Music

Playing music

Skipping to the previous or next unit (folder/playlist/album)

Changing the playback mode (Repeat/Shuffle)

Changing the playback range (folder/playlist/album)

Deleting tracks from the Walkman

Playback and calls on a smartphone

Bluetooth

- What you can do with the Bluetooth function >

Connecting the Walkman to a smartphone

- One-touch connections with a smartphone (NFC) >
- Connecting the Walkman to an unpaired Android smartphone for the first time >
- Connecting the Walkman to an unpaired iPhone for the first time >
- Connecting the Walkman to a paired smartphone >

Music playback on a smartphone

- Turning the Bluetooth function on or off >
- Playing music on a smartphone >
- Selecting the Walkman or a smartphone as the sound source >
- Selecting the wireless playback quality >
- Notes on the Bluetooth function >
- Notes on playing music from a smartphone >

Phone calls

- Answering a call / hanging up a call >

- Rejecting a call >
- Notes on the volume for calls on smartphones >

Various Functions

Ambient Sound Mode

- What is Ambient Sound Mode? >
- Using Ambient Sound Mode >

Using the Remote Commander (NW-WS625 only)

- Parts and controls (Remote Commander) >
- Using the Remote Commander >
- Pairing the Walkman with the Remote Commander >
- Replacing the battery of the Remote Commander >
- Notes on using the Remote Commander >

Adjusting the sound settings

- Limiting the volume >
- Moderating the differences in volume level between tracks >

Restarting / Initializing

- Restarting the Walkman >
- Resetting the Walkman to the factory settings >
- Formatting the Walkman memory >

Version information/System updates

- Checking information on the Walkman >
- Updating the Walkman system software >

Announcement

Notes on handling the Walkman

Notes on the headphones

Notes on the built-in battery

Notes on the software

Notes on the sample data

Notes while swimming in a pool or the ocean

Notes on charging the battery after swimming

General Information

Maintenance

[Customer support website](#)

Specifications

Specifications

Battery life

[Maximum recordable number of songs](#)

[Supported formats](#)

[System requirements](#)

Troubleshooting

Power/Charging

- [The Walkman does not function. You cannot turn on the Walkman.](#) >

- [You cannot charge the battery.](#) >

- [The built-in rechargeable battery becomes depleted quickly even after the Walkman is fully charged.](#) >

Computer

- [The computer does not recognize the connected Walkman.](#) >

Playing Music

- [Sound becomes muffled \(low volume\). There is no sound.](#) >

- [The Walkman does not play tracks in the desired order.](#) >

- [The same track or album is played repeatedly. Tracks are played in random order.](#) >

Others

- [How to maintain and clean the Walkman after sports \(swimming or running, etc.\)](#) >

Digital Music Player
NW-WS623/WS625

Customer registration websites

We recommend that you register the Walkman to get better customer support.

For customers in the US:

<http://www.sony.com/walkmanreg/>

For customers in Canada:

English

<http://www.Sony.ca/Registration>

French

<http://www.Sony.ca/Enregistrement>

For customers in Latin America:

<http://www.sony-latin.com/registration>

For customers in Europe:

www.sony.eu/mysony

For customers in Asia/Oceania/the Middle East/Africa:

English/Korean/Traditional Chinese

<http://www.sony-asia.com/dmpwalkman/register/>

Simplified Chinese

https://www.sonystyle.com.cn/b2c_sony/b2c/productRegister.do

The contents of the Help Guide may be subject to change without notice due to updates to the product's specifications.

Digital Music Player
NW-WS623/WS625

Before first use

Thank you for purchasing a Walkman.

- For information on laws, regulations and trademark rights, refer to “Important Information” contained in the supplied software. To read it, install the supplied software on your computer.
- Before you start using the Walkman, read the topics under [Related Topic].
- All other trademarks and registered trademarks are trademarks or registered trademarks of their respective holders. In this manual, TM and ® marks are not specified.

Before you start using the Walkman, check the following information.

Model names

Several model names appear in this [Help Guide]. Some models are not available depending on the country or region where you purchased the Walkman.

Computer system requirements

When you connect the Walkman to a computer, check the computer system requirements.

Battery charging

The battery might be low when you use the Walkman for the first time. Charge the battery before use.

Illustrations

The illustrations shown in this manual are for reference only.
They may differ from the actual product.

Design and specifications are subject to change without notice.

The contents of the Help Guide may be subject to change without notice due to updates to the product's specifications.

Related Topic

- [Walkman manuals and general information](#)
- [System requirements](#)
- [Charging the battery](#)
- [Notes on handling the Walkman](#)
- [Notes on the headphones](#)
- [Notes on the built-in battery](#)
- [Notes on the software](#)
- [Notes on the sample data](#)
- [Notes while swimming in a pool or the ocean](#)

- [Notes on charging the battery after swimming](#)
- [General Information](#)
- [Maintenance](#)
- [Customer support website](#)

4-688-892-12(1) Copyright 2017 Sony Corporation

Digital Music Player
NW-WS623/WS625

Walkman manuals and general information

Sony provides the following manuals and information regarding the Walkman.
The provided manuals explain the following operations and functions.

- Basic operations.
- Unique functions that require explanations.
- Complicated operations that require instructions.

Help Guide

This Help Guide provides the standard operating procedures only.

- How to transfer content to the Walkman.
- How to use various functions.
- Notes on using the Walkman.

Startup Guide (printed)

- Basic steps to start listening to music after you purchase the Walkman.

Instruction Manual (printed)

- Notes on using the Walkman
- Compliance information
- How to access [Important Information]

Read Before Using your Walkman in a Pool or the Ocean

- How to attach Swimming Earbuds
- Notes on using the Walkman in a pool or the ocean
- Maintenance information

Important Information (supplied with the Walkman memory)

- Information on copyrights, laws, and regulations
To read the file, install the supplied software on your computer.

Customer support website (online)

See [Customer support website] in this [Help Guide].

- The latest information on the Walkman
- FAQ: Frequently Asked Questions

Related Topic

- [Customer support website](#)

4-688-892-12(1) Copyright 2017 Sony Corporation

Digital Music Player
NW-WS623/WS625

Checking the contents of the package

NW-WS623/WS625 (Common)

- Walkman (1)
- Earbuds (1 set)
- Swimming Earbuds (1 set)
- USB cradle (1)
- USB cable (1)
- Adjustment band (1)
- Startup Guide
- Instruction Manual
- Read Before Using your Walkman in a Pool or the Ocean

NW-WS625

- Remote Commander (1)

The contents of the Help Guide may be subject to change without notice due to updates to the product's specifications.

Digital Music Player
NW-WS623/WS625

Differences between the standard-type earbuds and Swimming Earbuds

Two different types of earbuds are supplied with the Walkman. Use Swimming Earbuds when you swim.

Standard-type earbuds

You can use the standard-type earbuds in a wide variety of situations.

Swimming Earbuds

Swimming Earbuds prevent water from penetrating the inside of the headphones. You can use Swimming Earbuds to listen to music comfortably when you swim.

Note

- The volume is lower with Swimming Earbuds than with the standard-type earbuds. Turn up the volume if necessary.
- If you replace Swimming Earbuds with the standard-type earbuds, the volume will become louder. Adjust the volume to protect your ears.

The contents of the Help Guide may be subject to change without notice due to updates to the product's specifications.

Related Topic

- [Checking the contents of the package](#)
- [Switching the earbuds](#)
- [Switching the earbuds to Swimming Earbuds](#)

Digital Music Player
NW-WS623/WS625

Switching the earbuds

To enjoy better sound quality, select earbuds with the appropriate size for each ear.

1 Detach the earbuds from the headphones.

Hold the headphones, and then twist and pull the earbuds.
If the earbuds are slippery, wrap them in a soft dry cloth.

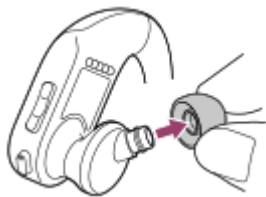

2 Attach new earbuds to the headphones.

Push the earbuds firmly onto the headphones. Align the ends of the earbuds (1) with 2 on the headphones.

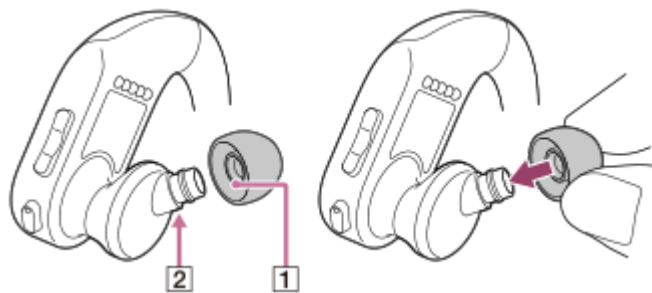

To prevent the earbuds from detaching or getting stuck in your ears, be sure to attach the earbuds correctly.

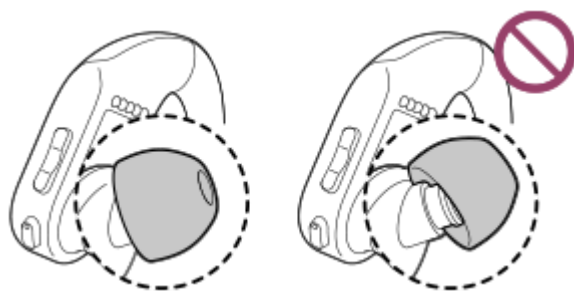

Hint

- When the earbuds become worn, purchase new ones.
- If the earbuds get dirty, remove them from the headphones. Then, hand-wash the earbuds with a neutral detergent. After washing, drain off the water and reattach the earbuds.

Related Topic

- [Checking the contents of the package](#)
- [Differences between the standard-type earbuds and Swimming Earbuds](#)
- [Switching the earbuds to Swimming Earbuds](#)

Digital Music Player
NW-WS623/WS625

Installing Music Center for PC (Windows)

Music Center for PC is an application for Windows computers. Use the latest version of Music Center for PC. You can use Music Center for PC to perform the following operations.

- Importing content (such as music) from CDs to a computer.
- Organizing and managing the content.
For example, you can create playlists.
- Transferring content on a computer to the Walkman.

Confirm the system requirements before you install Music Center for PC.

1 Access the Music Center for PC download website.

<http://www.sony.net/smc4pc/>

2 Install Music Center for PC.

For details on installation, see [Download] – [Installation procedure] on the Music Center for PC support website. (<http://www.sony.net/smc4pc/>)

The contents of the Help Guide may be subject to change without notice due to updates to the product's specifications.

Related Topic

- [Preparing music content](#)
- [Transferring content from a Windows computer using Music Center for PC](#)
- [System requirements](#)

Digital Music Player
NW-WS623/WS625

Installing Content Transfer (Mac)

Content Transfer is software for Mac computers. Use the latest version of Content Transfer. You can transfer content that you manage with iTunes or Finder. You can simply drag-and-drop the tracks or albums to transfer them to the Walkman. Confirm the system requirements before you install Content Transfer.

1 Access the installer for Content Transfer.

<http://www.sony.net/ct-mac/>

2 Open the downloaded file.

[ContentTransfer.dmg] will be saved automatically to the download folder. The folder may open automatically.

3 Install Content Transfer.

Run [ContentTransfer.pkg]. Follow the onscreen instructions. When you finish the installation,  will be displayed.

Note

- Restart the computer if you are prompted. Follow the onscreen instructions.

The contents of the Help Guide may be subject to change without notice due to updates to the product's specifications.

Related Topic

- [Preparing music content](#)
- [Transferring content from a Mac computer using Content Transfer](#)
- [System requirements](#)

Turning the Walkman on or off

1 Hold down the button (1) for 3 seconds.

You will hear the startup sound.
When the Walkman turns on, the lamp (2) lights up.

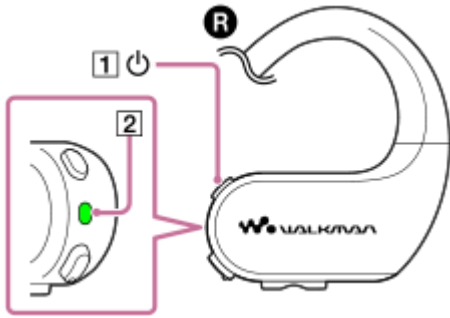

To turn off the Walkman

Hold down the button (1) for 3 seconds.
You will hear the shutdown sound. Then, the Walkman and the lamp (2) will turn off.

Hint

- The Walkman will turn off automatically if you do not operate the Walkman for 30 minutes (only when playback is paused). To turn on the Walkman, hold down the button (1) for 3 seconds.
- When you turn off the Walkman, the Remote Commander (NW-WS625 only) turns off.

The contents of the Help Guide may be subject to change without notice due to updates to the product's specifications.

Related Topic

- [Confirming the status from the OPR lamp](#)
- [Using the Remote Commander](#)

Charging the battery

- 1 **Connect the USB cable (supplied) to the USB cradle (supplied). Then, attach the Walkman to the USB cradle.**

Make sure to connect the terminals (1) and (2).

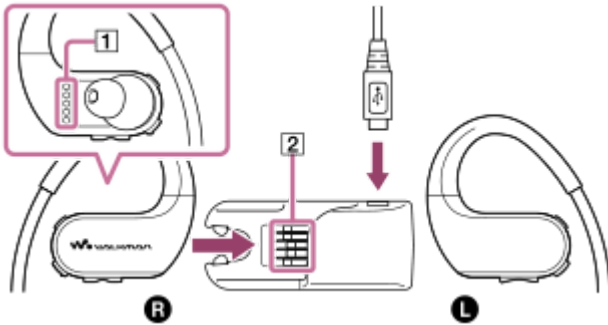

- 2 **Connect the Walkman to a running computer via USB.**

You can check the charging status with the lamp (3).

While the battery is charging: orange

When charging is complete: green

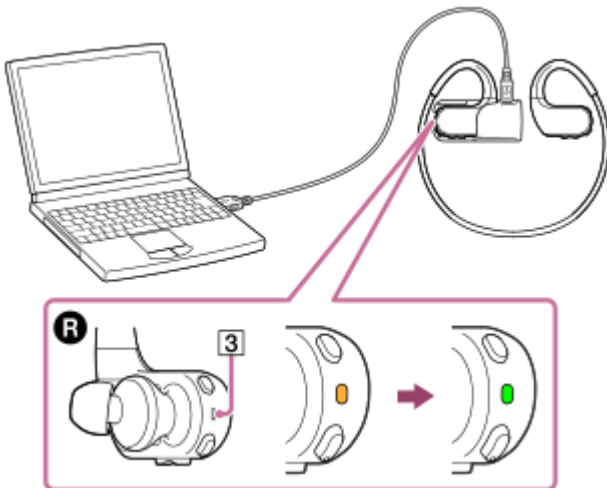

- 3 **Disconnect the Walkman from the computer.**

Hint

- For details on how long it takes to charge the battery fully, see [Specifications].

Note

- The computer may not recognize the Walkman in the following situations.
 - When you connect the Walkman to the computer for the first time.
 - When the Walkman has not been used for a long period of time.
Charge the Walkman for about 10 minutes. The Walkman may start operating normally.

- If the terminals of the Walkman are wet, dry the terminals.
- If the terminals of the Walkman are dirty, clean the terminals with a soft dry cloth.
- You cannot operate the Walkman in the following situations.
 - While the Walkman is connected to a computer.
 - While the battery is charging .

The contents of the Help Guide may be subject to change without notice due to updates to the product's specifications.

Related Topic

- [Extending the battery life](#)
- [Notes on charging the battery](#)
- [Notes on charging the battery after swimming](#)
- [Specifications](#)

4-688-892-12(1) Copyright 2017 Sony Corporation

Digital Music Player
NW-WS623/WS625

Extending the battery life

You can reduce the battery consumption by using the Walkman in the following manner.
The battery life depends on usage conditions. For details on the battery life, see [Battery life].

- Turn off the power manually when you do not use the Walkman.
- Set all sound quality settings to off.
- Turn off the Bluetooth function when you are not using it.

The contents of the Help Guide may be subject to change without notice due to updates to the product's specifications.

Related Topic

- [Charging the battery](#)
- [Turning the Walkman on or off](#)
- [Limiting the volume](#)
- [Moderating the differences in volume level between tracks](#)
- [Turning the Bluetooth function on or off](#)
- [One-touch connections with a smartphone \(NFC\)](#)
- [Notes on the built-in battery](#)
- [Connecting the Walkman to a paired smartphone](#)
- [Battery life](#)

Notes on charging the battery

- The charging time depends on the battery usage conditions.
- When the battery is sufficiently charged but the battery life has dropped to about half of its normal span, the battery may be worn out. Contact the nearest Sony dealer or Sony Service Center.
- The computer may not recognize the Walkman in the following situations.
 - When you connect the Walkman to the computer for the first time.
 - When the Walkman has not been used for a long period of time.
Charge the Walkman for about 10 minutes. The Walkman may start operating normally.
- When the ambient temperature exceeds the recommended range, charging is forcibly terminated. Charge the battery at an ambient temperature from 5 °C to 35 °C (41 °F to 95 °F).
- The battery can be recharged about 500 times from a completely depleted state. The exact number of times may vary depending on the usage conditions.
- To prevent deterioration of the battery, charge the battery at least once every 6 months.
- Charging is not guaranteed when you use a homebuilt or modified computer.
- Charging from a USB hub is only guaranteed when you use a self-powered USB hub that carries an authorized logo.
- Do not connect the Walkman to a computer for a long period of time when the computer is not connected to an AC power supply. Otherwise, the computer's battery may run out.
- While the Walkman is connected to a computer, observe the following cautions. Otherwise, the Walkman may not function properly.
 - Do not turn on the computer.
 - Do not restart the computer.
 - Do not wake the computer from sleep mode.
 - Do not shut down the computer.
- The Walkman may become hot while charging. This is not a malfunction.
- When you charge the Walkman using a computer, do not remove the USB cable while data is transferring. If you disconnect the USB cable, data on the Walkman may be lost.

The contents of the Help Guide may be subject to change without notice due to updates to the product's specifications.

Related Topic

- [Charging the battery](#)
- [Extending the battery life](#)
- [Notes on charging the battery after swimming](#)
- [Notes on the built-in battery](#)
- [Battery life](#)

Digital Music Player
NW-WS623/WS625

Parts and controls

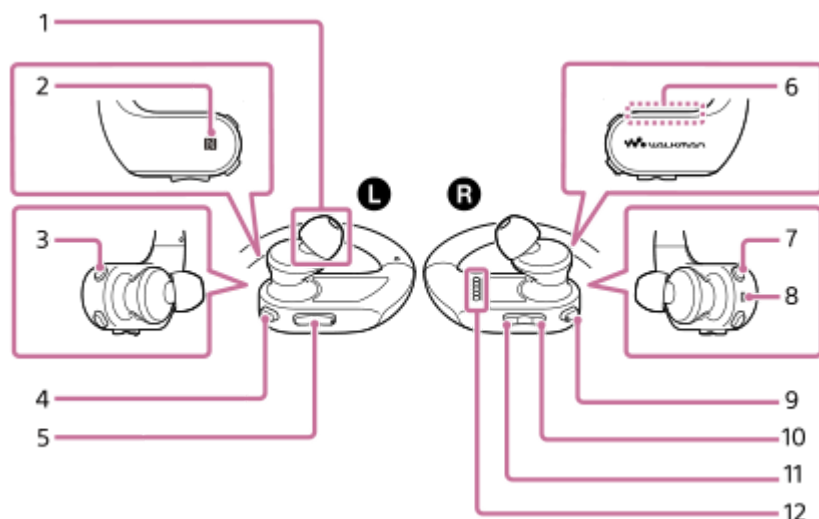

1. Earbud

You can switch the earbuds (standard-type earbuds or Swimming Earbuds) to match the conditions of use. To enjoy better sound quality, select earbuds with the appropriate size for each ear.

2. N-mark

Touch a Bluetooth device to this mark to establish a Bluetooth connection. (The Bluetooth device must support the NFC function.)

3. MODE button

- Press the button to change the playback mode (Normal Play/ Repeat Play/ Shuffle Play/ Shuffle All).
- Hold down the button for 3 seconds to change the playback range (Folder Mode/ Playlist Mode/ Album Mode).
- Double-click the button to play the current track repeatedly (One Track Repeat).

4. AMB/ (Ambient Sound Mode/Bluetooth) button

- Press the button to turn Ambient Sound Mode on or off. You can hear ambient sound even while you are wearing headphones.
- Double-click the button to select a different Ambient Sound Mode. When Ambient Sound Mode is on, you can select an Ambient Sound Mode based on your surrounding environment (Mode A/Mode B/Mode C).
- Hold down the button for 2 seconds to turn the Bluetooth function on or off.
- Hold down the button for 7 seconds to pair the Walkman with a Bluetooth device.

5. + (*1)/- (volume) buttons

Press the buttons to adjust the volume for music playback or a call.

6. Built-in Bluetooth antenna

The antenna allows the Walkman to connect with Bluetooth devices. Do not cover the antenna when a Bluetooth connection is active. Otherwise, the connection may be interrupted.

7. (power) button

- Hold down the button for 3 seconds to turn the Walkman on or off.
- If operations become unstable, hold down the button for 10 seconds to restart the Walkman.

8. OPR (operation) lamp

The lamp indicates the various statuses of the Walkman. (For example, power on or off, etc.)

9. ►|| (play/pause) button (*1)

- Press the button to start or pause playback.
- Press the button to answer or hang up a call while the Walkman is connected to a smartphone.
- Hold down the button for 2 seconds to reject a call.
- Hold down the button for 2 seconds to switch the sound source (the Walkman or the smartphone).
- Hold down the button for 15 seconds to enter the formatting mode.

10. ◀◀ (previous) button

- Press the button to jump back within the current track or to the previous track.
- Hold down the button to fast-rewind playback.
- Double-click the button to go back to the first track of the current folder or album.
- Double-click the button again to jump back to the first track of the previous folder or album.

11. ►► (next) button

- Press the button to skip to the next track.
- Hold down the button to fast-forward playback.
- Double-click the button to skip to the first track of the next folder or album.

12. Terminals

When you charge the battery, connect the terminals to the terminals on the USB cradle (supplied).

*1 There are tactile dots on the ►|| button and the volume + button. The tactile dots can help you operate the buttons without looking at them.

The contents of the Help Guide may be subject to change without notice due to updates to the product's specifications.

Digital Music Player
NW-WS623/WS625

How to place the Walkman on your ears

Select earbuds with the appropriate size for each ear. If the earbuds do not stay in your ears, try another size.

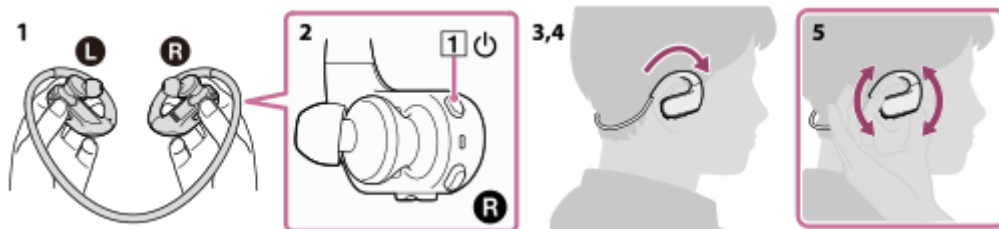

- 1 Check the left and right parts of the Walkman.**
 - L**: left
 - R**: right
- 2 Hold down the button (1) for 3 seconds to turn on the Walkman.**
- 3 Hang the neckband over the top of your ears and behind your head.**
- 4 Place the headphone sections into your ears.**
- 5 Adjust the Walkman so it feels comfortable.**

Hint

- If the Walkman does not feel comfortable, replace the earbuds.
- To use the Walkman for swimming, change the earbuds to Swimming Earbuds.

Note

- Fit the Walkman into your ears while the earbuds and your ears are still dry.
- Fit the earbuds into your ears securely. If there is a gap between your ears and the headphones, water will get into your ears.
- Do not bend or deform the neckband. If you repeatedly bend the same part of the neckband, it may become damaged or break. If the neckband is broken, the internal wire may come out and injure you. In this case, stop using the Walkman.

The contents of the Help Guide may be subject to change without notice due to updates to the product's specifications.

Related Topic

- [Improving the fit](#)

- Differences between the standard-type earbuds and Swimming Earbuds
- Switching the earbuds
- Switching the earbuds to Swimming Earbuds
- Detaching the Walkman

4-688-892-12(1) Copyright 2017 Sony Corporation

Digital Music Player
NW-WS623/WS625

Improving the fit

Try the following to fit the Walkman better on your ears.

Stabilizing the Walkman with the adjustment band (supplied)

Attach the adjustment band to the neckband. The earbuds may fit more firmly into your ears.

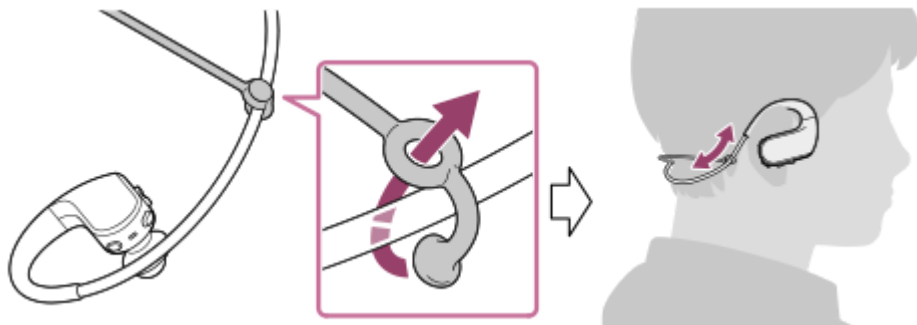

Stabilizing the Walkman with swimming goggles

Stabilize the part next to the arrow in the illustration with the band of your swimming goggles. This prevents the Walkman from detaching due to water pressure.

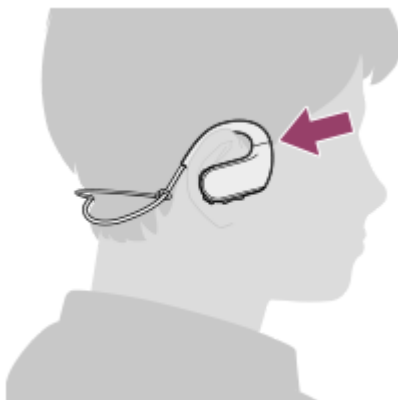

Note

- Do not bend or deform the neckband. If you repeatedly bend the same part of the neckband, it may become damaged or break. If the neckband is broken, the internal wire may come out and injure you. In this case, stop using the Walkman.

The contents of the Help Guide may be subject to change without notice due to updates to the product's specifications.

Related Topic

- [How to place the Walkman on your ears](#)
- [Turning the Walkman on or off](#)

Detaching the Walkman

When you detach the Walkman from your ears, follow the instructions and notes below.

- 1 Gently move the Walkman up and down. Then, detach the Walkman from your ears.

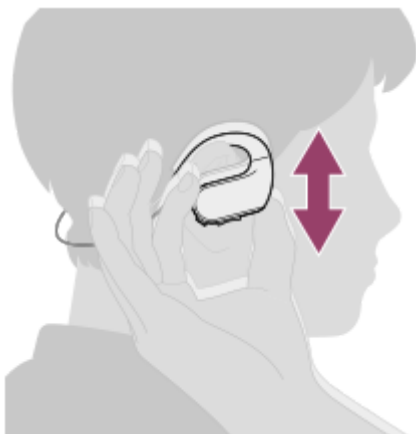

Note

- Do not suddenly detach the Walkman when the earbuds are inserted firmly in your ears. Otherwise, the following problems may occur.
 - Your ears or eardrums may be damaged.
 - The earbuds may remain in your ears.

The contents of the Help Guide may be subject to change without notice due to updates to the product's specifications.

Related Topic

- [Maintenance](#)

Digital Music Player
NW-WS623/WS625

Confirming the status from the OPR lamp

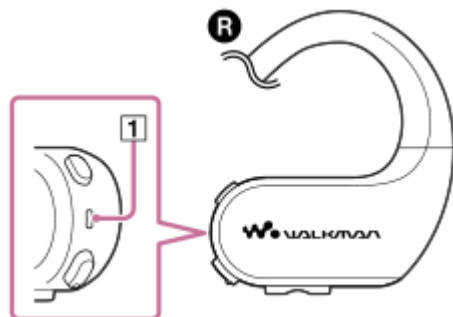

When the Bluetooth function is off

The lamp (1) indicates the condition of the battery and current settings. The lamp has various colors and flashing patterns.

When you turn on the Walkman

Starting up



When you turn on the Walkman, the lamp lights up in green. The Walkman is ready to use.

An error has occurred.



When an error has occurred, the lamp lights up in red for 10 seconds. In this case, restart the Walkman. If the problem persists, format the Walkman memory.

During playback or pausing

The battery is charged sufficiently.



Playback is paused.



The Walkman is playing music.

The battery is low.



Playback is paused.



The Walkman is playing music.

The battery is depleted.



You cannot operate the Walkman. Charge the battery.



When the Walkman cannot play music due to an error, the lamp flashes in red twice.

When the Walkman is connected to a computer



The battery is currently charging.



The battery is fully charged.



Data is currently being transferred between the Walkman and the computer. Do not disconnect the Walkman from the computer.



When you charge the battery at an ambient temperature outside the range of 5°C to 35°C (41 °F to 95 °F), the lamp flashes twice in red repeatedly.

When the Bluetooth function is on

The lamp (1) indicates the status of the Bluetooth connection. The lamp lights up in a combination of blue and other colors. It also has various flashing patterns.

Pairing is in progress.



The Walkman is pairing with a Bluetooth device.

The Walkman is waiting for a connection.



The Walkman is waiting for a Bluetooth connection.

During playback or pausing (after a connection has been established)

The battery is charged sufficiently.



Playback is paused.



The Walkman is playing music.

The battery is low.



Playback is paused.



The Walkman is playing music.

When you answer a call or talk on the phone



The smartphone is receiving a call.



The smartphone is engaged in a call or dialing.

The contents of the Help Guide may be subject to change without notice due to updates to the product's specifications.

Related Topic

- [Restarting the Walkman](#)
- [Formatting the Walkman memory](#)

Digital Music Player
NW-WS623/WS625

Water resistant and dust proofing performance of this Walkman

Liquids that the water resistant performance specifications apply to

The types of liquid that the water resistant specifications of your Walkman apply to are as follows.

Applicable:

Fresh water, tap water, perspiration, pool water, salt water

Not applicable:

Liquids other than those above (examples: soapy water, detergent water, water with bath agents, shampoo, hot spring water, etc.)

The water resistant performance of your Walkman is based on our measurements under the conditions described in this section. Note that malfunctions as a result of water immersion caused by misuse by the customer are not covered by the limited warranty.

Water resistant and dust proofing performance of this Walkman

The water resistance specifications(*1) of this Walkman are equivalent to IEC 60529 "Degrees of protection against ingress of water (IP Code)" IPX5/8(*2), and the dust proofing specifications of this Walkman are equivalent to IEC 60529 "Degrees of protection against solid foreign objects" IP6X(*3). If you use your Walkman in a swimming pool, do not exceed a depth of 2 m (6.5 feet) while wearing it.

Be sure to read and understand the water resistant/dust proof specifications completely before use.

(*1) The headphone sections are not completely watertight.

(*2) **IPX5 (Degrees of protection against jets of water):** Your Walkman, when Swimming earbuds are attached, has been tested under and maintains its operability under the following test conditions: When exposed to direct streams of water from any direction where approximately 12.5 l/min. of water is supplied for more than 3 minutes from a distance of approximately 3 m using a nozzle with an inner diameter of 6.3 mm. However, this does not apply to the headphone sections.

IPX8 (Degrees of protection against continual water submersion): Your Walkman, when Swimming earbuds are attached, has been tested to and maintains its operability when submersed in water to a depth of 2 m for 30 minutes.

(*3) **IP6X (Degrees of protection against dust):** Your Walkman, when Swimming earbuds are attached, has been tested to and continues to block dust after stirring for 8 hours in a testing device which contains dust particles that are up to 75 µm in diameter.

The contents of the Help Guide may be subject to change without notice due to updates to the product's specifications.

Related Topic

- [Switching the earbuds to Swimming Earbuds](#)
- [Why does the sound become muffled when you swim?](#)
- [Notes while swimming in a pool or the ocean](#)
- [Notes on charging the battery after swimming](#)

Switching the earbuds to Swimming Earbuds

Use Swimming Earbuds when you swim.

1 Select the appropriate Swimming Earbuds.

The standard-type earbuds are attached when you purchase the Walkman.

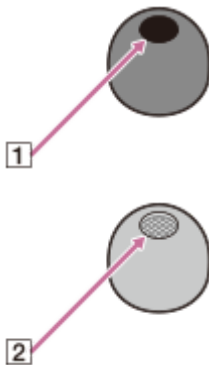

The standard-type earbud has an open hole (1).

The holes in Swimming Earbuds are covered with a thin film (2). This prevents water from getting inside.

2 Select Swimming Earbuds with the appropriate size.

4 different sizes (S/M/L/LL) are supplied.

Select a size with a slightly tighter fit than the standard-type earbuds.

Select the appropriate size for each ear.

3 Attach Swimming Earbuds to the headphones.

Push the earbuds firmly onto the headphones. Align the ends of the earbuds (3) with 4 on the headphones.

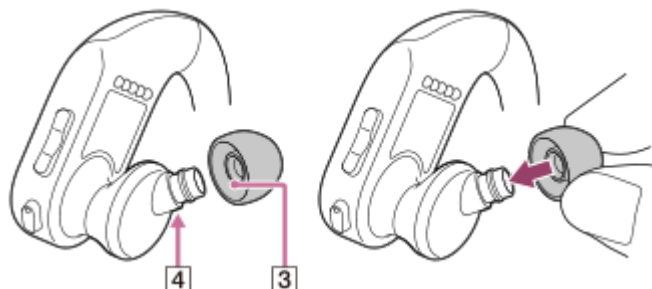

To prevent the earbuds from detaching or getting stuck in your ears, be sure to attach the earbuds correctly.

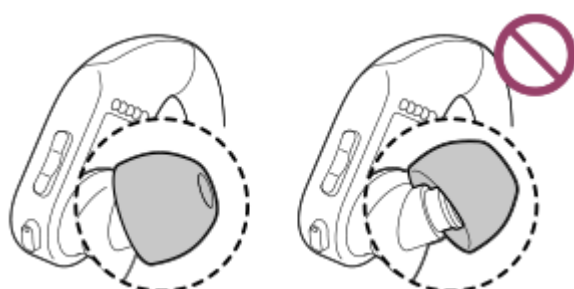

Hint

- If the earbuds become dirty, remove them from the headphones. Then, hand-wash the earbuds with a neutral detergent. After you wash the earbuds, drain off the water and reattach the earbuds.

The contents of the Help Guide may be subject to change without notice due to updates to the product's specifications.

Related Topic

- [Water resistant and dust proofing performance of this Walkman](#)
- [Differences between the standard-type earbuds and Swimming Earbuds](#)

4-688-892-12(1) Copyright 2017 Sony Corporation

Digital Music Player
NW-WS623/WS625

Why does the sound become muffled when you swim?

The sound may become muffled in the following situations.

- Water has penetrated the headphones from the gap between your ears and the headphones (1). The earbuds may not fit your ears securely. Select earbuds with the appropriate size for each ear.
- Water has penetrated and accumulated inside the headphones (2). If you are using the standard-type earbuds, switch them to Swimming Earbuds.

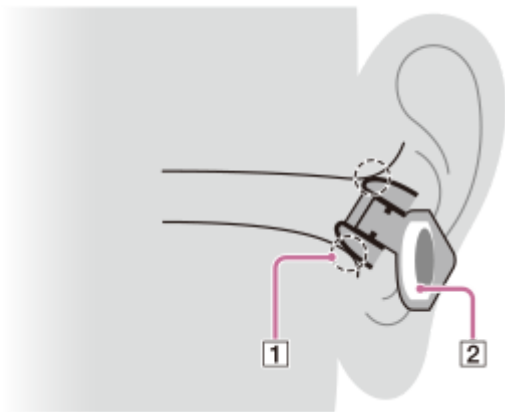

How to remove the water if the sound becomes muffled

If the sound becomes muffled, remove the water as follows.

- Remove the water from your ears.



- Remove the water from the headphones.
Remove the earbuds from the headphones. Then, pat the headphones lightly 5 to 10 times against a dry cloth.

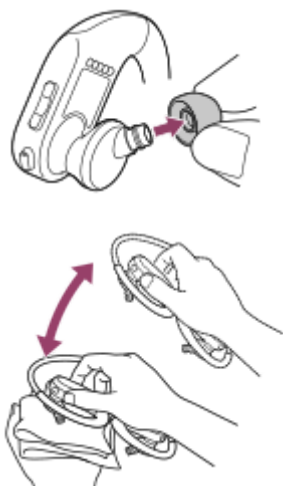

The contents of the Help Guide may be subject to change without notice due to updates to the product's specifications.

Related Topic

- [Detaching the Walkman](#)
- [Switching the earbuds to Swimming Earbuds](#)
- [Maintenance](#)

4-688-892-12(1) Copyright 2017 Sony Corporation

Digital Music Player
NW-WS623/WS625

Notes while swimming in a pool or the ocean

- Do not use your Walkman in a crowded place or in circumstances which an inability to hear surrounding sounds would be dangerous.
- When you use your Walkman in public or private swimming facilities, follow the rules of that facility.
- The earbuds create a seal in your ear canal. Thus, there is a risk of damage to your ears or eardrums if strong pressure is applied to the earbuds, or the earbuds are removed suddenly from your ears. Due to this risk, do not do vigorous exercise, dive into a swimming pool, etc., while wearing your Walkman.
- Do not pour hot water directly on your Walkman and do not blow hot air from a hair dryer, etc., directly on the Walkman. Never use the Walkman in high-temperature locations such as in saunas or near a stove.
- Do not use or leave your Walkman in the following types of environment:
 - in high temperature locations with a temperature above 45 °C (113 °F) such as under the blazing sun, in a car, in warm water or other high temperature and high humidity locations
 - in a cold locations with a temperature below –5 °C (23 °F)
- If you cannot avoid using your Walkman in a location exposed to direct sunlight, cover your Walkman with a towel, etc.
- The sound volume is lower with Swimming earbuds than with standard-type earbuds. Increase the volume as needed.
- When you replace Swimming earbuds with the standard-type earbuds, the sound becomes louder. Adjust the volume so as not to hurt your eardrums.
- Your Walkman may detach and fall during vigorous exercise, etc.
- Your Walkman will sink if dropped in water.
- Radio waves do not transmit through water. You cannot perform the following operations via a Bluetooth connection underwater.
 - Listening to music on a smartphone.
 - Answering a call.
 - Using the Remote Commander (NW-WS625 only).

Notes on Ambient Sound Mode

- When the Swimming earbuds are attached, ambient sound cannot be heard as well as when Standard-type earbuds are attached.
- Ambient sounds cannot be heard well after using your Walkman in a pool or the ocean. Repeatedly pat the parts around the buttons of your Walkman softly against a dry cloth about 30 times. Then place your Walkman on a dry cloth at room temperature for 2 to 3 hours to ensure it is completely dry before the next use.

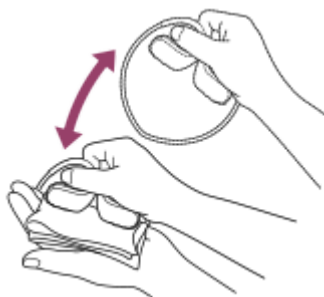

Related Topic

- [Water resistant and dust proofing performance of this Walkman](#)
- [Differences between the standard-type earbuds and Swimming Earbuds](#)

4-688-892-12(1) Copyright 2017 Sony Corporation

Digital Music Player
NW-WS623/WS625

Notes on charging the battery after swimming

- Before you charge the battery, make sure that the Walkman is not wet.
- If the Walkman is wet, wipe the moisture off completely and dry the Walkman at room temperature. Before you charge the battery, make sure that there is no moisture on the Walkman.
- The USB cradle (supplied) is not water-resistant.
 - Do not touch the USB cradle with wet hands.
 - Do not use the USB cradle when the Walkman is wet.

The contents of the Help Guide may be subject to change without notice due to updates to the product's specifications.

Related Topic

- [Water resistant and dust proofing performance of this Walkman](#)
- [Differences between the standard-type earbuds and Swimming Earbuds](#)
- [Maintenance](#)
- [Notes on charging the battery](#)

Digital Music Player
NW-WS623/WS625

Adjusting the volume

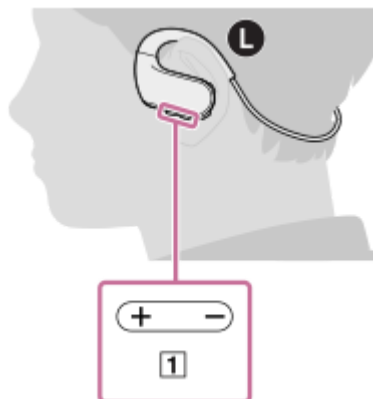

- 1 Press the button (1) to adjust the volume.

There are 31 volume levels, from 0 to 30 (default volume: 10).

Hint

- If the voice guidance is too loud while you are listening to music in the Headphone mode, try the following.
 - Turn down the volume on the Walkman and then turn up the volume on the smartphone.

The contents of the Help Guide may be subject to change without notice due to updates to the product's specifications.

Related Topic

- [Volume operation in compliance with European and Korean Directives](#)

Digital Music Player
NW-WS623/WS625

Volume operation in compliance with European and Korean Directives

- For European customers
- For Korean customers

The voice guidance “Check the volume level” is intended to protect your ears. You will hear this voice guidance initially after you turn up the volume to a harmful level. Press any button to cancel the alarm and warning.

Note

- You can turn up the volume after you cancel the alarm and warning.
- After the initial warning, the alarm and warning will repeat every 20 cumulative hours that the volume is set to a level that is harmful to your ears. When this happens, the volume will turn down automatically.
- If you turn off the Walkman after you have selected a high volume that may damage your eardrums, the volume level will automatically be lower when you turn on the Walkman the next time.
- The alarm does not sound when the Walkman is in the Headphone mode.

The contents of the Help Guide may be subject to change without notice due to updates to the product's specifications.

Related Topic

- [Adjusting the volume](#)

Digital Music Player
NW-WS623/WS625

Preparing music content

Before you transfer music content to the Walkman, you need to prepare the content. This topic includes instructions for the following operations.

- Importing content from an audio CD to Music Center for PC.
- Importing content stored on a computer to Music Center for PC.
- Importing content stored on an external media device to a computer.
- Purchasing content from online music services.

The instructions below are for operations using Music Center for PC. Music Center for PC is the recommended application for the Walkman. Install Music Center for PC in advance.

Note

- Imported content is limited to private use only. Use of content for other purposes requires the permission of the copyright holders.
- If you are using a Mac computer, use Content Transfer.

Importing content from an audio CD to Music Center for PC

1. Use a computer on which Music Center for PC has been installed.
2. Launch Music Center for PC.
3. Insert an audio CD into the media drive of the computer.
The content on the audio CD will appear on the Music Center for PC screen.
You can change the format setting for importing CDs, if necessary.
 - For higher sound quality: FLAC
 - For normal sound quality: AAC (.mp4), MP3 (.mp3)

4. Import the content on the audio CD to Music Center for PC.

For details on the procedure, see [How to use] on the Music Center for PC support website.
(<http://www.sony.net/smc4pc/>)

Hint

- You can also use iTunes instead of Music Center for PC to import audio CDs.

Importing content stored on a computer to Music Center for PC

1. Use a computer on which Music Center for PC has been installed.
2. Launch Music Center for PC.
3. From the left pane on the Music Center for PC screen, select the menu for importing content from a computer.
You can specify a folder for the content that you want to import.
4. Start importing the content.

For details on the procedure, see [How to use] on the Music Center for PC support website.
(<http://www.sony.net/smc4pc/>)

Importing content stored on an external media device to a computer

Use an external media device that contains music content.

The following instructions are for Windows Explorer. If you are using a Mac computer, use Finder.

1. Connect the external media device to a computer.
2. Open the external media device in Windows Explorer.
3. Open the [Music] folder of the computer in Windows Explorer.
4. Drag-and-drop the folders or files from the external media device to the [Music] folder on the computer.

Purchasing content from online music services

You can purchase music content from online music services.

Check the service guide for the provider you use. Each service provider has different downloading procedures, compatible file formats, and payment methods. Note that the provider may choose to suspend or terminate the service without notice.

The contents of the Help Guide may be subject to change without notice due to updates to the product's specifications.

Related Topic

- [Installing Music Center for PC \(Windows\)](#)
- [Installing Content Transfer \(Mac\)](#)
- [Transferring content from a Windows computer using Music Center for PC](#)
- [Transferring content using Windows Explorer](#)
- [Transferring content from a Mac computer using Content Transfer](#)
- [Transferring content using Mac Finder](#)
- [Playing music](#)

Transferring content from a Windows computer using Music Center for PC

You can transfer content that is stored on a Windows computer to the Walkman via Music Center for PC.

1 Use a computer on which Music Center for PC has been installed.

2 Launch Music Center for PC.

3 Connect the Walkman to the computer via USB.



4 Click  in the bottom left of Music Center for PC to open the list of content on the Walkman.

5 Select [Music Library] to open the list of content on Music Center for PC.

6 Select albums or tracks that you want to transfer.

7 Click  to transfer.

For details on the procedure, see [How to use] on the Music Center for PC support website.
(<http://www.sony.net/smc4pc/>)

Note

- Do not disconnect the USB cable during data transfer. Otherwise, the data may be damaged.
- Transferred content is limited to private use only. Use of content for other purposes requires the permission of the copyright holders.

The contents of the Help Guide may be subject to change without notice due to updates to the product's specifications.

Related Topic

- [Installing Music Center for PC \(Windows\)](#)

- Preparing music content
- Transferring content using Windows Explorer
- Playing music

4-688-892-12(1) Copyright 2017 Sony Corporation

Digital Music Player
NW-WS623/WS625

Transferring content using Windows Explorer

You can transfer content directly by dragging and dropping it from Windows Explorer.

1 Connect the Walkman to the computer via USB.

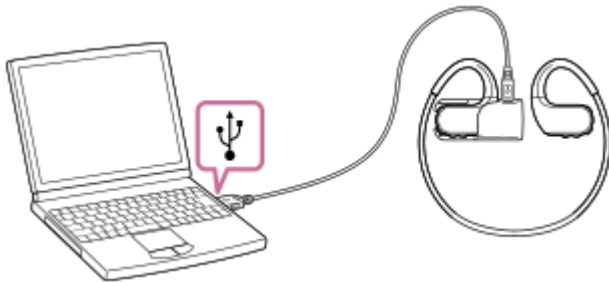

2 Open the [WALKMAN] folder as follows.

- Windows 10:
Open [File Explorer] from the [Start] menu. Select [WALKMAN] from the left pane.
- Windows 8.1:
Open [File Explorer] from [Desktop]. Select [WALKMAN] from the list under [This PC].
- Windows 7:
Select [Start], [Computer], and then [WALKMAN].

3 Open the [MUSIC] folder in [WALKMAN].

4 Drag-and-drop the files or folders on the computer to the [MUSIC] folder.

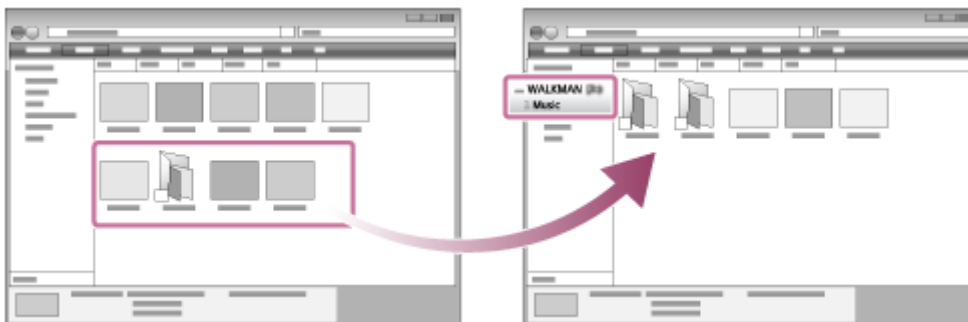

Confirm that the transfer is complete. Then, disconnect the Walkman from the computer.

Note

- Observe the following precautions. Otherwise, the Walkman may not be able to play the files.
 - Do not change the names of the root folders (such as [MUSIC]).
 - Do not transfer the files to folders other than [MUSIC].
 - Do not disconnect the USB cable during data transfer.
 - Do not format the memory of the Walkman on the computer.
- Transferred content is limited to private use only. Use of content for other purposes requires the permission of the copyright holders.

- Do not disconnect the Walkman while the OPR lamp is flashing. Otherwise, data that is being transferred or stored by the Walkman may become damaged. If the Walkman is disconnected while files are being transferred, unnecessary files may be left on the Walkman. If the problem occurs, transfer usable files back to the computer and format the Walkman.

The contents of the Help Guide may be subject to change without notice due to updates to the product's specifications.

Related Topic



- [Preparing music content](#)
- [Transferring content from a Windows computer using Music Center for PC](#)
- [Playing music](#)

4-688-892-12(1) Copyright 2017 Sony Corporation

Importing content from the Walkman to Music Center for PC

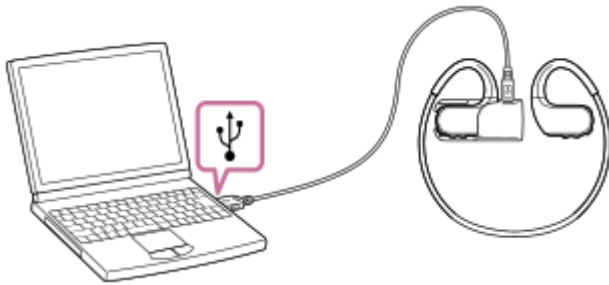
- 1 Use a computer on which Music Center for PC has been installed.
- 2 Launch Music Center for PC.
- 3 Connect the Walkman to the computer via USB.



- 4 Click  in the bottom left of Music Center for PC to open the list of content on the Walkman.
- 5 From the list of content on the Walkman, select the content that you want to import to Music Center for PC.
- 6 Click  in Music Center for PC.

For details on the procedure, see [How to use] on the Music Center for PC support website.
(<http://www.sony.net/smc4pc/>)

Note

- Do not disconnect the USB cable during data transfer. Otherwise, the data may be damaged.
- Imported content is limited to private use only. Use of content for other purposes requires the permission of the copyright holders.

The contents of the Help Guide may be subject to change without notice due to updates to the product's specifications.

Related Topic

- [Installing Music Center for PC \(Windows\)](#)
- [Playing music](#)
- [Supported formats](#)

Digital Music Player
NW-WS623/WS625

Transferring content from a Mac computer using Content Transfer

You can use Content Transfer. Content with copyright protection cannot be transferred.

1 Use a computer on which Content Transfer has been installed.

2 Launch Content Transfer.



3 Connect the Walkman to the computer via USB.



4 Open Finder or iTunes. Then, select the content.

5 Drag-and-drop the content into Content Transfer.

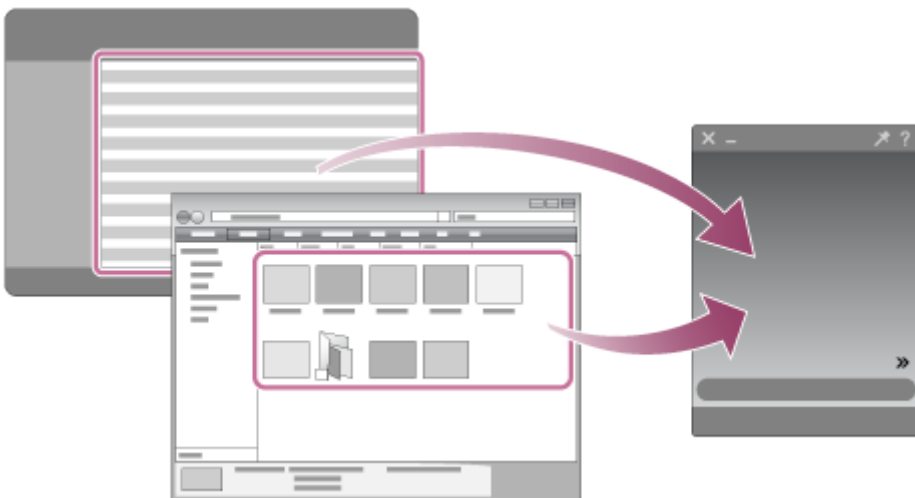

Confirm that the transfer is complete. Then, disconnect the Walkman from the computer.

Note

- Operation may not be guaranteed depending on the version of iTunes.

- Do not disconnect the USB cable during data transfer. Otherwise, the data may be damaged.
- Transferred content is limited to private use only. Use of content for other purposes requires the permission of the copyright holders.

The contents of the Help Guide may be subject to change without notice due to updates to the product's specifications.

Related Topic

- [Installing Content Transfer \(Mac\)](#)
- [Preparing music content](#)
- [Playing music](#)

4-688-892-12(1) Copyright 2017 Sony Corporation

Transferring content using Mac Finder

You can transfer content directly by dragging and dropping it from Finder.

- 1 Connect the Walkman to a running computer via USB.

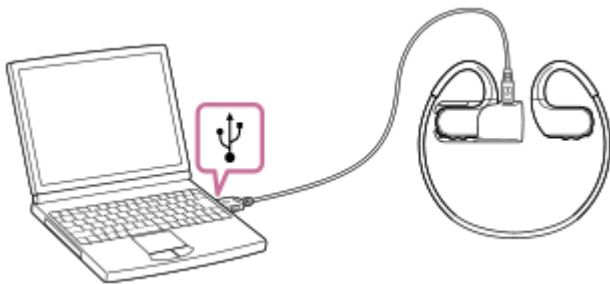

- 2 Select [WALKMAN] in the sidebar of the Finder.

- 3 Open the [MUSIC] folder in [WALKMAN].

- 4 Drag-and-drop the files or folders (1) to the [MUSIC] folder (2) in [WALKMAN].

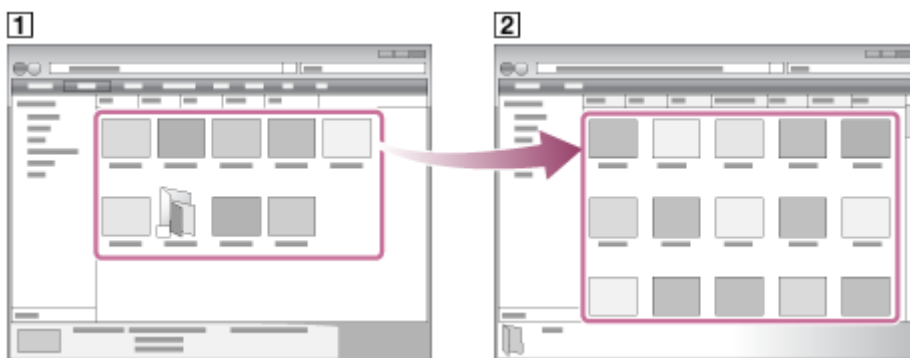

Confirm that the transfer is complete. Then, disconnect the Walkman from the computer.

Note

- Observe the following precautions. Otherwise, the Walkman may not be able to play the files.
 - Do not change the names of the root folders (such as [MUSIC]).
 - Do not transfer the files to folders other than [MUSIC].
 - Do not disconnect the USB cable during data transfer.
 - Do not format the memory of the Walkman on the computer.
- Transferred content is limited to private use only. Use of content for other purposes requires the permission of the copyright holders.
- Do not disconnect the Walkman while the OPR lamp is flashing. Otherwise, data that is being transferred or stored by the Walkman may become damaged. If the Walkman is disconnected while files are being transferred, unnecessary files may be left on the Walkman. If the problem occurs, transfer usable files back to the computer and format the Walkman.

The contents of the Help Guide may be subject to change without notice due to updates to the product's specifications.

Related Topic

- [Installing Content Transfer \(Mac\)](#)
- [Preparing music content](#)
- [Playing music](#)

4-688-892-12(1) Copyright 2017 Sony Corporation

Digital Music Player
NW-WS623/WS625

Creating a playlist on a computer

You cannot create a playlist using the Walkman. Create a playlist on a computer and transfer it to the Walkman.

Windows:

- Create a playlist using Music Center for PC and transfer it to the Walkman.
- Create a playlist using iTunes. Import the playlist and transfer it to the Walkman using Music Center for PC.

Mac:

- Create a playlist using iTunes and transfer it to the Walkman using Content Transfer.

Hint

- For detailed instructions, refer to the online Help information for the software.

The contents of the Help Guide may be subject to change without notice due to updates to the product's specifications.

Related Topic

- [Transferring content from a Windows computer using Music Center for PC](#)
- [Transferring content from a Mac computer using Content Transfer](#)
- [Skipping to the previous or next unit \(folder/playlist/album\)](#)
- [Changing the playback range \(folder/playlist/album\)](#)

Digital Music Player
NW-WS623/WS625

Notes on transferring content from a computer

Drag-and-drop content into the correct folder as shown in the following illustration. The Walkman can play back content stored in the first through seventh level of each folder.

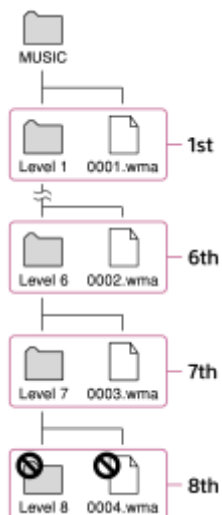

Note

- Do not rename the following default folders. Otherwise, the Walkman will not recognize the folders.
 - MUSIC

The contents of the Help Guide may be subject to change without notice due to updates to the product's specifications.

Playing music

You need to transfer music content from a computer to the Walkman in advance.

On a Windows computer

- Use Music Center for PC to transfer content from a CD or the computer to the Walkman.
- Drag-and-drop content from Windows Explorer.

On a Mac computer

- Use Content Transfer to transfer content from iTunes.
- Drag-and-drop content from Finder.

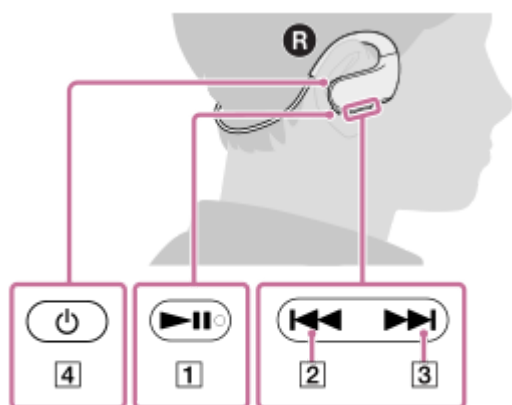

1 Press the button (1) to start playback.

Press the button (1) again to pause playback.

Operation button	Function
▶ (1)	Press the button to start or pause playback.
◀◀ (2)	Press the button to skip to the beginning of the current track or the previous track. Hold down the button to fast rewind the track while playing.
▶▶ (3)	Press the button to skip to the beginning of the next track. Hold down the button to fast forward the track while playing.

Hint

- The Walkman will turn off automatically if you do not operate the Walkman for 30 minutes (only when playback is paused). Hold down the button (4) for 3 seconds to turn on the Walkman.
- After the Walkman plays the last track, the Walkman automatically restarts playback from the first track in sequential order.

Note

- Depending on how you transferred the tracks to the Walkman, the Walkman may play tracks in a different order from the track order on the computer. To specify the track order, create a playlist with Music Center for PC or iTunes and transfer it to the Walkman.

The contents of the Help Guide may be subject to change without notice due to updates to the product's specifications.

Related Topic

- [Creating a playlist on a computer](#)
- [Turning the Walkman on or off](#)
- [Installing Music Center for PC \(Windows\)](#)
- [Preparing music content](#)
- [Transferring content from a Windows computer using Music Center for PC](#)
- [Transferring content using Windows Explorer](#)
- [Transferring content from a Mac computer using Content Transfer](#)
- [Transferring content using Mac Finder](#)
- [Adjusting the volume](#)
- [Changing the playback mode \(Repeat/Shuffle\)](#)

4-688-892-12(1) Copyright 2017 Sony Corporation

Digital Music Player
NW-WS623/WS625

Skipping to the previous or next unit (folder/playlist/album)

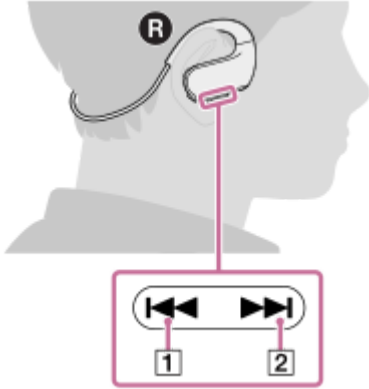

1 Double-click the button (**1** or **2**).

- Double-click the button (**2**) to skip to the beginning of the next unit (folder/playlist/album). You will hear the voice guidance (Next Folder, Next Playlist, Next Album).
- Double-click the button (**1**) to return to the first track in the current unit (folder/playlist/album). You will hear the voice guidance (Previous Folder, Previous Playlist, Previous Album).
- Double-click the button (**1**) again to jump back to the beginning of the previous unit (folder/playlist/album). You will hear the voice guidance (Previous Folder, Previous Playlist, Previous Album).

Hint

- To play tracks in a playlist, you need to transfer the playlist to the Walkman in advance. Create and transfer playlists to the Walkman with software such as Music Center for PC.

Note

- You cannot skip to the previous or next unit during playback in the Headphone mode.

The contents of the Help Guide may be subject to change without notice due to updates to the product's specifications.

Related Topic

- [Playing music](#)
- [Changing the playback range \(folder/playlist/album\)](#)
- [Creating a playlist on a computer](#)

Digital Music Player
NW-WS623/WS625

Changing the playback mode (Repeat/Shuffle)

You can select a playback mode from the following. The Walkman plays tracks in the normal playback mode as a default. You cannot change the playback mode during playback in the Headphone mode.

- Normal playback
- Repeat playback
- Shuffle playback
- Shuffle All playback
- One Track Repeat playback

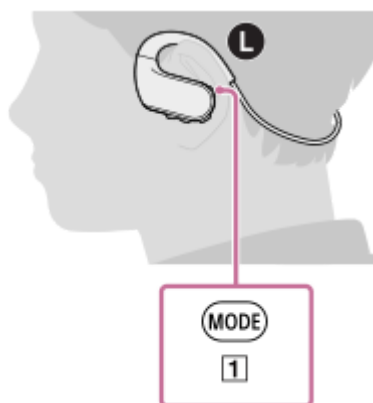

Repeat playback

The Walkman plays tracks repeatedly. You can change the playback range.

1. Press the button (**1**) repeatedly until you hear [Repeat Play].
Each time you press the button (**1**), you will hear the voice guidance and the playback mode will change in the following order.
[Normal Play] – [Repeat Play] – [Shuffle Play] – [Shuffle All] – [Normal Play]...
To switch to the next playback mode, wait until the voice guidance ends.

Hint

- To play the current track repeatedly, double-click the button (**1**) during playback.
- The playback range is set to [Folder Mode] as a default. To play tracks by album repeatedly, set the playback range to [Album Mode]. If you want to play all tracks repeatedly, set the playback range to [Folder Mode] and select [Normal Play] as the playback mode.

Shuffle playback

The Walkman plays tracks in a selected playback unit in random order. You can change the playback range.

1. Press the button (**1**) repeatedly until you hear [Shuffle Play].
Each time you press the button (**1**), you hear the voice guidance and the playback mode will change in the following order.
[Normal Play] – [Repeat Play] – [Shuffle Play] – [Shuffle All] – [Normal Play]...
To switch to the next playback mode, wait until the voice guidance ends.

Hint

- The playback range is set to [Folder Mode] as a default. To play tracks by album in random order, set the playback range to [Album Mode]. If you want to play all tracks in random order, set the playback mode to [Shuffle All].

Shuffle All playback

The Walkman plays all tracks in random order.

1. Press the button (**1**) repeatedly until you hear [Shuffle All].

Each time you press the button (**1**), you will hear the voice guidance and the playback mode will change in the following order.

[Normal Play] – [Repeat Play] – [Shuffle Play] – [Shuffle All] – [Normal Play]...

To switch to the next playback mode, wait until the voice guidance ends.

Note

- You cannot change the playback range during playback.
- You cannot skip to the previous or next folder/album during playback.

One Track Repeat playback

The Walkman plays the current track repeatedly.

1. Double-click the button (**1**) during playback.

To cancel the One Track Repeat playback mode, double-click the button (**1**) again.

Note

- During One Track Repeat playback, you cannot change the playback range.

The contents of the Help Guide may be subject to change without notice due to updates to the product's specifications.

Related Topic

- [Playing music](#)
- [Changing the playback range \(folder/playlist/album\)](#)

Changing the playback range (folder/playlist/album)

You can change the playback range. The Walkman plays tracks by folder as a default.

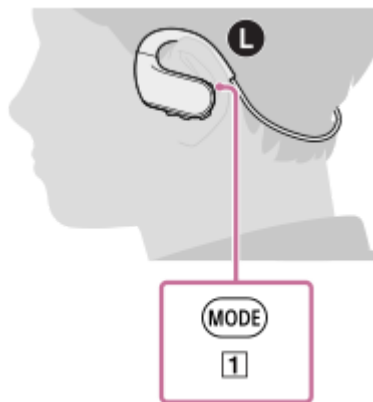

1 Hold down the button (1) for 3 seconds to select the desired range.

Each time you hold down the button (1) for 3 seconds, you will hear the voice guidance and the playback range will change in the following order.

[Folder Mode] – [Playlist Mode] – [Album Mode] – [Folder Mode]...

To switch to the next playback range, wait until the voice guidance ends.

- **Folder Mode**

The Walkman plays tracks by folder. Folders are groups of tracks that you can view in Windows Explorer or Mac Finder.

- **Playlist Mode**

The Walkman plays tracks by playlist. Create playlists using software (such as Music Center for PC or iTunes) in order to play tracks in your desired order. If you have not transferred any playlists, you cannot select this range.

- **Album Mode**

The Walkman plays tracks by album. Albums are groups of tracks that are organized based on album information.

Note

- You cannot change the playback range during playback in the Headphone mode.

The contents of the Help Guide may be subject to change without notice due to updates to the product's specifications.

Related Topic

- [Playing music](#)

- [Creating a playlist on a computer](#)

4-688-892-12(1) Copyright 2017 Sony Corporation

Digital Music Player
NW-WS623/WS625

Deleting tracks from the Walkman

You cannot delete tracks using the Walkman.

To delete tracks from the Walkman, use software on a computer.

Windows: Use Windows Explorer.

Mac: Use Mac Finder.

Hint

- Sample music is pre-installed on the Walkman. Use software on a computer to delete the sample music.

Note

- When you delete tracks using a computer, do not delete or rename the root folder (such as [MUSIC]). Otherwise, the Walkman will not recognize the content.

The contents of the Help Guide may be subject to change without notice due to updates to the product's specifications.

Digital Music Player
NW-WS623/WS625

What you can do with the Bluetooth function

The Walkman uses Bluetooth wireless technology.

With Bluetooth wireless technology, you can do the following:

- Listen to music on a Bluetooth device wirelessly.
- Answer and hang up a phone call from a smartphone wirelessly.

Listening to music

You can receive audio signals from Bluetooth devices (*1) to enjoy music wirelessly.

*1 Smartphones, mobile phones, or music players, etc.

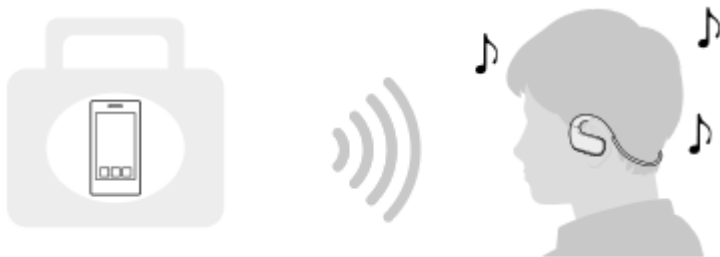

Answering a phone call

You can answer and hang up a phone call via an active Bluetooth connection.



The contents of the Help Guide may be subject to change without notice due to updates to the product's specifications.

Related Topic

- [Turning the Bluetooth function on or off](#)
- [Notes on the Bluetooth function](#)



One-touch connections with a smartphone (NFC)

When you touch the Walkman to a smartphone, the Walkman turns on and pairs with the smartphone automatically. You can establish a Bluetooth connection through a simple operation.

Compatible smartphones

NFC-compatible smartphones with Android 4.1 or later

NFC

NFC (Near Field Communication) technology enables short-range wireless communication between various devices (such as smartphones and IC tags). With NFC technology, data communications (*1) can easily be realized by simply touching NFC-compatible devices together (for example, at the N-Mark symbol or at location designated on each device).

*1 Bluetooth pairing, etc.

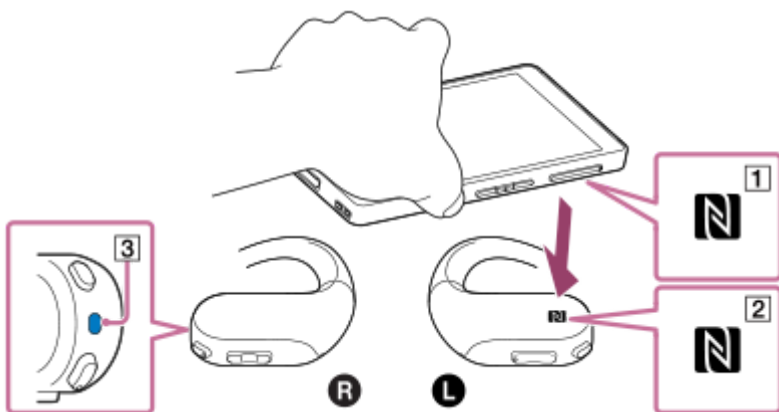

1 Unlock the smartphone screen.

2 Turn on the NFC function on the smartphone.

For details, refer to the operating manual for the smartphone.

3 Touch the N-mark on the smartphone (1) to the N-mark on the Walkman (2).

- Hold the Walkman and the smartphone together until the smartphone responds.
- If you cannot find the N-Mark on the smartphone, refer to the operating manual for the smartphone.

4 Follow the onscreen instructions to complete the pairing and connection.

When the Walkman connects to the smartphone, the lamp (3) lights up.

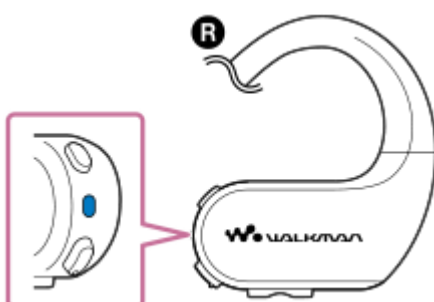

To disconnect the Walkman from the smartphone

Touch the Walkman to the smartphone again.

When you disconnect the Walkman from a smartphone by touching the devices together, the Walkman switches to the Walkman mode.

Hint

- If you cannot connect the Walkman to the smartphone, try the following:
 - If the screen of the smartphone is locked, unlock the screen.
 - Move the smartphone slowly over the N-Mark on the Walkman (②).
 - If the smartphone is inside a case, take it out of the case.

Note

- If you touch the smartphone to the N-Mark on the Walkman (②) while using the Remote Commander (NW-WS625 only), the Remote Commander may turn off. In this case, turn on the Remote Commander again.

The contents of the Help Guide may be subject to change without notice due to updates to the product's specifications.

Related Topic

- [Turning the Walkman on or off](#)
- [Turning the Bluetooth function on or off](#)
- [Notes on the Bluetooth function](#)
- [Confirming the status from the OPR lamp](#)

Digital Music Player
NW-WS623/WS625

Connecting the Walkman to an unpaired Android smartphone for the first time

If you connect the Walkman to an Android smartphone, you can listen to music on the smartphone. Before you use the Walkman with an Android smartphone, pair the Walkman and the smartphone. Once the Walkman and the smartphone are paired, you can easily connect the Walkman to the smartphone in the future.

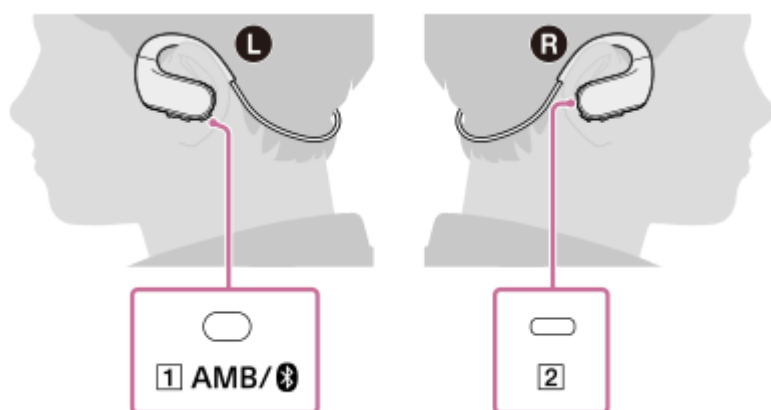

1 Make sure that the Walkman is turned on and the Bluetooth function is turned off.

If the Bluetooth function is turned on, hold down the button (1) for 2 seconds. The color of the lamp (2) will change.

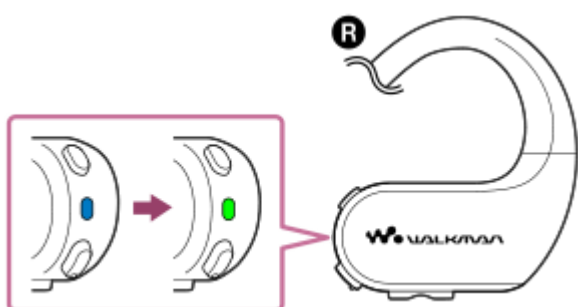

2 Hold down the button (1) for 7 seconds.

The lamp (2) will flash quickly and pairing will start.

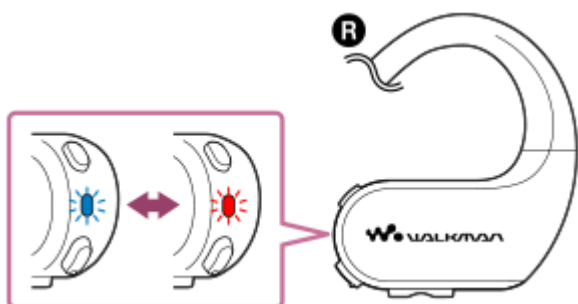

3 Turn on the Bluetooth function on the smartphone.

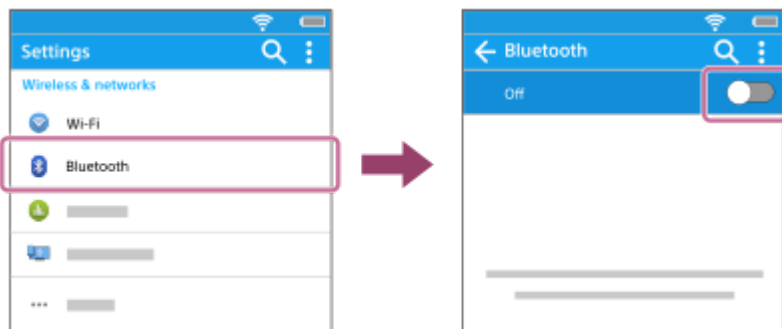

4 Tap the model name of the Walkman. ([NW-WS623] or [NW-WS625])

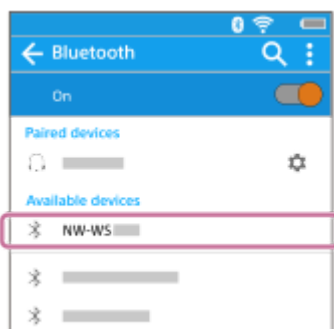

Depending on the smartphone that you are using, the search may start automatically.

If passkey input is required, enter "0000". The passkey may also be called a "passcode", "PIN code", "PIN number", or "password".

Make sure that the Walkman and the smartphone are paired to each other. When the connection is established, the lamp (2) lights up.

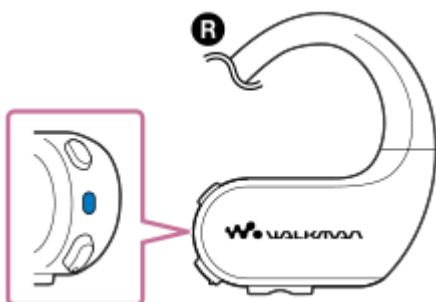

Hint

- If the smartphone has an NFC function, you can pair and connect the devices by touching them together.

Note

- Once you have successfully completed pairing, you do not have to pair the devices again for future connections between them.
- The above procedure is an example. For details, refer to the operating manual for the Android smartphone.
- If you pair the Walkman and a smartphone while you are using the Remote Commander (NW-WS625 only), the Remote Commander may turn off. In this case, turn on the Remote Commander again.

Related Topic

- [Turning the Bluetooth function on or off](#)
- [Connecting the Walkman to a paired smartphone](#)
- [One-touch connections with a smartphone \(NFC\)](#)
- [Notes on the Bluetooth function](#)
- [Confirming the status from the OPR lamp](#)

4-688-892-12(1) Copyright 2017 Sony Corporation

Connecting the Walkman to an unpaired iPhone for the first time

If you connect the Walkman to an iPhone, you can listen to music on iPhone. Before you use the Walkman with an iPhone, pair the Walkman and the iPhone. Once the Walkman and the iPhone are paired, you can easily connect the Walkman to the iPhone in the future.

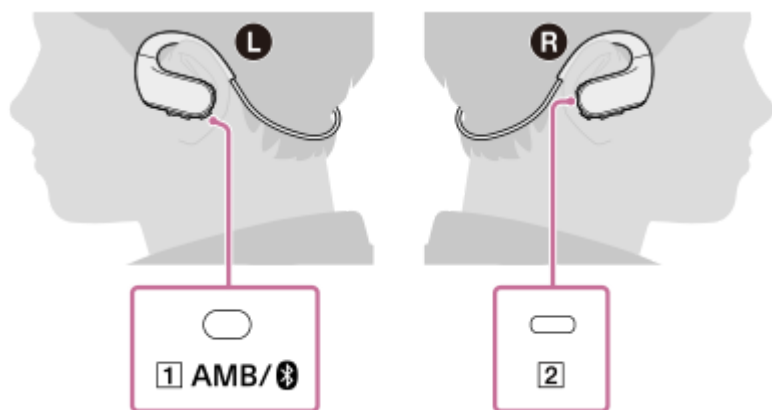

1 Make sure that the Walkman is turned on and the Bluetooth function is turned off.

If the Bluetooth function is turned on, hold down the button (1) for 2 seconds. The color of the lamp (2) will change.

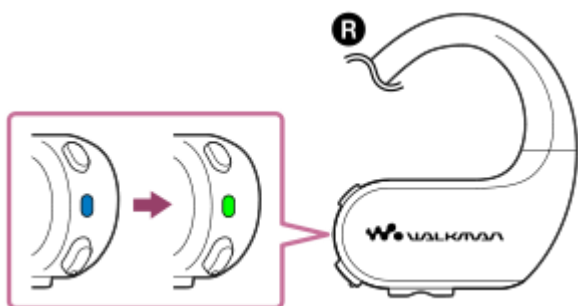

2 Hold down the button (1) for 7 seconds.

The lamp (2) will flash quickly and pairing will start.

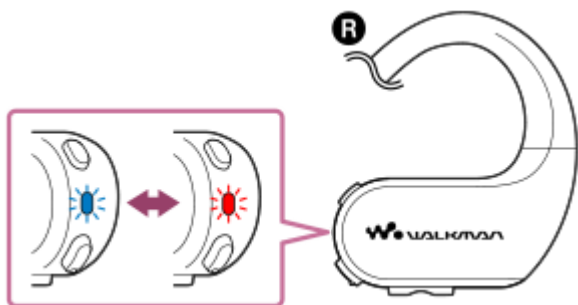

3 Turn on the Bluetooth function on the iPhone.



4 Tap the model name of the Walkman. ([NW-WS623] or [NW-WS625])



If passkey input is required, enter “0000”. A Passkey may be called a “Pass code,” a “PIN code,” a “PIN number,” or a “Password”.

Make sure that the Walkman and the iPhone are paired to each other. When the connection is established, the lamp (2) lights up.

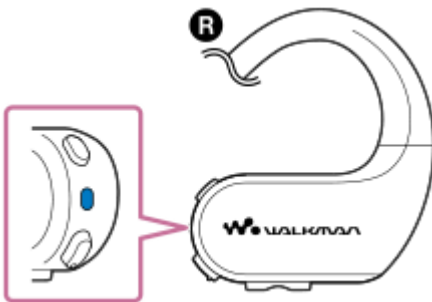

Note

- Once you have successfully completed pairing, you do not have to pair the devices again for future connections between them.
- The above procedure is an example. For details, refer to the operating manual for the iPhone.
- If you pair the Walkman and the iPhone while you are using the Remote Commander (NW-WS625 only), the Remote Commander may turn off. In this case, turn on the Remote Commander again.

The contents of the Help Guide may be subject to change without notice due to updates to the product's specifications.

Related Topic

- [Turning the Bluetooth function on or off](#)
- [Connecting the Walkman to a paired smartphone](#)

- Notes on the Bluetooth function
- Confirming the status from the OPR lamp

4-688-892-12(1) Copyright 2017 Sony Corporation

Connecting the Walkman to a paired smartphone

If you have paired the Walkman and a smartphone before, the Walkman is registered to the smartphone. You can connect the Walkman to the smartphone easily.

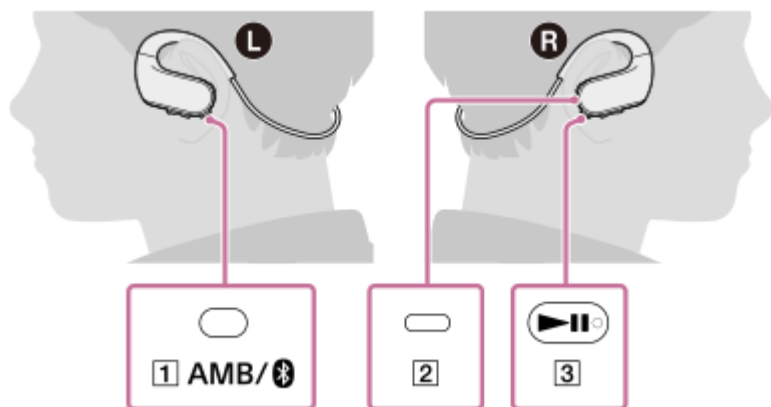

1 Turn on the Bluetooth function on the last connected smartphone.

2 Make sure that the Walkman is turned on.

3 Hold down the button (1) for 2 seconds to turn on the Bluetooth function.

If you turn off the Walkman while the Bluetooth function is active, the Bluetooth function will turn on automatically the next time you turn on the Walkman.

The Walkman will connect to the last connected smartphone. You will hear the voice guidance and the lamp (2) will light up.

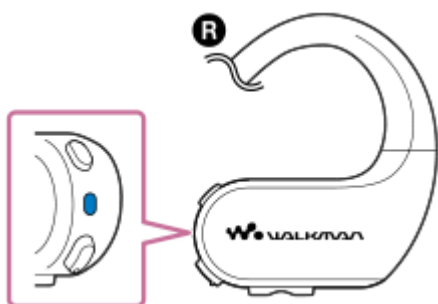

Hint

- When the Walkman connects to the smartphone, the model name of the Walkman appears on the screen of the smartphone. If the Walkman is not connected, tap the model name.
- To listen to music stored on the Walkman while the Walkman is connected to the smartphone, hold down the button (3) for 2 seconds to switch to the Walkman mode.
- If the connection fails, try the following.
 - Turn off the Bluetooth function on the Walkman, and then turn it on again.
 - Turn off the Bluetooth function on the smartphone, and then turn it on again.

The contents of the Help Guide may be subject to change without notice due to updates to the product's specifications.

Related Topic

- [Connecting the Walkman to an unpaired Android smartphone for the first time](#)
- [Connecting the Walkman to an unpaired iPhone for the first time](#)
- [One-touch connections with a smartphone \(NFC\)](#)
- [Notes on the Bluetooth function](#)
- [Confirming the status from the OPR lamp](#)
- [Selecting the Walkman or a smartphone as the sound source](#)

4-688-892-12(1) Copyright 2017 Sony Corporation

Turning the Bluetooth function on or off

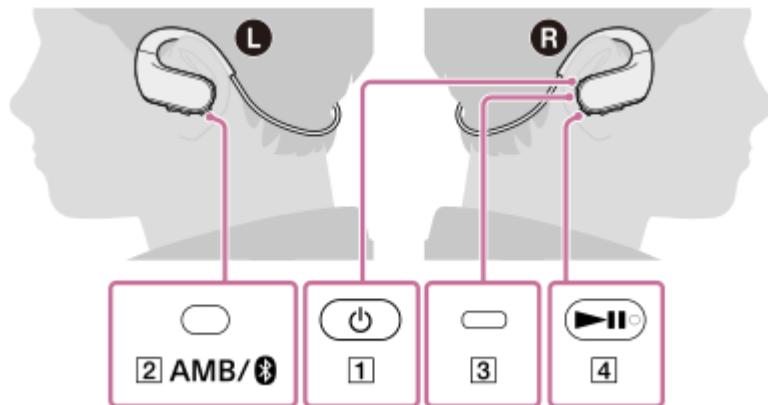

1 Hold down the button (1) for 3 seconds to turn on the Walkman.

2 Hold down the button (2) for 2 seconds to turn on the Bluetooth function.

The lamp (3) will flash. The Walkman will connect to the last connected Bluetooth device automatically, and then the lamp will light up.

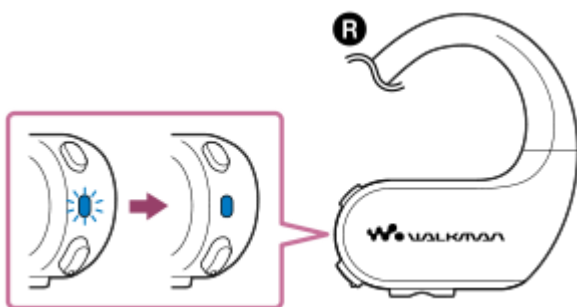

To turn off the Bluetooth function

Hold down the button (2) for 2 seconds again. The color of the lamp (3) will change.

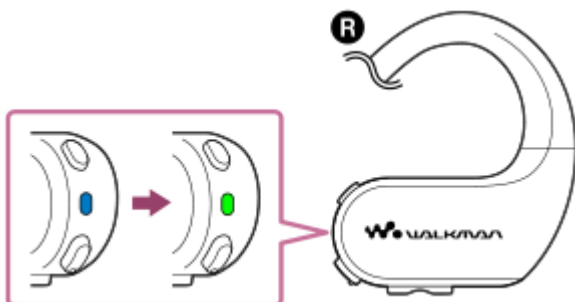

Hint

- The battery life becomes considerably shorter when the Bluetooth function is active.
- When you connect the Walkman to a Bluetooth device, the Walkman enters the Headphone mode automatically. To switch to the Walkman mode, hold down the button (4) for 2 seconds. When the Walkman enters the Walkman mode, the playback of music

on the Bluetooth device stops automatically.

- If you turn off the Walkman while the Bluetooth function is active, the Bluetooth function will turn on automatically the next time you turn on the Walkman.

The contents of the Help Guide may be subject to change without notice due to updates to the product's specifications.

Related Topic

- [One-touch connections with a smartphone \(NFC\)](#)
- [Connecting the Walkman to an unpaired Android smartphone for the first time](#)
- [Connecting the Walkman to an unpaired iPhone for the first time](#)
- [Connecting the Walkman to a paired smartphone](#)
- [Notes on the Bluetooth function](#)
- [Playing music on a smartphone](#)
- [Confirming the status from the OPR lamp](#)
- [Selecting the Walkman or a smartphone as the sound source](#)

Playing music on a smartphone

You can play music that is stored on a smartphone via a Bluetooth connection.

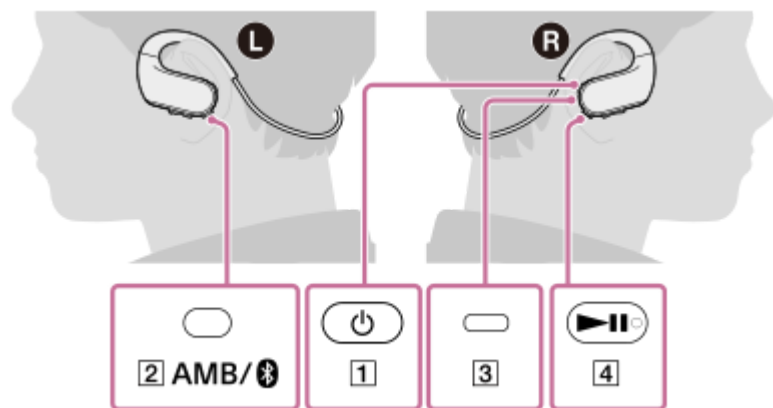

1 Hold down the button (1) for 3 seconds to turn on the Walkman.

2 Hold down the button (2) for 2 seconds to turn on the Bluetooth function.

The lamp (3) will flash. The Walkman will connect to the last connected smartphone automatically, and then the lamp will light up.

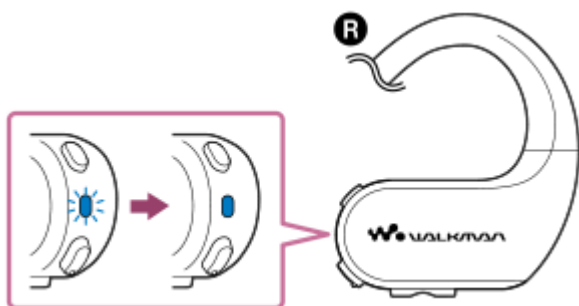

3 Press the button (4) to start playback.

Playback of music on the smartphone will start. To pause playback, press the button (4).

Hint

- To listen to music stored on the Walkman while the Walkman is connected to the smartphone, hold down the button (4) for 2 seconds to switch to the Walkman mode.
- You can perform playback operations (such as starting or pausing playback) using the Remote Commander (NW-WS625 only).
- If you turn off the Walkman while the Bluetooth function is active, the Bluetooth function will turn on automatically the next time you turn on the Walkman.
- If the voice guidance is too loud for playing back music, try the following.
 - Turn down the volume on the Walkman and then turn up the volume on the smartphone.

Note

- Depending on the smartphone that you are using, you may not be able to play the music with the Walkman. In this case, play the music by operating the smartphone.
- When the Walkman is in the Headphone mode, you cannot perform the following operations.
 - Skipping to the previous or next unit (folder/playlist/album).
 - Changing the playback mode (Repeat/Shuffle).
 - Changing the playback range (folder/playlist/album).

The contents of the Help Guide may be subject to change without notice due to updates to the product's specifications.

Related Topic

- [One-touch connections with a smartphone \(NFC\)](#)
- [Connecting the Walkman to an unpaired Android smartphone for the first time](#)
- [Connecting the Walkman to an unpaired iPhone for the first time](#)
- [Connecting the Walkman to a paired smartphone](#)
- [Selecting the wireless playback quality](#)
- [Notes on the Bluetooth function](#)
- [Confirming the status from the OPR lamp](#)
- [Selecting the Walkman or a smartphone as the sound source](#)
- [Using the Remote Commander](#)

4-688-892-12(1) Copyright 2017 Sony Corporation

Digital Music Player
NW-WS623/WS625

Selecting the Walkman or a smartphone as the sound source

When the Walkman is connected to a smartphone, you can select one of the following sound sources.

- **Walkman mode**

- You can listen to music on the Walkman.
- While you are listening to music on the Walkman, you can answer a call to the smartphone.

- **Headphone mode**

- You can listen to music on a smartphone with the Walkman.
- You can answer or hang up a call from a smartphone.

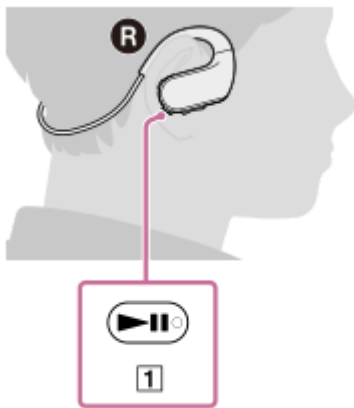

1 Hold down the button (1) for 2 seconds while the Bluetooth function is active.

Each time you hold down the button (1), the mode toggles.

Hint

- When you connect the Walkman to a Bluetooth device, the Walkman enters the Headphone mode automatically. When you change the sound source from a smartphone to the Walkman, playback on the smartphone stops automatically.
- If you turn off the Walkman while the Bluetooth function is active, the Bluetooth function will turn on automatically the next time you turn on the Walkman.

The contents of the Help Guide may be subject to change without notice due to updates to the product's specifications.

Selecting the wireless playback quality

You can choose whether to prioritize the sound quality or the stability of the connection.

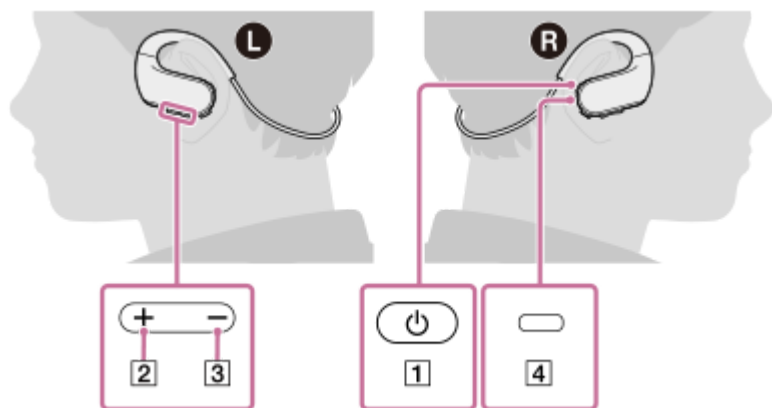

1 Hold down the button (1) for 3 seconds to turn off the Walkman.

2 Hold down the button (1) for 3 seconds while you hold down the button (2 or 3).

The Walkman will turn on. Then, the lamp (4) will flash and the wireless playback quality will change. As the wireless playback quality setting changes, the lamp (4) flashes differently according to the current setting. For details, see the table described below.

- If you hold down the button (2), the setting will change in the following order.
Prioritize connection – Standard – Prioritize sound quality
The setting will not change if Prioritize sound quality is selected.
- If you hold down the button (3), the setting will change in the following order.
Prioritize sound quality – Standard – Prioritize connection
The setting will not change if Prioritize connection is selected.

3 Repeat the above steps until the Walkman is set to the desired setting.

Description of the 3 settings

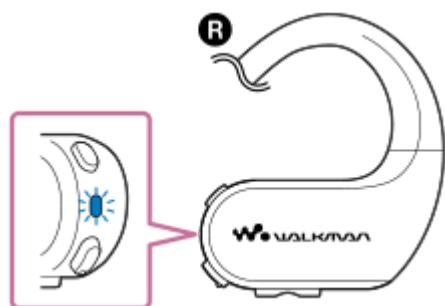

Setting	Description	Flashing pattern of the lamp (4)

Setting	Description	Flashing pattern of the lamp ([4])
Prioritize connection (default setting)	This setting stabilizes the wireless connection. However, the sound quality may be lower than with other settings. Use this setting if the connection is unstable. (SBC)	The lamp flashes once.
Standard	This setting stabilizes both the connection and the sound quality. (SBC)	The lamp flashes twice.
Prioritize sound quality	This setting transmits sound in high quality. However, the connection may become unstable. (AAC/SBC)	The lamp flashes 3 times.

Hint

- Select Prioritize sound quality to play tracks with the AAC Codec.

Note

- Changing the wireless playback quality setting may not have any effect depending on the smartphone settings.

The contents of the Help Guide may be subject to change without notice due to updates to the product's specifications.

Related Topic

- [Turning the Bluetooth function on or off](#)
- [Playing music on a smartphone](#)

Notes on the Bluetooth function

- To optimize Bluetooth communications, observe the following.
 - Place the Walkman and the Bluetooth device as close together as possible. The Bluetooth standard supports distances of up to 10 meters (32.8 feet).
 - Turn the built-in Bluetooth antenna (aerial) in the direction of the connected Bluetooth device.
 - Do not block the antenna (aerial) with a metal object.
 - Do not block the antenna (aerial) with a body part such as a hand.
 - Do not block the antenna (aerial) by placing the Walkman or the Remote Commander (NW-WS625 only) inside a backpack or shoulder bag.
 - Do not block the antenna (aerial) by using the Walkman or the Remote Commander (NW-WS625 only) in a crowded place.
 - Avoid areas where electromagnetic waves are emitted. For example, near microwave ovens, mobile phones, mobile gaming devices, or wireless LAN environments.
- Due to a characteristic of Bluetooth wireless technology, the sound may lag slightly.
- Bluetooth radiation may affect the operation of electronic medical devices. Turn off the Walkman or the Remote Commander (NW-WS625 only) and other Bluetooth devices in the following locations.
 - in hospitals
 - near priority seats on trains
 - on airplanes
 - in places where flammable gases are present (gas stations, etc.)
 - near automatic doors
 - near fire alarms
- The Walkman supports security functions that comply with the Bluetooth standard. Sony bears no responsibility whatsoever for information leaks that occur as a result of your Bluetooth connection.
- Even if a Bluetooth device conforms to the standard, all connections and correct operations are not guaranteed.
- Depending on the Bluetooth device, it may take some time to establish a Bluetooth connection.

The contents of the Help Guide may be subject to change without notice due to updates to the product's specifications.

Related Topic

- [Parts and controls](#)

Digital Music Player
NW-WS623/WS625

Notes on playing music from a smartphone

- Due to the characteristics of Bluetooth technology, the radio waves may be blocked by your body. Therefore, the sound from the smartphone may be interrupted.
- There is a built-in Bluetooth antenna on the right side of the Walkman. If the sound is interrupted, try the following:
 - Carry the smartphone on the right side or front side of your body.
 - Rotate the smartphone.

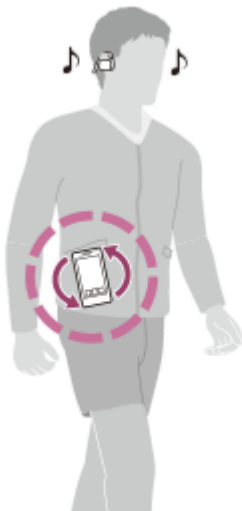
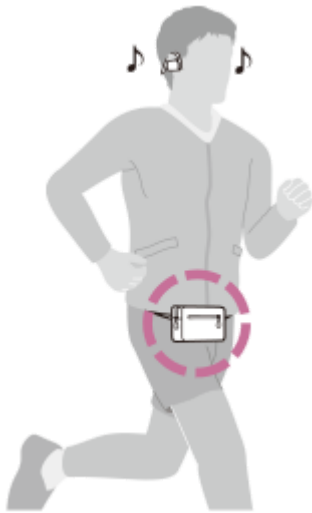

Note

- For details on how to attach the smartphone to your body, refer to the operating manual for the smartphone.

Digital Music Player
NW-WS623/WS625

Answering a call / hanging up a call

You can answer a call to your smartphone. You need to establish a Bluetooth connection between the Walkman and the smartphone in advance.

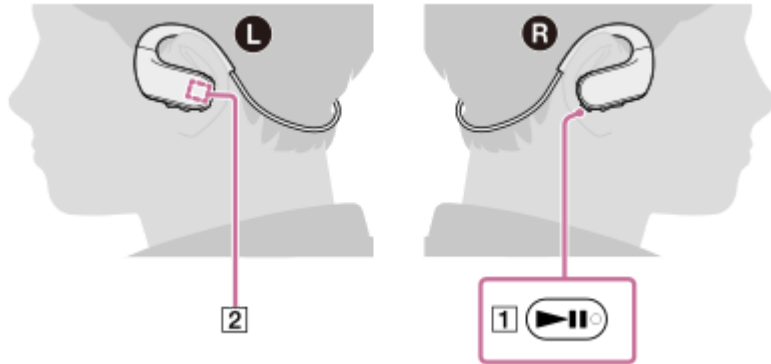

- 1 Press the button (1) to answer a call.
- 2 Press the button (1) to hang up the call.

Hint

- You can answer or hang up a call by pressing the  button on the Remote Commander (NW-WS625 only).
- While you are talking on a phone, Ambient Sound Mode is turned off. When you hang up the call, Ambient Sound Mode will automatically turn back on.

Note

- Do not cover the microphone part (2) with your hands or other objects when you talk into the Walkman.

The contents of the Help Guide may be subject to change without notice due to updates to the product's specifications.

Related Topic

- [Connecting the Walkman to an unpaired Android smartphone for the first time](#)
- [Connecting the Walkman to an unpaired iPhone for the first time](#)
- [Connecting the Walkman to a paired smartphone](#)
- [One-touch connections with a smartphone \(NFC\)](#)
- [Notes on the volume for calls on smartphones](#)
- [Rejecting a call](#)

Digital Music Player
NW-WS623/WS625

Rejecting a call

When the Walkman is connected to a smartphone, you can reject a call using the Walkman.

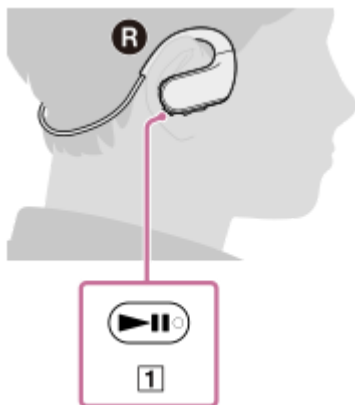

- 1 Hold down the button (1) for 2 seconds when you receive a call.

Hint

- You can reject the call by holding down the  button on the Remote Commander (NW-WS625 only) for 2 seconds.

The contents of the Help Guide may be subject to change without notice due to updates to the product's specifications.

Related Topic

- [Answering a call / hanging up a call](#)

Digital Music Player
NW-WS623/WS625

Notes on the volume for calls on smartphones

The volume for music and the volume for calls are independent of each other. You can adjust the volume for calls while you are talking on the phone. When you hang up the call, the volume returns to the level for music. If the AVLS function is active, the Walkman will keep the volume for calls at a moderate level.

The contents of the Help Guide may be subject to change without notice due to updates to the product's specifications.

Related Topic

- [Answering a call / hanging up a call](#)
- [Limiting the volume](#)

Digital Music Player
NW-WS623/WS625

What is Ambient Sound Mode?

Ambient Sound Mode uses the microphones built into the left and right sides of your Walkman to allow you to hear ambient sound even while wearing headphones. Pay attention to the sounds around you to enjoy listening to music safely.

Note

- Ambient Sound Mode allows you to hear ambient sound even while wearing headphones. However, note that this mode does not enable you to hear all sounds around you. Ambient sound may not be heard well depending on the surrounding environment, type of the music being played on your Walkman, or the volume level. Be very careful when using the Walkman in places where an inability to hear ambient sound would be dangerous (such as on roads where there is car or bicycle traffic).
- Ambient Sound Mode may not function properly if you use your Walkman with earbuds that do not fit your ears. Use earbuds of an appropriate size to fit your ears comfortably and snugly.

The contents of the Help Guide may be subject to change without notice due to updates to the product's specifications.

Related Topic

- [Using Ambient Sound Mode](#)

Using Ambient Sound Mode

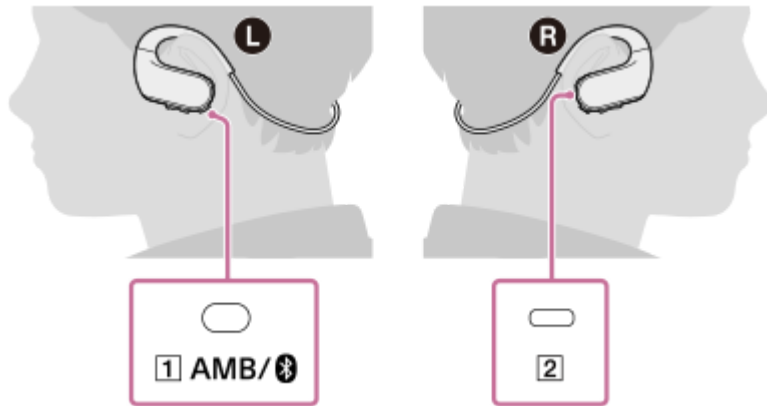

- 1 Press the button (1) to turn on Ambient Sound Mode.

You will hear a beeping sound. The lamp (2) will flash twice. Ambient Sound Mode will turn on.

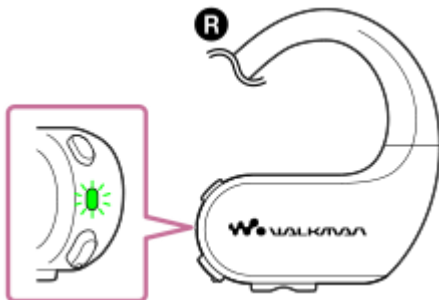

To turn off Ambient Sound Mode

1. Press the button (1).
You will hear a beeping sound. The lamp (2) will flash twice.

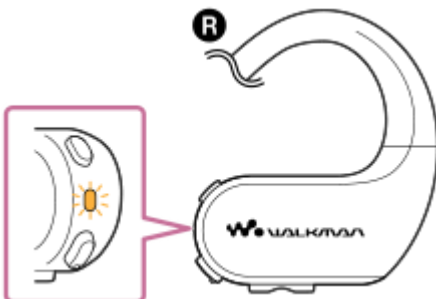

To select another Ambient Sound Mode

1. Press the button (1) to turn on Ambient Sound Mode.
2. Double-click the button (1) repeatedly to select the appropriate mode.
The loudness of ambient sounds will change accordingly. Each time you double-click the button (1), you will hear the voice guidance and Ambient Sound Mode will change in the following order.

[Mode A] (soft) – [Mode B] (standard) – [Mode C] (loud) – [Mode A] (soft)...
To switch to the next mode, wait until the voice guidance ends.

Note

- Even if you turn off the Walkman, the selected mode will be stored.
- When you talk on a smartphone, Ambient Sound Mode does not function.
- You may not hear well the ambient sound when you use Swimming Earbuds. In this case, switch to the standard-type earbuds.
- The ambient sound cannot be heard well after you use the Walkman in a pool or the ocean. Pat the parts around the buttons softly against a dry cloth about 30 times. Then, leave the Walkman on a dry cloth at room temperature for 2 to 3 hours. Make sure that the Walkman is completely dry before the next use.

The contents of the Help Guide may be subject to change without notice due to updates to the product's specifications.

Related Topic

- [What is Ambient Sound Mode?](#)

4-688-892-12(1) Copyright 2017 Sony Corporation

Digital Music Player
NW-WS623/WS625

Parts and controls (Remote Commander)

(Only for models supplied with the Remote Commander)

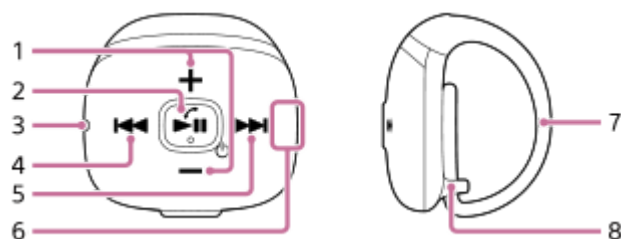

1. +/- (volume) buttons

Press the buttons to adjust the volume for music playback or a call.

2. ◀/▶/⏻ button (*1)

- Hold down the button for 2 seconds to turn on the Remote Commander.
- Press the button to start or pause playback.
- Press the button to answer or hang up a call while the Walkman is connected to a smartphone.
- Hold down the button for 2 seconds to reject a call.
- Hold down the button for 2 seconds to switch the sound source (the Walkman or the smartphone).

3. Lamp (blue/red)

- The lamp has various colors and flashing patterns. The lamp indicates the following.
 - The Remote Commander is turned on.
 - The battery of the Remote Commander is low.
 - The Remote Commander is connected to the Walkman.
 - The Remote Commander is pairing with the Walkman.
- When you press any button, the lamp lights up. If the lamp does not light up, the following causes are possible.
 - The Remote Commander is turned off.
 - The Remote Commander is not connected to the Walkman.
 - The battery is depleted.

4. ◀◀ (previous) button

- Press the button to jump back within the current track or to the previous track.
- Hold down the button to fast-rewind playback.
- Double-click the button to go back to the first track of the current folder or album.
- Double-click the button again to jump back to the first track of the previous folder or album.

5. ▶▶ (next) button

- Press the button to skip to the next track.
- Hold down the button to fast-forward playback.
- Double-click the button to skip to the first track of the next folder or album.

6. Built-in antenna (aerial)

Do not cover the antenna while the Remote Commander is connected to the Walkman. Otherwise, the connection may be interrupted.

7. Band

8. Band loop

*1 There is a tactile dot. The tactile dots can help you operate the buttons without looking at them.

The contents of the Help Guide may be subject to change without notice due to updates to the product's specifications.

4-688-892-12(1) Copyright 2017 Sony Corporation

Digital Music Player
NW-WS623/WS625

Using the Remote Commander

(Only for models supplied with the Remote Commander)

The Remote Commander allows you to operate the Walkman wirelessly. The Remote Commander and the Walkman are already paired as a default. Therefore, you can use the Walkman and the Remote Commander immediately after you turn them on.

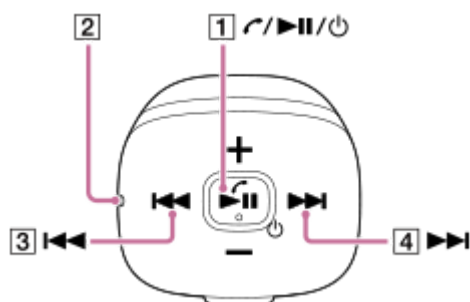

1 Attach the Remote Commander to your finger.

Adjust the band to fit the size of your finger.



2 Make sure that the Walkman is turned on.

3 Hold down the button (1) for 2 seconds.

The Remote Commander will turn on. The lamp (2) will start flashing.

The Remote Commander will connect to the Walkman automatically. Then, the lamp (2) will turn off.

Press any button on the Remote Commander to check the connection. The lamp (2) will light up if the Walkman and the Remote Commander are connected.

4 Press the desired button to operate the Walkman.

Hint

- You can use the Remote Commander even if the Bluetooth function of the Walkman is turned off.
- You can use the Remote Commander while there is an active Bluetooth connection between the Walkman and a smartphone.
- When you turn off the Walkman, the Remote Commander turns off.
- If you do not operate the Remote Commander for 2 hours, the Remote Commander will turn off automatically.
- If the remaining battery level is low, the lamp (2) will change to red.

- To delete the pairing information, hold down the buttons (**3**) and (**4**) for 10 seconds.

Note

- You cannot turn on or turn off the Walkman using the Remote Commander.
- If the Remote Commander does not have pairing information, it will enter the pairing mode automatically when you turn it on.
- You cannot use the Remote Commander in a swimming pool.
- If you replace the battery of the Remote Commander, the pairing information will be deleted. In this case, pair the Walkman and the Remote Commander again.

The contents of the Help Guide may be subject to change without notice due to updates to the product's specifications.

Related Topic

- [Parts and controls \(Remote Commander\)](#)
- [Notes on using the Remote Commander](#)
- [Pairing the Walkman with the Remote Commander](#)

4-688-892-12(1) Copyright 2017 Sony Corporation

Digital Music Player
NW-WS623/WS625

Pairing the Walkman with the Remote Commander

(Only for models supplied with the Remote Commander)

You can connect an unpaired Remote Commander to the Walkman using the Bluetooth function.

Pairing is necessary in the following cases:

- You reset the Walkman to the factory settings and the pairing information was deleted from the Walkman.
- You reset the Remote Commander.
When you hold down both the ◀◀ button and the ▶▶ button together for 10 seconds, the Remote Commander resets.
- You replaced the battery of the Remote Commander.

Once you have paired the Remote Commander and the Walkman, you can easily connect them in the future.

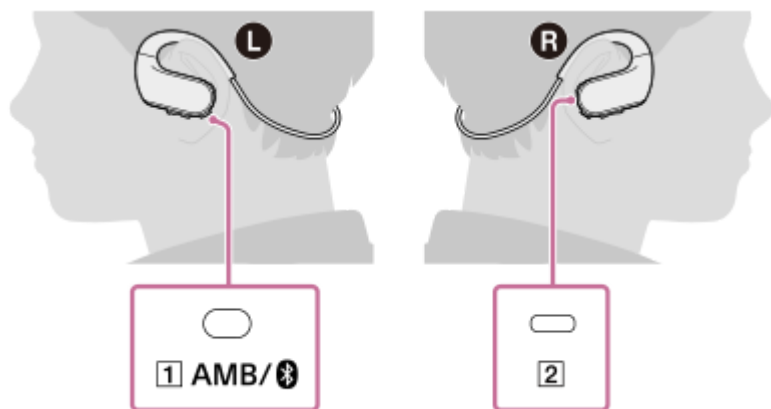

1 Turn on the unpaired Remote Commander.

The lamp on the Remote Commander will start flashing in red and blue alternately.

2 On the Walkman, make sure that the Bluetooth function is turned off.

If the Bluetooth function is turned on, hold down the button (1) for 2 seconds.

3 Hold down the button (1) for 7 seconds.

The lamp (2) will flash quickly and pairing will start.

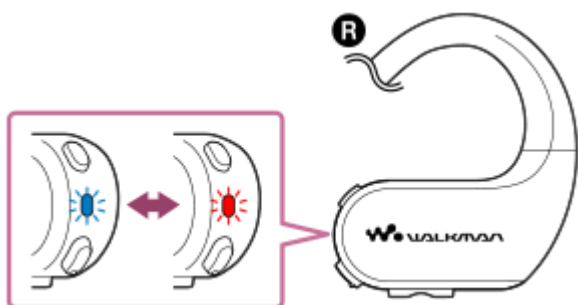

When the connection is established, the lamp on the Remote Commander stops flashing.

Hint

- To delete the pairing information for the Remote Commander, reset the Walkman.

Note

- If the pairing times out before it is finished, perform the procedure again.

The contents of the Help Guide may be subject to change without notice due to updates to the product's specifications.

Related Topic

- [Turning the Bluetooth function on or off](#)
- [Using the Remote Commander](#)
- [Replacing the battery of the Remote Commander](#)
- [Resetting the Walkman to the factory settings](#)

4-688-892-12(1) Copyright 2017 Sony Corporation

Digital Music Player
NW-WS623/WS625

Replacing the battery of the Remote Commander

(Only for models supplied with the Remote Commander)

Replace the battery of the Remote Commander when the lamp lights up in red. Use a CR1620 Lithium Coin Cell Battery only.

When you open the battery cover, the water-resistant performance may be impaired by dust, etc. To maintain the water-resistant performance, consult your nearest Sony dealer or Sony Service Center for replacement of the battery (at an additional cost).

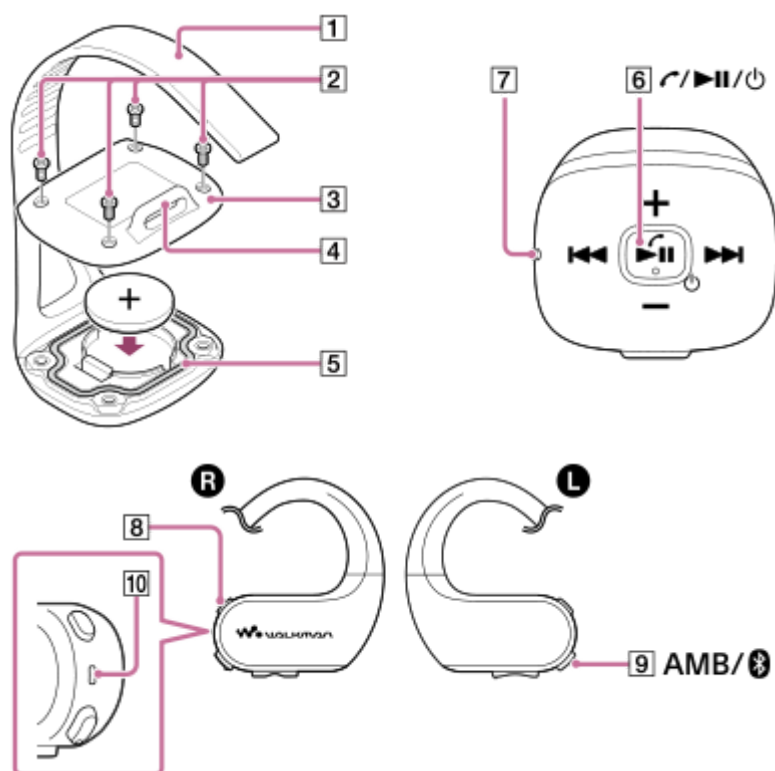

- 1 Make sure that the Remote Commander is turned off. Remove the band (1) from the loop (4).
- 2 Remove the 4 screws (2) using a Size 0 cross-head precision screwdriver.
- 3 Open the cover (3) and remove the battery. Then, insert a new CR1620 battery with correct polarity.
- 4 Check that the packing (5) is in place and is clean.
- 5 Put the cover (3) back into place and tighten the screws (2) firmly to the end.
Do not overtighten the screws (2).
- 6 Reattach the band (1) back through the loop (4).
- 7 Hold down the button (6) for 2 seconds.
The lamp (7) will flash. The Remote Commander will turn on.

- 8 Hold down the button (8) for 3 seconds to turn on the Walkman.
- 9 Hold down the button (9) for 2 seconds to turn off the Bluetooth function.
- 10 On the Walkman, hold down the button (9) for 7 seconds.

The lamp (10) will flash quickly and pairing will start.

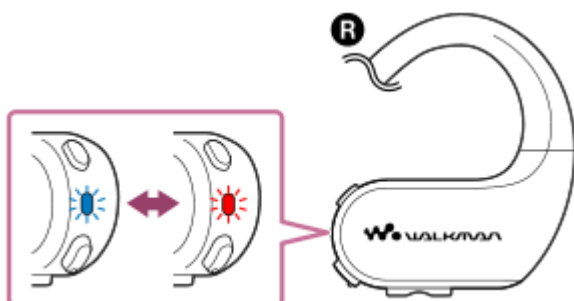

When the connection is established, the lamp on the Remote Commander stops flashing.

Note

- Do not lose the cover (3), screws (2) and packing (5).
- The battery supplied at the time of purchase may have a shorter battery life as it is installed at the factory to check the performance.

The contents of the Help Guide may be subject to change without notice due to updates to the product's specifications.

Related Topic

- [Turning the Walkman on or off](#)
- [Turning the Bluetooth function on or off](#)
- [Pairing the Walkman with the Remote Commander](#)

Notes on using the Remote Commander

(Only for models supplied with the Remote Commander)

- The water resistance specifications of the Remote Commander are equivalent to IEC 60529 “Degrees of protection against ingress of water (IP Code)” IPX5(*1), and the dust proofing specifications of Remote Commander are equivalent to IEC 60529 “Degrees of protection against solid foreign objects” IP6X(*2).
- Radio waves do not transmit through water. You cannot use the Remote Commander in a swimming pool.
- You cannot use the Remote Commander when it is wet.
- The antenna (aerial) is built into the Remote Commander.
- The Remote Commander may become inoperable when you use it under the following conditions.
 - In areas with a wireless LAN.
 - Near devices (microwave ovens, mobile phones, mobile gaming devices, etc.) with an active communication function.
 - In areas where electromagnetic waves are emitted.
 - In situations where people may block the built-in antenna (aerial) in the Remote Commander (such as on a crowded train).
 - When you cover the built-in antenna (aerial) with your hand.
- Wash the Remote Commander in lukewarm water if tanning oil or sunscreen adheres to the Remote Commander. These substances may cause damage to the Remote Commander, such as discoloration or cracks.
- Do not tighten the band of the Remote Commander excessively. Otherwise, your finger may get a rash from sweating with poor ventilation.
- The band of the Remote Commander may deteriorate due to long-term use or storage.

*1 IPX5 (Degrees of protection against jets of water): The Remote Commander has been tested under and maintains its operability under the following test conditions: When exposed to direct streams of water from any direction where approximately 12.5 l/min. of water is supplied for more than 3 minutes from a distance of approximately 3 m using a nozzle with an inner diameter of 6.3 mm.

*2 IP6X (Degrees of protection against dust): The Remote Commander has been tested to and continues to block dust after stirring for 8 hours in a testing device which contains dust particles that are up to 75 µm in diameter.

The contents of the Help Guide may be subject to change without notice due to updates to the product's specifications.

Digital Music Player
NW-WS623/WS625

Limiting the volume

The AVLS (Automatic Volume Limiter System) function reduces the risk of damage to ears from loud volumes. The AVLS function limits the maximum volume. AVLS has the following features.

- AVLS limits the volume to a certain level.
- AVLS prevents disturbances to others caused by loud volumes.
- AVLS allows you to listen at a more comfortable volume.

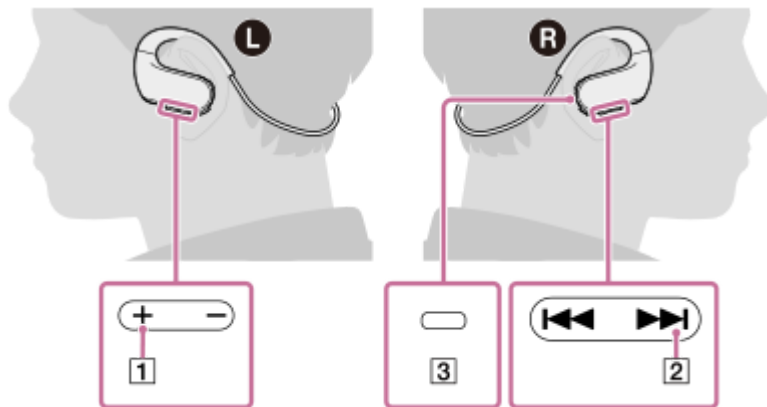

1 Pause playback.

2 While you hold down the button (1), hold down the button (2) for 5 seconds.

The lamp (3) will flash twice and the AVLS function will turn on. The Walkman will now keep the volume at a moderate level.

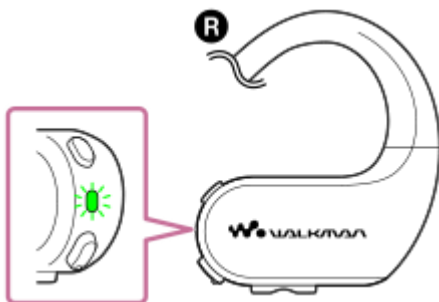

To turn off the AVLS function

While you hold down the button (1), hold down the button (2) for 5 seconds.

The lamp (3) will flash twice.

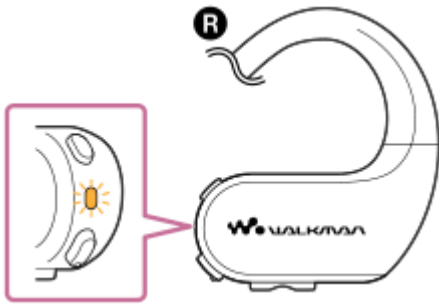

Note

- When the Walkman is in the Headphone mode, you cannot turn on the AVLS function.

The contents of the Help Guide may be subject to change without notice due to updates to the product's specifications.

Related Topic

- [Adjusting the volume](#)

4-688-892-12(1) Copyright 2017 Sony Corporation

Moderating the differences in volume level between tracks

You can moderate the change in volume between tracks to minimize differences in volume level (Dynamic Normalizer).

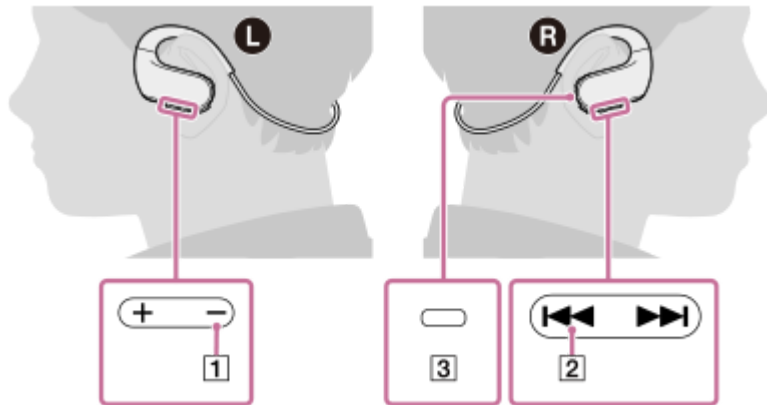

- 1 Pause playback.
- 2 While you hold down the button (1), hold down the button (2) for 5 seconds.
The lamp (3) will flash twice and the Dynamic Normalizer function will turn on.

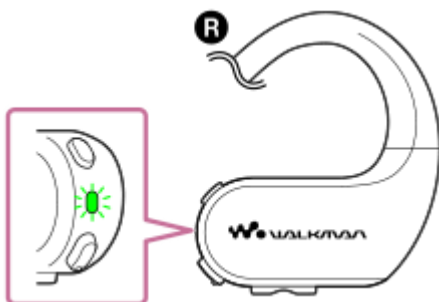

To turn off the Dynamic Normalizer function

While you hold down the button (1), hold down the button (2) for 5 seconds.
The lamp (3) will flash twice.

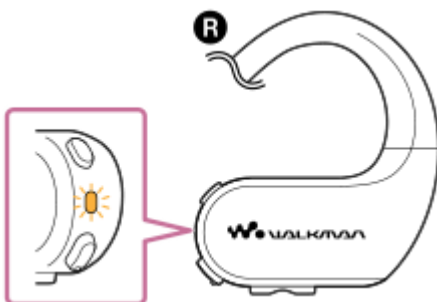

Note

- When the Walkman is in the Headphone mode, you cannot turn on the Dynamic Normalizer function.

The contents of the Help Guide may be subject to change without notice due to updates to the product's specifications.

4-688-892-12(1) Copyright 2017 Sony Corporation

Digital Music Player
NW-WS623/WS625

Restarting the Walkman

Restart the Walkman if operations become unstable or the Walkman freezes. Restarting will not delete any data and pairing information. However, perform the following before you restart the Walkman. Otherwise, the data on the Walkman may be damaged.

- Disconnect the Walkman from the computer.
- Stop playback.

1 Hold down the button (1) for 10 seconds until the Walkman restarts.

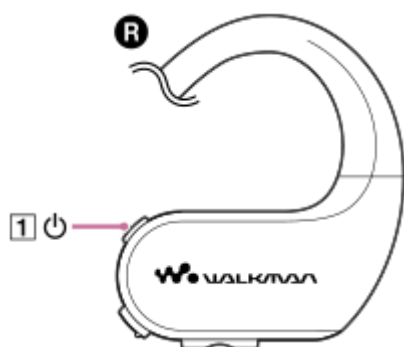

The contents of the Help Guide may be subject to change without notice due to updates to the product's specifications.

Related Topic

- [Resetting the Walkman to the factory settings](#)
- [Formatting the Walkman memory](#)

Digital Music Player
NW-WS623/WS625

Resetting the Walkman to the factory settings

This operation resets all setting parameters to the default settings.

If you reset the Walkman, pairing information for the Remote Commander (NW-WS625 only) and other Bluetooth devices will be deleted.

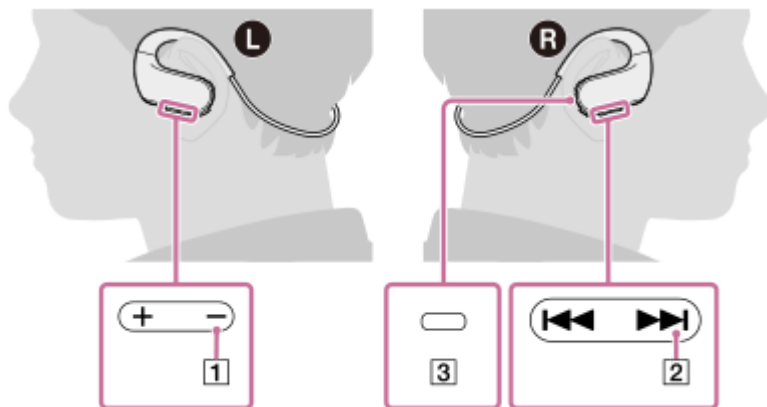

- 1 **Pause playback.**
- 2 **Make sure that the Bluetooth function is turned off.**
- 3 **While you hold down the button (1), hold down the button (2) for 15 seconds.**

The lamp (3) will flash twice. Resetting is now complete.

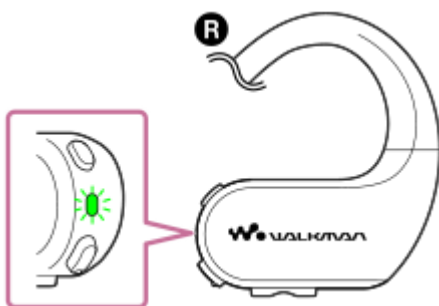

Note

- When the Bluetooth connection is active, you cannot reset the Walkman.

The contents of the Help Guide may be subject to change without notice due to updates to the product's specifications.

- [Restarting the Walkman](#)
- [Formatting the Walkman memory](#)
- [Pairing the Walkman with the Remote Commander](#)

4-688-892-12(1) Copyright 2017 Sony Corporation

Digital Music Player
NW-WS623/WS625

Formatting the Walkman memory

This operation deletes all data (including sample data and the supplied software installer) that is stored on the Walkman. Before you format the internal memory of the Walkman, save a backup copy of important data.

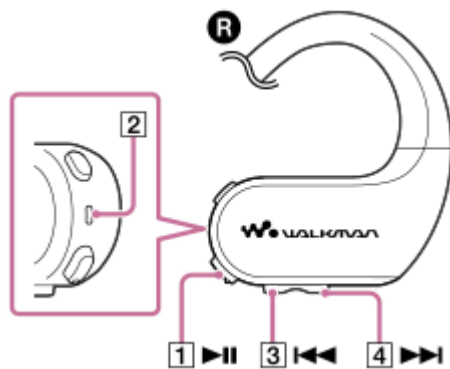

- 1 Pause playback.
- 2 Make sure that the Bluetooth function is turned off.
- 3 Hold down the button (1) for 15 seconds.

The lamp (2) will flash quickly.

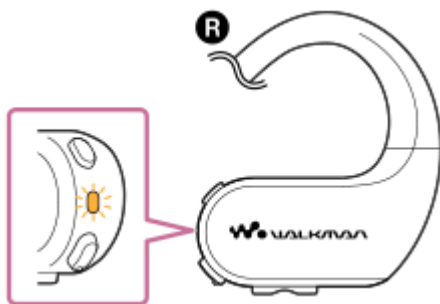

- 4 Release the button (1).

The lamp (2) will light up.

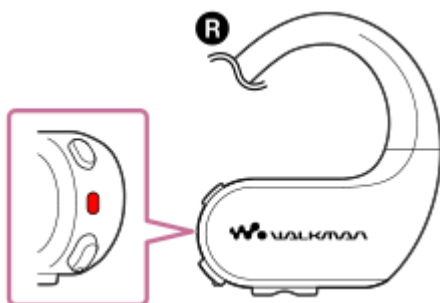

- 5 Press the button (3 or 4) within 30 seconds after the lamp (2) lights up in red.

The color of the lamp (2) will change to green.
If you do not press the button within 30 seconds, formatting will be canceled.

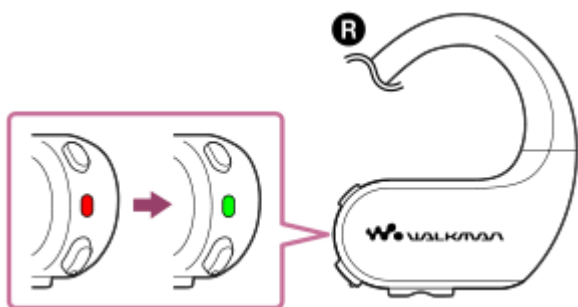

6 Press the button (1) while the lamp (2) is lit.

The lamp (2) will flash quickly and formatting will start. When formatting is complete, the lamp (2) turns off.

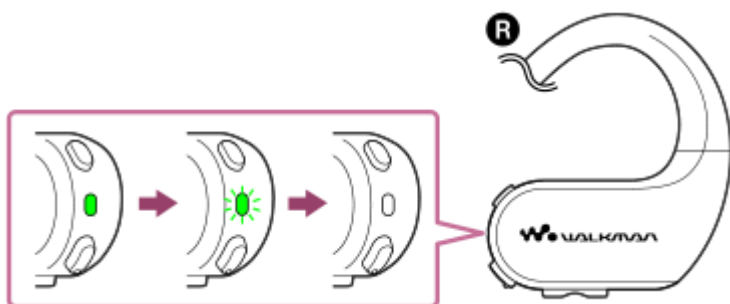

Note

- When the Bluetooth connection is active, you cannot format the memory of the Walkman.
- Sony does not guarantee performance if you format the memory of the Walkman using a computer.
- Even if you format the memory, pairing information will remain.

The contents of the Help Guide may be subject to change without notice due to updates to the product's specifications.

Related Topic

- [Restarting the Walkman](#)
- [Resetting the Walkman to the factory settings](#)

Digital Music Player
NW-WS623/WS625

Checking information on the Walkman

When the Walkman is connected to a computer, you can check the system software version of the Walkman. Open "Information.txt" in the [WALKMAN] folder on the computer. You can check the following information.

01: Model name

02: System software version

The contents of the Help Guide may be subject to change without notice due to updates to the product's specifications.

Related Topic

- [Updating the Walkman system software](#)

Digital Music Player
NW-WS623/WS625

Updating the Walkman system software

You can update the software of the Walkman.
You will receive update notices by the following methods.

- From Music Center for PC (You will receive update notices automatically.)
- From the customer support website (Access the site manually to receive update notices.)

Access the customer support website to get the latest information.
The following procedure describes how to update the software from the customer support website.
For details on how to install the program, refer to the customer support website.

- 1 Download the update program to a computer from the website.**
- 2 Connect the Walkman to the computer.**
- 3 Launch the update program.**
- 4 Follow the onscreen instructions.**

Hint

- To check the version information for the Walkman, connect the Walkman to a computer. Then, open "Information.txt" in the [WALKMAN] folder on the computer. You can check the following information.
 - 01: Model name
 - 02: System software version

The contents of the Help Guide may be subject to change without notice due to updates to the product's specifications.

Related Topic

- [Customer support website](#)
- [Restarting the Walkman](#)
- [Resetting the Walkman to the factory settings](#)
- [Formatting the Walkman memory](#)
- [Checking information on the Walkman](#)

Digital Music Player
NW-WS623/WS625

Notes on handling the Walkman

Read the notes below and follow the instructions to use the Walkman safely.

- Consult a doctor if you become injured or burned from using the product.
- Contact the nearest Sony dealer or Sony Service Center if the Walkman does not operate properly.
- Observe the following precautions. Otherwise, an explosion, fire, electric shock, burns, or injury may result.
 - Do not expose the Walkman to fire.
 - Do not allow metallic objects to get inside the Walkman.
 - Do not short-circuit the terminals of the Walkman with metallic objects.
 - Do not take apart or modify the Walkman.
 - Do not use the Walkman when you see lightning or hear thunder.
 - Do not use the Walkman if it causes an uncomfortable reaction on your skin.
- Observe the following precautions. Otherwise, you may damage the casing or cause the Walkman to malfunction.
 - Do not place the Walkman in direct sunlight.
 - Do not place the Walkman in locations where the temperature is extremely high.
 - Do not leave the Walkman in direct sunlight. Do not leave the Walkman in a car with all the windows closed, especially during the summer.



- Do not place the Walkman in locations where it is exposed to vibration.
- Do not drop the Walkman from heights.
- Do not apply a strong force or shock to the Walkman.
- Do not place the Walkman in locations where there is magnetization. For example, do not place the Walkman near a magnet, speakers, or a TV.
- Do not turn on the Walkman right after you move it from a cold environment to a warm environment.
- Do not use the Walkman in damp and hot locations where the temperature exceeds 45 °C (113 °F) (for example, in a sauna).
- Do not place the Walkman on an unstable surface or in an inclined position.
- Do not sit down when the Walkman is inserted in your pocket.



- Do not use the Walkman in locations where it is exposed to excessive dust.
 - Wash the Walkman in lukewarm water if tanning oil or sunscreen adheres to the Walkman. These substances may cause damage to the Walkman, such as discoloration or cracks.
 - The earbuds or the adjustment band may deteriorate due to long-term use or storage.
 - The waterproofing is not effective against certain liquids (soapy water, water containing detergent or bath additives, shampoo, hot-spring water, etc.).
- Comply with announcements regarding the use of electronic devices when you are on an airplane.
 - Heat may build up in the Walkman in the following situations, but this is not a malfunction. However, be careful because there is a risk of low-temperature burns.
 - While the battery is charging.

- While the Walkman is playing for an extended period of time.
- Content that you record is for personal use only. Under copyright law, the content cannot be used without the permission of the copyright holder.

The contents of the Help Guide may be subject to change without notice due to updates to the product's specifications.

4-688-892-12(1) Copyright 2017 Sony Corporation

Digital Music Player
NW-WS623/WS625

Notes on the headphones

Road safety

Do not use headphones in the following situations.

- While you are driving a car or riding a motorcycle or bicycle.
- Places where impaired hearing is dangerous. For example, on train platforms, in areas where there is vehicle traffic, or near construction sites.

Preventing hearing damage

Observe the following to protect your hearing.

- Keep the volume at a moderate level. Do not listen to audio content at high volumes for an extended period of time.
- Do not turn up the volume suddenly.

About the in-ear headphones

- When you use in-ear headphones with a high degree of adhesion, note the following. Otherwise, you may damage your ears or eardrums.
 - Do not insert the earbuds forcefully into your ears.
 - Do not remove the earbuds from your ears suddenly. When you take off the headphones, move the earbuds up and down gently.
- Do not sleep while you are wearing headphones.

Consideration for others

Avoid using the Walkman in environments where sound leakage will disturb others.

The contents of the Help Guide may be subject to change without notice due to updates to the product's specifications.

Digital Music Player
NW-WS623/WS625

Notes on the built-in battery

Do not touch the rechargeable battery with your bare hands if the battery is leaking. The battery liquid may cause burns or blindness. If the liquid contacts your body or clothes, wash the liquid off immediately with clean water.

The contents of the Help Guide may be subject to change without notice due to updates to the product's specifications.

Notes on the software

- Copyright laws prohibit the following actions without the permission of the copyright holder.
 - Reproducing the software or the manual in whole or in part.
 - Loaning out the software
- In no event will Sony be held liable for any of the following incidents that may arise out of the use of the supplied software.
 - Financial damage
 - Loss of profits
 - Claims made by third parties
- The supplied software cannot be used with devices for which it is not designated.
- Please note that the software specifications may be changed without notice for quality improvement.
- The explanations in this manual assume that you are familiar with the basic operations of a computer.
- For details on the use of computers and operating systems, refer to their respective manuals.

The contents of the Help Guide may be subject to change without notice due to updates to the product's specifications.

Digital Music Player
NW-WS623/WS625

Notes on the sample data

Sample music is pre-installed on the Walkman for trial listening.

Once you have deleted the sample data from the Walkman, you cannot restore it. We will not provide new sample data.

Sample data is not installed in some countries or regions.

4-688-892-12(1) Copyright 2017 Sony Corporation

Digital Music Player
NW-WS623/WS625

Notes while swimming in a pool or the ocean

- Do not use your Walkman in a crowded place or in circumstances which an inability to hear surrounding sounds would be dangerous.
- When you use your Walkman in public or private swimming facilities, follow the rules of that facility.
- The earbuds create a seal in your ear canal. Thus, there is a risk of damage to your ears or eardrums if strong pressure is applied to the earbuds, or the earbuds are removed suddenly from your ears. Due to this risk, do not do vigorous exercise, dive into a swimming pool, etc., while wearing your Walkman.
- Do not pour hot water directly on your Walkman and do not blow hot air from a hair dryer, etc., directly on the Walkman. Never use the Walkman in high-temperature locations such as in saunas or near a stove.
- Do not use or leave your Walkman in the following types of environment:
 - in high temperature locations with a temperature above 45 °C (113 °F) such as under the blazing sun, in a car, in warm water or other high temperature and high humidity locations
 - in a cold locations with a temperature below –5 °C (23 °F)
- If you cannot avoid using your Walkman in a location exposed to direct sunlight, cover your Walkman with a towel, etc.
- The sound volume is lower with Swimming earbuds than with standard-type earbuds. Increase the volume as needed.
- When you replace Swimming earbuds with the standard-type earbuds, the sound becomes louder. Adjust the volume so as not to hurt your eardrums.
- Your Walkman may detach and fall during vigorous exercise, etc.
- Your Walkman will sink if dropped in water.
- Radio waves do not transmit through water. You cannot perform the following operations via a Bluetooth connection underwater.
 - Listening to music on a smartphone.
 - Answering a call.
 - Using the Remote Commander (NW-WS625 only).

Notes on Ambient Sound Mode

- When the Swimming earbuds are attached, ambient sound cannot be heard as well as when Standard-type earbuds are attached.
- Ambient sounds cannot be heard well after using your Walkman in a pool or the ocean. Repeatedly pat the parts around the buttons of your Walkman softly against a dry cloth about 30 times. Then place your Walkman on a dry cloth at room temperature for 2 to 3 hours to ensure it is completely dry before the next use.

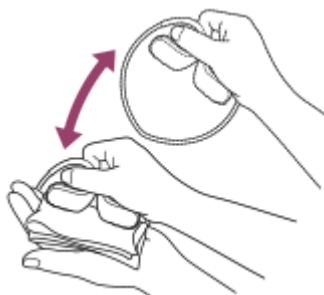

Related Topic

- [Water resistant and dust proofing performance of this Walkman](#)
- [Differences between the standard-type earbuds and Swimming Earbuds](#)

4-688-892-12(1) Copyright 2017 Sony Corporation

Notes on charging the battery after swimming

- Before you charge the battery, make sure that the Walkman is not wet.
- If the Walkman is wet, wipe the moisture off completely and dry the Walkman at room temperature. Before you charge the battery, make sure that there is no moisture on the Walkman.
- The USB cradle (supplied) is not water-resistant.
 - Do not touch the USB cradle with wet hands.
 - Do not use the USB cradle when the Walkman is wet.

The contents of the Help Guide may be subject to change without notice due to updates to the product's specifications.

Related Topic

- [Water resistant and dust proofing performance of this Walkman](#)
- [Differences between the standard-type earbuds and Swimming Earbuds](#)
- [Maintenance](#)
- [Notes on charging the battery](#)

Digital Music Player
NW-WS623/WS625

General Information

- Charging time and playback time depend on the following conditions.
 - The number of times you have charged the battery
 - Operating temperature
- When the battery is sufficiently charged but the battery life has dropped to about half of its normal span, the battery may be worn out.
- A lithium-ion rechargeable battery is built into the Walkman. When you store the Walkman for long periods of time, check the following to prevent the deterioration of the built-in battery.
 - Store the Walkman at temperatures from -5°C to $+45^{\circ}\text{C}$ (23°F to 113°F).
 - To prevent deterioration of the battery, charge the battery at least once every 6 months.



- You feel mild tingling against your ears particularly in dry air conditions.
This is a result of static electricity accumulated in the body.
This effect can be minimized by wearing clothes made from natural materials.
- Sony is not responsible for user data even if the following problems occur due to defects in the Walkman or a computer.
 - Recording or downloading of data is incomplete.
 - Data (such as music) is damaged or deleted.

The contents of the Help Guide may be subject to change without notice due to updates to the product's specifications.

Digital Music Player
NW-WS623/WS625

Maintenance

- Clean the Walkman with a soft cloth, such as a cleaning cloth for eyeglasses.
- To clean a Walkman that has gotten very dirty, use a cloth slightly moistened with a mild detergent solution.
- Do not clean with solvents such as alcohol, naphtha, or paint thinner. These solvents may damage the surface of the Walkman.

Care and cleaning after swimming in a pool or the ocean

Clean the earbuds and the Walkman after every use as follows.

- If salt and sand are left on the Walkman, the metal terminals may rust or foreign substances may build up. As a result, the Walkman may not charge properly, or a computer may not be able to recognize the Walkman.
 - Wash the Walkman in lukewarm water if tanning oil or sunscreen adheres to the Walkman. These substances may cause damage to the Walkman, such as discoloration or cracks.
 - Be careful not to get foreign substances (earwax, etc.) on the headphone sections. These substances may cause sound loss or deterioration of sound quality.
1. Remove salt and sand from the Walkman immediately after you use it in the ocean. Wash the Walkman with fresh water such as tap water.
 2. Fill a basin or bucket with fresh water. Gently shake the Walkman about 20 times. Then, soak the Walkman for about 30 minutes.



3. Remove the earbuds from the Walkman. Then, hand-wash the earbuds with a mild detergent solution. After you wash the earbuds, dry the earbuds well.

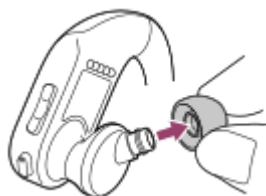

4. Rinse the terminals (1) and mesh sheet (2) of the Walkman with gentle running tap water.
If the terminals and mesh sheet are not clean, clean them with a soft brush (such as a toothbrush).



5. Remove any moisture from the terminals and surface of the Walkman with a soft, dry cloth.

6. Pat the headphones softly against a dry cloth. Repeat the patting about 20 times.

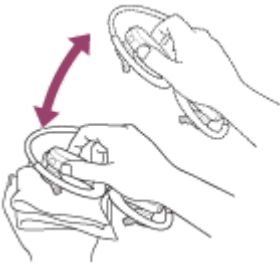

7. Pat the areas around the buttons of the Walkman softly against a dry cloth. Repeat the patting about 30 times.

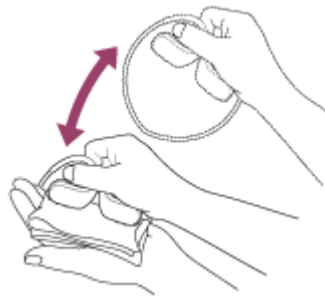

8. Place the Walkman on a dry cloth. Then, leave the Walkman at room temperature for 2 to 3 hours.

Note

- Do not apply strong force to the mesh sheet. Doing so may damage the mesh sheet.
- Do not rub foreign substances on the mesh sheet. Doing so may push the substances into the headphones.

The contents of the Help Guide may be subject to change without notice due to updates to the product's specifications.

Digital Music Player
NW-WS623/WS625

Customer support website

Visit the customer support website in your country or region in the following situations.

- When you have a question about the Walkman.
- When you have an issue with the Walkman.
- When you want information on compatible items.

For customers in the US:

<http://www.sony.com/walkmansupport>

For customers in Canada:

English

<http://www.sony.ca/ElectronicsSupport/>

French

<http://www.sony.ca/ElectronicsSupport/>

For customers in Latin America:

<http://www.sony-latin.com/index.crp>

For customers in Europe:

<http://www.sony.eu/dna/wm/>

For customers in Asia/Oceania/the Middle East/Africa:

English

<http://www.sony-asia.com/support>

Korean

<https://scs.sony.co.kr/scs/handler/ProductSupport>

Simplified Chinese

<https://service.sony.com.cn>

Traditional Chinese

<http://service.sony.com.tw/>

For customers who purchased the overseas models:

<http://www.sony.co.jp/overseas/support/>

The contents of the Help Guide may be subject to change without notice due to updates to the product's specifications.

4-688-892-12(1) Copyright 2017 Sony Corporation

Digital Music Player
NW-WS623/WS625

Specifications

Interface

USB	Hi-Speed USB (USB 2.0 compliant)
-----	----------------------------------

Bluetooth

Bluetooth Specifications

Communication system	Bluetooth Specification Version 4.0
Frequency band	2.4 GHz band (2.4000 GHz - 2.4835 GHz)
Modulation method	FHSS, Other
Compatible Bluetooth profiles (*1)	A2DP (Advanced Audio Distribution Profile) AVRCP (Audio Video Remote Control Profile) HFP/HSP (Hands Free Profile/Headset Profile)
Supported Codec (*2)	SBC (*3), AAC

*1 Bluetooth profiles are standardized according to the purpose of the Bluetooth device.

*2 Codec indicates the audio signal compression and conversion format.

*3 SBC stands for Subband Codec.

Microphone

Stereo

Output (headphones)

Frequency	Frequency response 20 Hz to 20,000 Hz (when playing data file, single signal measurement)
-----------	-------------------------------------------------------------------------------------------------

Sound Settings

Dynamic Normalizer (On/Off)

General

Power Source	Built-in Rechargeable lithium-ion Battery USB power (from a computer via a USB Cradle of the player)
Charging Time	USB-based charging Approx. 1.5 hours Quick charging

	Approx. 3 minutes charge enables up to approx. 60 minutes playback.
Operating temperature	-5 °C to +45 °C (23 °F to 113 °F)
Mass	Approx. 32 g (1.2 oz)
Water resistance/Dust proofing	IP65/IP68 (IEC 60529) or equivalent * * with Swimming Earbuds attached

Capacity

NW-WS623	4 GB
NW-WS625	16 GB

Actual available memory for other contents (*1)

NW-WS623	Approx. 3.22 GB= 3,466,067,968 bytes
NW-WS625	Approx. 14.1 GB= 15,191,244,800 bytes

*1 Available capacity may vary. A portion of the memory is used for data management functions.

Remote Commander (supplied for only NW-WS625)

Bluetooth

Bluetooth Specifications

Communication system	Bluetooth Specification Version 4.0
Frequency band	2.4 GHz band (2.4000 GHz - 2.4835 GHz)
Modulation method	Other

General

Power Source	CR1620 Lithium Coin Cell Battery (*1)
Operating temperature	-5 °C to +45 °C (23 °F to 113 °F)
Mass	Approx. 11 g (0.4 oz)
Water resistance/Dust proofing	IP65 (IEC 60529) or equivalent

*1 The battery supplied at the time of purchase may have a shorter battery life as it is installed at the factory to check the performance.

The contents of the Help Guide may be subject to change without notice due to updates to the product's specifications.



Digital Music Player
NW-WS623/WS625

Battery life

The values shown below are the approximate battery life when content is played continuously.

Battery life of the Walkman

Walkman mode (Approx.)

MP3 128 kbps	Ambient Sound Mode ON	8 hours
	Ambient Sound Mode OFF	12 hours
Linear PCM 1411 kbps	Ambient Sound Mode ON	7 hours
	Ambient Sound Mode OFF	10 hours

Headphone mode (Approx.)

Ambient Sound Mode ON	3.5 hours
Ambient Sound Mode OFF	4 hours

Note

- Even if the player is turned off for an extended period, a small amount of battery power is still consumed.
- Battery life may vary depending on volume setting, conditions of use and ambient temperature.
- The battery life may become 20% shorter when "Dynamic Normalizer" setting is active.
- The battery life for continuous playback via a Bluetooth connection may become 40 % to 70 % shorter depending on the content format or the settings of the connected device.
- The battery life may become about 20% shorter when the Walkman is paired with the Remote Commander. (This is a default setting for the NW-WS625.) Reset the Walkman to the factory settings to extend the battery life as described in this topic. When you use the Remote Commander, you will need to pair the Walkman and the Remote Commander again. Refer to the [Help Guide] for details.

Battery life of the Remote Commander (supplied for only NW-WS625)

Approx. 18 months (2 hours usage every day) (*1)

*1 The battery life may differ depending on ambient temperature or the status of use. The value is for reference only.

The contents of the Help Guide may be subject to change without notice due to updates to the product's specifications.

Digital Music Player
NW-WS623/WS625

Maximum recordable number of songs

The approximate times are based on the case in which you transfer or record only 4 minute songs.

Number (Approx.)

	NW-WS623	NW-WS625
MP3 128 kbps	880 songs	3,850 songs
Linear PCM 1411 kbps	75 songs	350 songs

The contents of the Help Guide may be subject to change without notice due to updates to the product's specifications.

Digital Music Player
NW-WS623/WS625

Supported formats

Music (*1, *2, *3)

Audio Formats

MP3

Media File format: MP3 (MPEG-1 Layer3) file format

File extension: .mp3

Bit rate: 32 kbps to 320 kbps (Supports variable bit rate (VBR))

Sampling frequency: 32, 44.1, 48 kHz

WMA

Media File format: ASF file format

File extension: .wma

Bit rate: 32 kbps to 192 kbps (Supports variable bit rate (VBR))

Sampling frequency: 44.1 kHz

FLAC

Media File format: FLAC file format

File extension: .flac

Bit depth: 16 bit

Sampling frequency: 8, 11.025, 12, 16, 22.05, 24, 32, 44.1, 48 kHz

Linear PCM

Media File format: Wave-Riff file format

File extension: .wav

Bit rate: 1411 kbps

Sampling frequency: 44.1 kHz

AAC

Media File format: MP4 file format

File extension: .mp4, .m4a, .3gp

Bit rate: 16 kbps to 320 kbps (Supports variable bit rate (VBR))

Sampling frequency: 8, 11.025, 12, 16, 22.05, 24, 32, 44.1, 48 kHz

*1 Sampling frequency may not correspond to all encoders.

*2 Copyright protected files cannot be played back.

*3 Non-standard bit rates or non-guaranteed bit rates are included depending on the Sampling frequency.

The contents of the Help Guide may be subject to change without notice due to updates to the product's specifications.

Digital Music Player
NW-WS623/WS625

System requirements

Computer

- Windows® 10
- Windows® 8.1
- Windows® 7
- macOS™ v10.8 - 10.12

Internet

Internet connection

We do not guarantee operation for all computers.

The contents of the Help Guide may be subject to change without notice due to updates to the product's specifications.

Digital Music Player
NW-WS623/WS625

The Walkman does not function. You cannot turn on the Walkman.

- If the Walkman is connected to a computer, disconnect the Walkman from the computer.
- Restart the Walkman.
- If the problem persists, charge the battery for 30 minutes or longer using the USB cradle (supplied).

Note:

Once the operation lamp lights up during charging, you can use the Walkman. Even if the Walkman is connected to a computer, the operation lamp may not light up when the battery level is low.

The contents of the Help Guide may be subject to change without notice due to updates to the product's specifications.

Digital Music Player
NW-WS623/WS625

You cannot charge the battery.

- If the terminals of the Walkman are dirty, the following problems may occur:
 - The battery cannot be charged.
 - A computer cannot recognize the Walkman.
- Connect and disconnect the Walkman from the USB cradle several times. If the problem persists, do the following:
 - Clean the terminals of the Walkman with a wet and soft-bristled toothbrush, etc.
 - After you clean the Walkman, remove any moisture from the terminals of the Walkman with a soft, dry cloth. Dry the Walkman completely before use.
- If the remaining battery is too low, the operation lamp may not light up even if you connect the Walkman to a computer. In such a case, connect the Walkman to the computer for 30 minutes or longer until the operation lamp lights up.

The contents of the Help Guide may be subject to change without notice due to updates to the product's specifications.

Digital Music Player
NW-WS623/WS625

The built-in rechargeable battery becomes depleted quickly even after the Walkman is fully charged.

If the battery life becomes half as short as normal, consider replacing the battery.

The battery life depends on the conditions of use, settings, and ambient temperature.

Furthermore, the following operations will deplete the battery more quickly than continuous use of the Walkman.

- Turning the Walkman on or off frequently.
- Changing the Walkman settings frequently.
- Charging and discharging the battery repeatedly.

This will gradually decrease the capacity of the battery. As a result, the battery may become depleted quickly even after it is fully charged.

To replace the battery, contact the nearest Sony dealer or Sony Service Center.

The battery can be charged approximately 500 times on average.

However, the battery lifespan depends on the temperature and usage environment.

When the life of a fully charged battery becomes half as short as normal, consider replacing the battery.

To replace the battery, contact the nearest Sony dealer or Sony Service Center.

Do not replace the battery yourself. The battery is built into the Walkman. Battery replacement requires professional knowledge and skills.

The contents of the Help Guide may be subject to change without notice due to updates to the product's specifications.

Digital Music Player
NW-WS623/WS625

The computer does not recognize the connected Walkman.

Try the following:

1. Confirm the connection between the Walkman and the USB cable (USB cradle).

Make sure that the Walkman and the computer are connected correctly using the USB cable (USB cradle) (supplied). If the terminals of the Walkman are dirty, you may not be able to charge the battery or the computer may not recognize the Walkman.

Connect and disconnect the Walkman and the USB cradle several times. If the problem persists, remove the dirt from the terminals of the Walkman using a wet and soft-bristled toothbrush, etc.

Also, be sure to use the USB cable (USB cradle) (supplied) to connect the Walkman to the computer.

2. Restart the computer.

Disconnect the Walkman from the computer, and then restart the computer.

3. Restart the Walkman.

Hold down the button (1) for 10 seconds until the Walkman restarts.

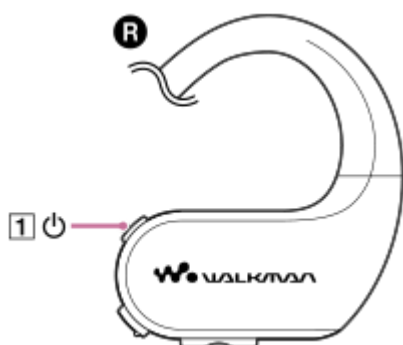

4. Connect the Walkman to another USB port on the computer.

Connect the Walkman to another USB port if the computer has multiple USB ports. Then, check if the computer now recognizes the Walkman.

If devices other than the Walkman are connected to the computer via USB, disconnect the other devices.

Connect only the Walkman to the computer and check if the Walkman and the computer function correctly.

If you are using one of the following devices, remove the device from the computer. Then, connect the Walkman directly to a USB port on the computer.

- A USB hub without an AC adaptor
- A USB interface card

5. Reinstall the device driver.

If the device driver on the computer does not function correctly, the computer may not recognize the Walkman.

6. Deactivate background programs, and then connect the Walkman to the computer.

If there are active background programs on the computer (such as antivirus software), the computer may not recognize the Walkman.

Terminate the background programs before you connect the Walkman to the computer.

For details on how to terminate background programs, refer to the following.

- Check the help information for each program.
- Contact the manufacturer of the program.
- Contact the manufacturer of the computer.

The contents of the Help Guide may be subject to change without notice due to updates to the product's specifications.

4-688-892-12(1) Copyright 2017 Sony Corporation

Digital Music Player
NW-WS623/WS625

Sound becomes muffled (low volume). There is no sound.

If a foreign substance (such as earwax) adheres to the headphones, the following problems may occur.

- The sound is not clear.
- The volume is low.

Clean the mesh sheet using a toothbrush, etc.

1. Remove the earbuds.

2. **Rinse the terminals and the mesh sheet of the Walkman with gentle running tap water. Scrape out any substance on the mesh sheet laterally with a soft-bristled toothbrush.**
Do not apply strong force to the mesh sheet. Doing so may damage the mesh sheet.



1: Terminals

2: Mesh sheet

3. **After you remove the substance, remove any moisture from the surface of the Walkman with a soft, dry cloth.**
4. **Pat the headphones softly against a dry cloth. Repeat the patting about 20 times.**
Place the Walkman on a dry cloth. Then, leave the Walkman at room temperature for 2 to 3 hours.
5. **Attach the earbuds securely.**
Check if the sound is normal.

Hint

- If the volume is low only when you are using the Remote Commander (NW-WS625 only), make sure that the Remote Commander is dry.
- If the Remote Commander is wet, wipe the Remote Commander thoroughly with a dry cloth before use.

Digital Music Player
NW-WS623/WS625

The Walkman does not play tracks in the desired order.

If you transfer tracks from a computer to the Walkman by dragging and dropping the tracks, the track order may be different from the album order.

In this case, try the following procedure:

- 1. Connect the Walkman to a computer.**
- 2. On the computer, open [Computer] – [WALKMAN].**
On a Mac computer, open [WALKMAN] from the desktop.
- 3. Open [MUSIC] in [WALKMAN].**
- 4. Add a number to the beginning of the folder name or the file name (track name).**
For example: [001_album name] or [002_song name], etc.
- 5. Disconnect the Walkman from the computer.**
The Walkman will play the tracks in numerical order.

Hint

- After the Walkman recognizes the names of folders and files, the Walkman plays the tracks in the following order.
 - Single-byte numbers
 - Single-byte alphabetical characters
 - Two-byte Hiragana
 - Two-byte Katakana
 - Chinese characters (Kanji)
 - Two-byte numbers
 - Two-byte alphabetical characters
 - Single-byte Katakana

The contents of the Help Guide may be subject to change without notice due to updates to the product's specifications.

Digital Music Player
NW-WS623/WS625

The same track or album is played repeatedly. Tracks are played in random order.

Set the playback mode to Normal.

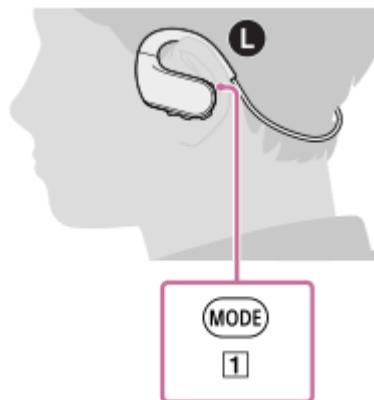

Each time you press the button (**1**), you will hear the voice guidance and the playback mode will change in the following order.

[Normal Play] – [Repeat Play] – [Shuffle Play] – [Shuffle All] – [Normal Play]...

To switch to the next playback mode, wait until the voice guidance ends.

The contents of the Help Guide may be subject to change without notice due to updates to the product's specifications.

Digital Music Player
NW-WS623/WS625

How to maintain and clean the Walkman after sports (swimming or running, etc.)

If sweat, pool water, sand, or mud adheres to the Walkman, perform the following:

- Rinse the terminals of the Walkman and the headphones with gentle running tap water.
- Dry the Walkman thoroughly.

If the terminals are dirty, the electrical contacts may not function. Also, if a foreign substance (such as earwax) adheres to the headphones, the sound may not be clear or the volume may be low.

Rinse the Walkman with water, drain the water from the Walkman, and dry the Walkman as follows:

- 1. Remove salt and sand from the Walkman immediately after you use it. Wash the Walkman with fresh water such as tap water.**
- 2. Fill a basin or bucket with fresh water. Gently shake the Walkman about 20 times. Then, soak the Walkman for about 30 minutes.**

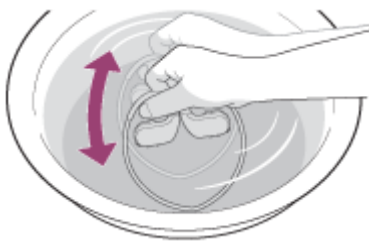

- 3. Remove the earbuds from the Walkman. Then, hand-wash the earbuds with a mild detergent solution. After you wash the earbuds, dry the earbuds well.**
- 4. Rinse the terminals and mesh sheet of the Walkman with gentle running tap water.**
If the terminals (1) and mesh sheet (2) are not clean, clean them with a soft brush (such as a toothbrush).



- 5. Remove any moisture from the terminals and surface of the Walkman with a soft, dry cloth.**
- 6. Pat the headphones softly against a dry cloth. Repeat the patting about 20 times.**

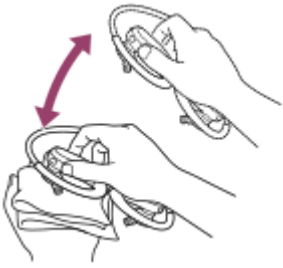

7. Pat the areas around the buttons of the Walkman softly against a dry cloth. Repeat the patting about 30 times.

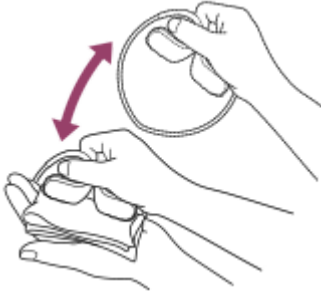

8. Place the Walkman on a dry cloth. Then, leave the Walkman at room temperature for 2 to 3 hours.

Note

- Do not apply strong force to the mesh sheet. Doing so may damage the mesh sheet.
- Do not rub foreign substances on the mesh sheet. Doing so may push the substances into the headphones.

The contents of the Help Guide may be subject to change without notice due to updates to the product's specifications.