

HWgw 1803

Fully Integrated Wine Cabinet



LIEBHERR

Quality, Design and Innovation

The innovative and superbly designed **HWgw 1803** wine cabinet is designed for today's modern kitchen. Featuring high performance technology alongside easy-to-use features, the HWgw 1803 proves that it's possible to save energy without compromising convenience and design. Employing state-of-the-art climate technology with heating and cooling circuits, alongside FreshAir activated filtration, the HWgw 1803 ensures the very best conditions for wines to quietly mature and develop their full flavor. Precision electronics, specialized compressors, and a variety of additional innovative features, make the HWgw 1803 the ideal model for optimally storing wine.

The **HWgw 1803** includes TipOpen technology – the perfect solution for hands-free kitchen designs. When the glass door is gently tapped, TipOpen technology partially opens the cabinet, facilitating further opening. If the door is not fully opened within three seconds, the door will self-close, ensuring that ideal air humidity is maintained within cabinet. When fully opened, the door opens downward like an oven.

The easy-glide accessory drawer can be used to store wine accessories directly below the **HWgw 1803**. The accessory drawer is available in black glass, or stainless steel, to match the HWgw 1803 and your custom cabinetry.



Fully Integrated Wine Cabinet	
Energy consumption (kWh/y)	296
Estimated Yearly Energy Cost in US \$*	–
Sound rating dB(A)**	36
Total capacity cu.ft. (l)	1.6 (46)
Max. No. of Bordeaux bottles (0.75 l)	18
Number of shelves	3
Shelves on telescopic rails	2
Shelf material	Beech wood shelves
Electronic control	LCD temp. display, touch electronic
Temperature range °F (°C)	+41°F to +68°F (+5°C to +20°C)
Temperature zones	1
Interior light	LED lighting permanently on, dimmable
Door alarm	acoustic
Safety thermostat	yes
Activated Charcoal filter	yes
Door type	white insulated glass door, handle and frame free
SoftSystem	yes
Product dimensions (H/W/D) in. (cm)	17 11/16" / 21 7/8" / 22 1/16" (44.8/55.5/55.9)
Cut out dimensions (H/W/D) in. (cm)	17 3/4"-22 1/16" / 21 11/16" / 21 11/16" (45-56/55/55)
Net weight lbs. (kg)	75.0 (34.0)
Voltage V/Hz	115/60

HWgw 1803 GrandCru	LED	Wine	Tip Open	Soft System	Telescopic Rails	ADA Compliant
296						
–						
36						
1.6 (46)						
18						
3						
2						
Beech wood shelves						
LCD temp. display, touch electronic						
+41°F to +68°F (+5°C to +20°C)						
1						
LED lighting permanently on, dimmable						
acoustic						
yes						
yes						
white insulated glass door, handle and frame free						
yes						
17 11/16" / 21 7/8" / 22 1/16" (44.8/55.5/55.9)						
17 3/4"-22 1/16" / 21 11/16" / 21 11/16" (45-56/55/55)						
75.0 (34.0)						
115/60						

* Estimated energy cost will depend on utility rates and use. Estimated energy cost based on a national average electricity cost of 12 cents per KWh.
** Noise output – according to EN 60704-3.



German Engineering: Our superior products offer premium quality, cutting edge design, and innovative features that best fit your lifestyle. The use of high quality materials, perfectly detailed finishes, and elite cooling components are combined with the latest production processes, resulting in an outstanding cooling product.



SoftSystem: Liebherr's SoftSystem technology gently cushions the automatic door closing, preventing vibrations which can affect the quality of your finest wines.



Precision electronics: The precise electronic control allows temperatures to be set to the exact desired degree, from 41°F to 68°F.



LED Lighting: All Liebherr wine cabinets are equipped with innovative LED lighting, which emit minimal heat and no UV radiation, ideal for the optimal storage of wines.



Beech Wood Shelving: Liebherr wine cabinets are fitted with beech wood shelving, mounted on telescopic rails for easy and gentle access to wines. The handmade, untreated wood pullout shelves can hold a variety of bottle types.

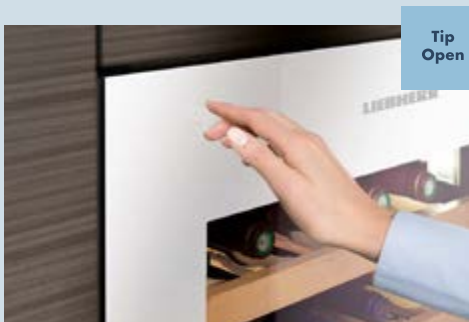

TipOpen technology: When the door is gently tapped, TipOpen technology partially opens the appliance, facilitating further opening. If the door is not opened fully within three seconds, the door will self-close, ensuring that ideal air humidity is maintained within the cabinet.



UV Protection: In order to minimize the exposure of light which can damage the maturity of a wine, Liebherr wine cabinets are fitted with special UV-resistant insulated glass, simultaneously protecting and presenting your finest wines.



Alarm: Liebherr wine cabinets are equipped with a trustworthy alarm system which alerts the owner if the door has been left open, or if there are temperature changes.

Appliance Dimensions

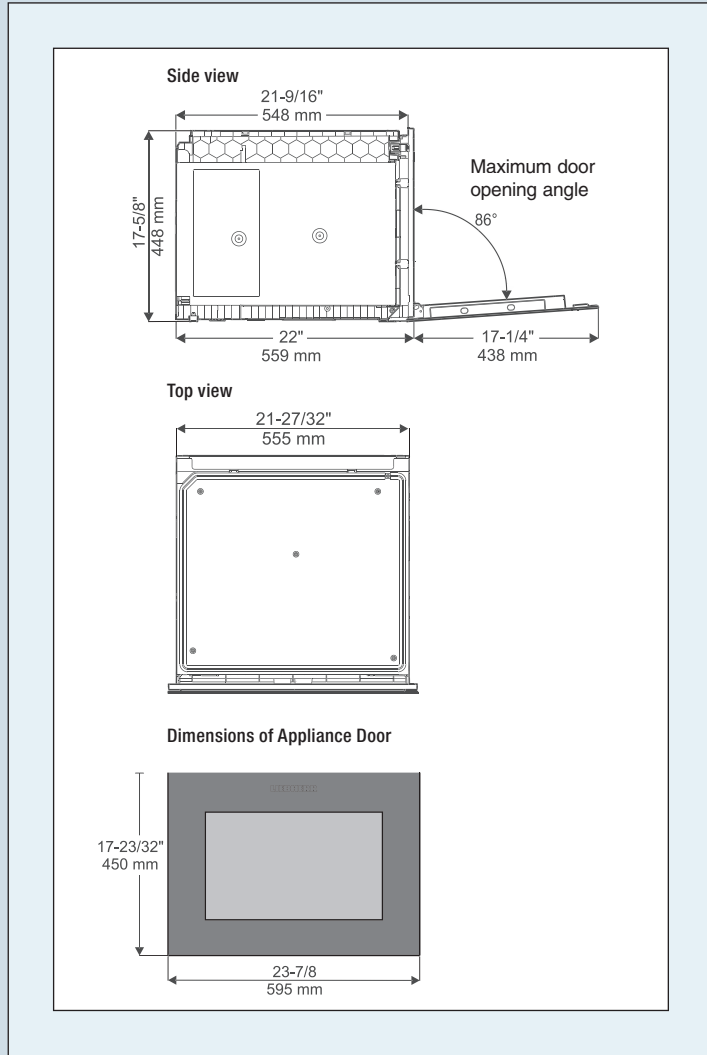

Ventilation

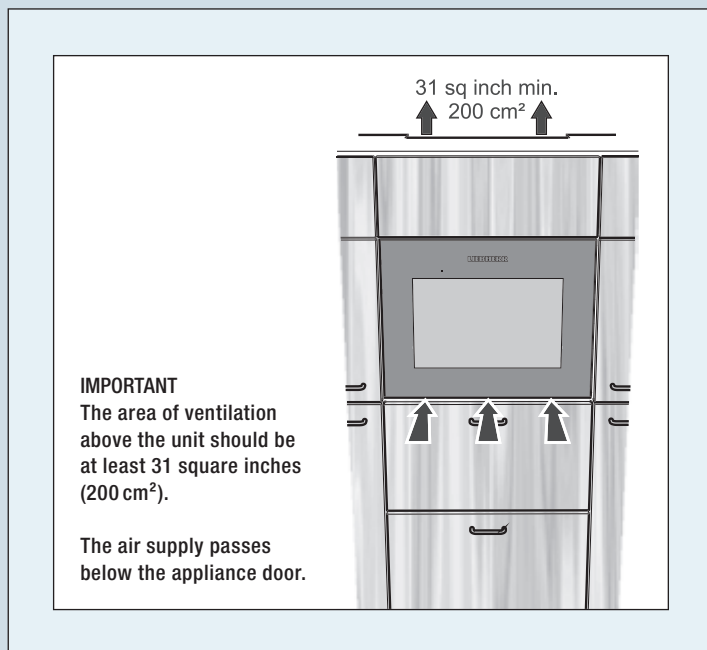

Cabinet Dimensions

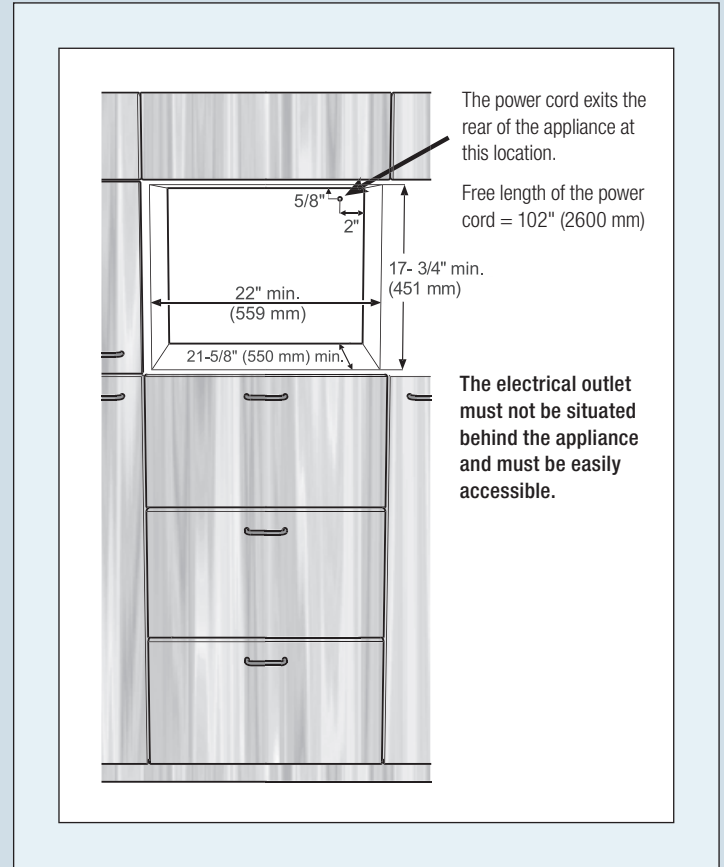

Ventilation

