

Diagrams

◀30"▶

Unit Dimensions

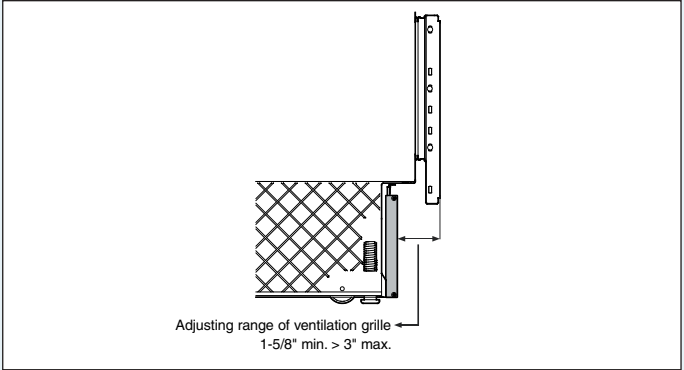
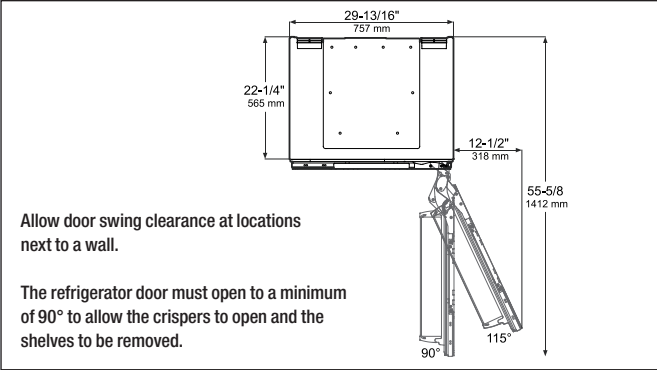
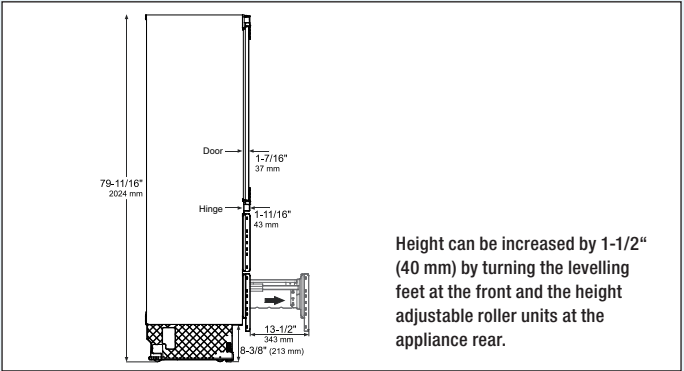
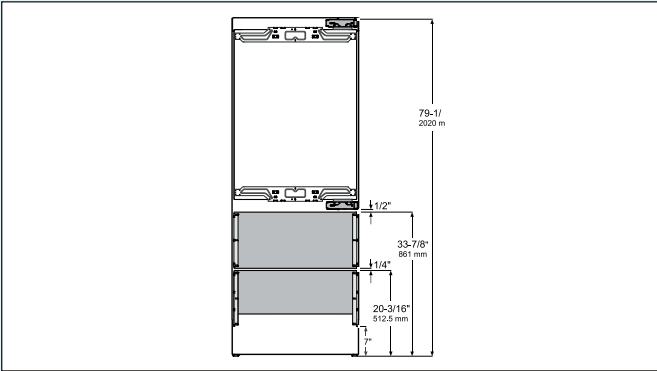

Panel Dimensions

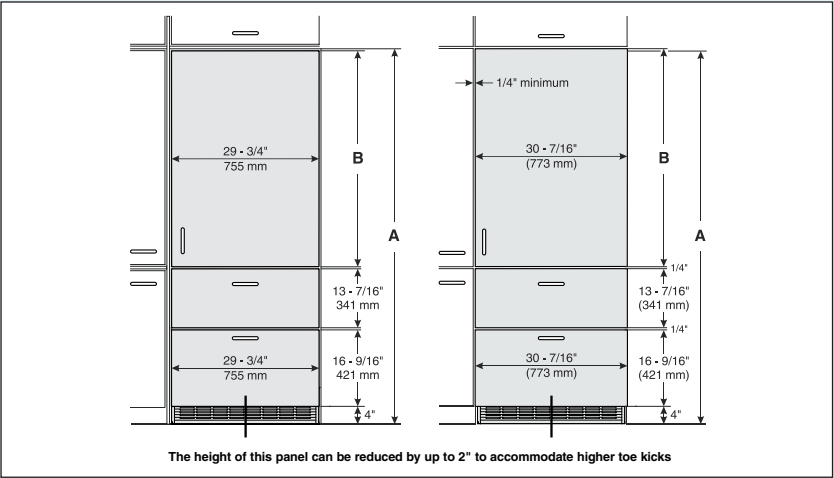

Minimum panel thickness is 5/8" (16 mm).

Maximum panel thickness is 1-1/2" (38 mm).

Maximum weight of the refrigerator panel is 60 lbs (27 kg).

Maximum weight of each freezer panel is 26.5 lbs (12 kg).

Cabinet opening A	Cabinet opening B
80"	45-1/4" (1150 mm)
84"	49-1/4" (1251 mm)"

Minimum panel thickness is 5/8" (16 mm).

Maximum panel thickness is 1-1/2" (38 mm).

Maximum weight of the refrigerator panel is 60 lbs (27 kg).

Maximum weight of each freezer panel is 26.5 lbs (12 kg).

Cabinet opening C	Cabinet opening D
80"	45-3/4" (1162 mm)
84"	49-3/4" (1264 mm)"

Cabinet Opening Dimensions

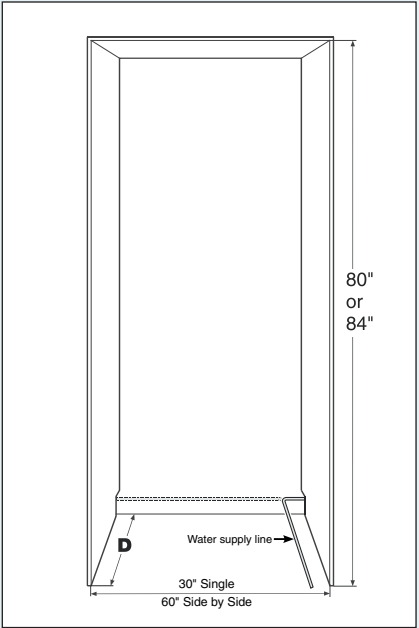

Inset cabinet Depth D	Inset cabinet Depth D
24" + panel thickness	24"

IMPORTANT
Factory available stainless steel panels are designed for an inset installation only and require a cabinet / gable depth of 24 - 3/4".



Liebherr HC 1540
Fully Integrated/Seamless



Fully Integrated/Seamless

The **HC 1540** model is perfect for a seamless design because it is cleverly concealed behind cabinet doors. With a fully integrated door-on-door system that incorporates strong hinges for a convenient closing of doors even when fully loaded. Double freezer drawers mounted on smooth telescopic rails offer more than 4 cubic feet of storage space and the drawer system offers convenient handling and viewing of food stored. A water connection is not needed for the IceMaker thanks to a well appointed 1.5 liter internal water tank that is conveniently removable for filtered water to produce ample pure crescent ice.



Fully Integrated/Seamless

Energy consumption
in 365 days kWh
Estimated Yearly Energy Cost in US \$
Capacity
Total capacity cu.ft. (l)
Refrigerator comp. cu.ft. (l)
NoFrost Freezer comp. cu.ft. (l)
Shipping weight lbs. (kg)
Climate rating
Sound rating dB(A)
Ice cube output lbs. (kg) / 24h
Ice cube stock lbs. (kg)
Door hinges
Product dimensions
in inches (cm) H/W/D
Cut out dimensions
in inches (cm) H /W/D
Energy supply
Voltage V/Hz

HC 1540
Premium



507
61*
14.1 (400)
9.8 (278)
4.3 (122)
352.7 (160)
SN-T
42
3.1 (1.4)
7.9 (3.6)
right
79 13/16" / 29 13/16" / 24 1/16" (202.7 / 75.7 / 61)
80" / 30" / min 24 1/16" (203.2 / 76.2 / min 61)
115/60

* Your Energy Cost will depend on your utility rates and use. Estimated energy cost based on a national average electricity cost of 12 cents per KWh
** Noise level – sound power re 1pW – according to EN 60704-3

Advantages



German Engineering: Our superior products offer premium quality, cutting edge design and innovative features that fit with your busy lifestyle. Plus, exclusive components and materials along with the latest production processes ensure energy efficiency and performance for years to come.

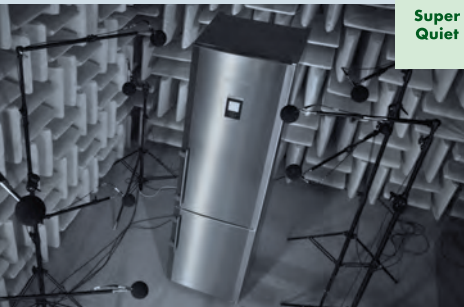

SuperQuiet: Noise is kept to a minimum with virtually silent, speed controlled compressors and a low nose cooling circuit; while also ensuring exact performance, energy efficiency and SuperQuiet operation.



LED: Distinctive LED light columns are integrated into both sides of the compartment liner. Inside the columns are numerous cool LED lights that ensure uniform lighting throughout the interior.



DuoCooling: The dual refrigeration system creates optimal conditions in both the refrigerator and freezer which lengthens the shelf life of food items for a healthier lifestyle. This technology also preserves the flavor and texture of foods since there is no transfer of unwanted air, moisture or food aroma between the two compartments.



Energy Star: Liebherr refrigerators help to produce less energy waste and greenhouse gas emissions with the aim to have the least damaging effect on the environment and offering solutions that help consumers conserve energy.



Electronic Display: Our intuitive electronic touch control panel ensures all functions are easy and convenient to use as well as guarantees that the settings selected remain accurate and constant.



SuperCool/SuperFrost: Simply quick chill and or freeze fresh groceries to preserve optimum freshness and seal in flavors, textures as well as maintain essential vitamins and minerals.



GlassLine: The elegant yet tough GlassLine shelves are scratch resistant and easy to clean as well as dishwasher safe. The space-saving shelves are designed for organization and are completely adjustable to suit your needs and the contents of the refrigerator; additionally the lighting shines through for a brighter interior.



Door-on-door technology: Allows custom panels to be affixed directly onto the appliance so that the hinges are concealed, plus the cabinet and the fridge open as one, ensuring a wide range of design options and easy installation.